

USDA-FOREST SERVICE

Index File No. C-3

CORNER RECORD (SEARCH)

(Ref. FSM 7151.4)

Tract or Survey No. \_\_\_\_\_

Cor. No. \_\_\_\_\_

T 75 R. 33E

R.D. NORTH FORK JOHN DAY County GRANT

Merid. WILLAMETTE

N.F. UMATILLA State OREGON

CORNER DIAGRAM

T75 R33E

DESCRIBE CORNER MONUMENT FOUND

BRASS CAPPED IRON PIPE - CAP IS MARKED AS IN DIAGRAM.



C1/4 ● 56

1978

PLS 933

DESCRIBE BEARING TREES OR OTHER OFFICIAL ACCESSORIES FOUND

4 BT'S OF RECORD ARE O.K.

PHOTO IDENTIFICATION DATA

Photo No. \_\_\_\_\_

Filed At. \_\_\_\_\_

Object Ident. \_\_\_\_\_

Ident. By \_\_\_\_\_

Signature

6

DESCRIBE CORNER LOCATION RELATIVE TO NEAR-BY FEATURES, ALSO HOW TO REACH CORNER

PLANE COORDINATE POSITION DATA

State \_\_\_\_\_ Zone \_\_\_\_\_

X \_\_\_\_\_

Y \_\_\_\_\_

Estab. By \_\_\_\_\_

Agency

8

Signature

Title

Division

Headquarters

Date

FS-7100-52 (3/68)

4

Dennis L. Layford PLS 1636 MARCH 1997

5

**CORNER RECORD (PERPETUATION)**

**MONUMENT: DESCRIBE NEW MONUMENT SET, OR WORK DONE TO PRESERVE EXISTING MONUMENT**

**ACCESSORIES: DESCRIBE NEW BT'S WITNESS OBJECTS ETC. ESTABLISHED, OR WORK DONE TO PRESERVE EXISTING EVIDENCE**

Work Done By \_\_\_\_\_ Title \_\_\_\_\_ Date \_\_\_\_\_ State Registration No. or Agency \_\_\_\_\_  
Certified Cor. Record Prepared? Yes No Filed At: \_\_\_\_\_ Date \_\_\_\_\_

**REMARKS**

Index File No. T. R. M. Tract or Surv. No. Cor.

USDA-FOREST SERVICE

INDEX

FILE NO. C-3 CORNER RECORD (SEARCH) (Ref. FSN 7151.4) Tract or Cor. No. \_\_\_\_\_  
 T. 7 S R. 33 E R.D. North Fork John Day County Grant Survey No. \_\_\_\_\_  
 Merid. Willamette N.F. UMATILLA State Oregon \_\_\_\_\_ 1

CORNER DIAGRAM

1 DESCRIBE CORNER MONUMENT FOUND  
 1 T75 R33E 1 A 2 1/2" iron pipe with brass cap stamped as shown in the diagram.  
 1 1  
 N C1/4--S6 1 2  
 1 1978 1  
 1 PLS 933 1 DESCRIBE BEARING TREES OR OTHER OFFICIAL ACCESSORIES FOUND

1 A 12" dbh Ponderosa Pine bears N31 3/4'E, 49.2' with healed blaze.  
 PHOTO IDENTIFICATION DATA 1 A 14" dbh Ponderosa Pine bears S68°W, 46.0' with healed blaze.  
 Photo No. \_\_\_\_\_ 1 A 14" dbh Ponderosa Pine bears S32 1/2°W, 22.5' with visible scribe.  
 Filed at. \_\_\_\_\_ 1  
 Object Ident. \_\_\_\_\_ 1  
 Ident. By \_\_\_\_\_ 1  
 Signature \_\_\_\_\_ 1 3

PLANE COORDINATE POSITION DATA 1 DESCRIBE CORNER LOCATION RELATIVE TO NEAR-BY FEATURES, ALSO HOW TO REACH CORNER  
 State \_\_\_\_\_ Zone \_\_\_\_\_ 1 From Highway 395, follow FSR 55 7 miles to FSR 5507. Then follow FSR 5507 5.0 miles  
 X \_\_\_\_\_ 1 to a Forest Boundary sign and section line tag. Follow the posted line west 2200' to  
 Y \_\_\_\_\_ 1 the corner.  
 Estab. By \_\_\_\_\_ 1  
 Agency \_\_\_\_\_ 1 4

Signature David L. Haddock Title Surveyor Division \_\_\_\_\_ Headquarters Pendleton, OR Date 6-02-94 FS-7100-52 (3/68) 5

CORNER RECORD (PERPETUATION)

MONUMENT : DESCRIBE NEW MONUMENT SET, OR WORK DONE TO PRESERVE EXISTING MONUMENT  
Cleared brush and debris away from corner.

9

ACCESSORIES : DESCRIBE NEW BT's WITNESS OBJECTS ETC. ESTABLISHED, OR WORK DONE TO PRESERVE EXISTING EVIDENCE  
Set new bearing tree.  
A 13" dbh Douglas Fir bears N53°W, 34.8' scribed C1/4 S6 BT.

An aluminum washer stamped RLS 852 is nailed between the letters B and T on each new tree. BT and LSM signs are attached to each bearing tree and 6" red bands painted around them.

10

Work Done By David L. Haddock Title Land Surveyor Date 5-25-94 State Registration No. \_\_\_\_\_  
Certified Cor. Record Prepared?  Yes  No or Agency PLS 852  
Filed At: Grant County Surveyor Date 6-94 11

REMARKS

12

Index File No. C-3 T. 7 S. R. 33 E. M. Willanette Tract or Surv. No. \_\_\_\_\_ Cor. \_\_\_\_\_

13

USDA-FOREST SERVICE

Index File No. C-3  
 T 7 S. R. 33 E.  
 Merid. WILLAMETTE

CORNER RECORD (SEARCH)

(Ref. FSM 7151.4)

R.D. NORTH FORK JORDY DAY County GRANT  
 N.F. UMATILLA State OREGON

Tract or Survey No. \_\_\_\_\_ Cor. No. \_\_\_\_\_

CORNER DIAGRAM

T. 7 S.  
 R. 33 E.



C 1/4 S 6  
 1978  
 PLS 933

DESCRIBE CORNER MONUMENT FOUND

BRASS CAP SET ON IRON POST MARKED. C 1/4 S 6 PLS 933 1978

DESCRIBE BEARING TREES OR OTHER OFFICIAL ACCESSORIES FOUND

A PINE, 14" DIAM., BEARS S 66° 10' W, 46.0 FT (RECORD S 67° 19' W, 45.96 FT) HEALED BLAZE,  
A PINE, 12" DIAM., BEARS N 28° 11' E, 49.25 (RECORD N 29° 51' E, 49.85) HEALED BLAZE  
STEEL GUARDPOST 5 FT. SOUTH OF MONUMENT WITH USFS 54-9 SIGN

PHOTO IDENTIFICATION DATA

Photo No. \_\_\_\_\_  
 Filed At. \_\_\_\_\_  
 Object Ident. \_\_\_\_\_  
 Ident. By \_\_\_\_\_  
 Signature \_\_\_\_\_

PLANE COORDINATE POSITION DATA

State \_\_\_\_\_ Zone \_\_\_\_\_  
 X \_\_\_\_\_  
 Y \_\_\_\_\_  
 Etab. By \_\_\_\_\_  
 Agency \_\_\_\_\_

DESCRIBE CORNER LOCATION RELATIVE TO NEAR-BY FEATURES, ALSO HOW TO REACH CORNER

CORNER LOCATED AT WEST EDGE OF CLEARING, ON GENTLY SLOPING HILLTOP. FOREST SERVICE LOCATION POSTER ON 4" X 4" WOOD POST, N. SIDE OF NF COLLECTOR ROAD 5507, 470 FT. WEST OF E 1/4 COR. 6 1/5.  
FROM SIGN, FOLLOW POSTED LINE 2150 FT WEST TO C 1/4 CORNER.  
OR FOLLOW NF LOCAL 030 OFF NF COLLECTOR 5507 TO LOCATION POSTER FOLLOW POSTED LINE WEST 700 FT. TO CORNER MONUMENT.

Signature

Ken Burt

Title

PHY. CHIEF

Division

Headquarters

Date

10/90

FS-7100-52 (3/68)

CORNER RECORD (PERPETUATION)

MONUMENT: DESCRIBE NEW MONUMENT SET, OR WORK DONE TO PRESERVE EXISTING MONUMENT

CLEAR BRUSH AND DETROIS FROM AROUND CORNER

ACCESSORIES : DESCRIBE NEW BT'S WITNESS OBJECTS ETC. ESTABLISHED, OR WORK DONE TO PRESERVE EXISTING EVIDENCE

NEW BEARING TREE, A PINE, 14" DIAM., BEARS S 31° 55' W, 22.5 FT., SCRIBETS C 1/4 S 6 BT, BRASS WASHER #1341, USFS SIGNS 54-3 AND 54-9 ATTACHED, 6" RED BAND PAINTED AROUND TREE. ATTACH USFS 54-9 SIGNS TO AND PAINT 6" RED BAND AROUND EXISTING BT'S RE ATTACH 54-9 SIGN TO guard post located 5' South of CORNER

Work Done By Guy Streamer Title LAND SURVEYOR Date 10/90 State Registration No. or Agency 1341-STREAMER

Certified Cor. Record Prepared?  Yes  No Filed At: GRANT COUNTY SURVEYOR Date 2/91

REMARKS

WITNESS: KEN BATES  
SEB KRIKA

Index File No. C3 T. 7S R. 33E M. WM Tract or Surv. No. Cor. 13

USDA-FOREST SERVICE

Index  
File No. C-3

CORNER RECORD (SEARCH)

(Ref. FSM 7151.4)

Tract or  
Survey No. \_\_\_\_\_ No. G-3

T 7 South R. 33 East R.D. Ukiah County Grant

Merid. Willamette N.F. Umatilla State Oregon

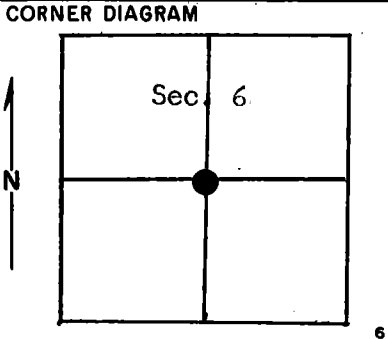

DESCRIBE CORNER MONUMENT FOUND

None

DESCRIBE BEARING TREES OR OTHER OFFICIAL ACCESSORIES FOUND

None

PHOTO IDENTIFICATION DATA

Photo No. \_\_\_\_\_

Filed At. \_\_\_\_\_

Object Ident. \_\_\_\_\_

Ident. By \_\_\_\_\_

*Signature*

DESCRIBE CORNER LOCATION RELATIVE TO NEAR-BY FEATURES, ALSO HOW TO REACH CORNER

From Texas Bar, take road up North Fork of John Day River about 4 miles and corner is 1100 feet North of road on the North slope of the river.

PLANE COORDINATE POSITION DATA

State \_\_\_\_\_ Zone \_\_\_\_\_

X \_\_\_\_\_

Y \_\_\_\_\_

Estab. By \_\_\_\_\_

*Agency*

Signature Peteh Loren Murphy Title Party Chief Division \_\_\_\_\_ Headquarters Krumbein Engineering Date 14 SEP 78

7100-52-(3/68)

## CORNER RECORD (PERPETUATION)

GPO 902-673

MONUMENT : DESCRIBE NEW MONUMENT SET, OR WORK DONE TO PRESERVE EXISTING MONUMENT

Set 2½" x 30" iron pipe with brass cap (stamped)  
 Pipe is 26 inches in ground.

T 7S R 33E  
 C ¼ S 6  
 1978  
 PLS 933

ACCESSORIES : DESCRIBE NEW BT's WITNESS OBJECTS ETC. ESTABLISHED, OR WORK DONE TO PRESERVE EXISTING EVIDENCE

Scribed BTs

Pine 11" diam. brs. N 29°51' E 49.25 ft. with signs 54-3 and 54-4 and brass washer.  
 Pine 12" diam. brs. S 67°19' W 45.96 ft. with signs 54-3 and 54-4 and brass washer.  
 Set steel post 4 ft. South with signs 54-2 and 54-4 .

Painted scribe area and red band around trees.

Work Done By P. Murphy Title Party Chief Date 8/30/78 State Registration No. \_\_\_\_\_  
 or Agency \_\_\_\_\_

Certified Cor. Record Prepared ? Yes  No \_\_\_\_\_ Filed At: County Surveyor Date \_\_\_\_\_

## REMARKS

Witness by: R. Barton  
 M. Murtishaw

Index File No. C-3 T. 7S R. 33E M. Willamette Tract or Surv. No.

Cor.

12

13