

USDA-FOREST SERVICE

Index

File No. X-25

T 6 S. R. 34 E.

Merid. WILLAMETTE

CORNER RECORD (SEARCH)

(Ref. FSM 7151.4)

R.D. NORTH FORK JOHN DAY County UMATILLA

N.F. UMATILLA State OREGON

Tract or

Survey No. _____

Cor.

No. E 1/4

CORNER DIAGRAM

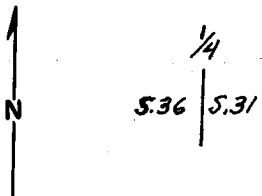

DESCRIBE CORNER MONUMENT FOUND

4' HIGH X 3' WIDE X 8' LONG STONE. ONLY ONE AVAILABLE OF CORRECT HEIGHT. POSSIBLE CHISEL MARK.

DESCRIBE BEARING TREES OR OTHER OFFICIAL ACCESSORIES FOUND

- ① STUMP HOLE, 5.81° W., 30 LKS. ROTTEN WOOD.
- ② STUMP HOLE, N. 8° E., (N. 28° E.) 13 LKS., DOWN TREE, ROTTED, NO MARKS.

PHOTO IDENTIFICATION DATA

Photo No. _____

Filed At. _____

Object Ident. _____

Ident. By _____

Signature

PLANE COORDINATE POSITION DATA

State _____ Zone _____

X _____

Y _____

Estab. By _____

Agency

DESCRIBE CORNER LOCATION RELATIVE TO NEAR-BY FEATURES, ALSO HOW TO REACH CORNER

TAKE ROAD 52 TO ROAD UP WHITE CREEK, GO TO END OF ROAD AND THEN UP WHITE CREEK 300'± TO POSTED LINE, GO EAST 240'± TO CORNER.

Signature

Clayton J. [unclear]

Title

LAND SURVEYOR

Division

Headquarters

Date

10/25/86

FS-7100-52 (9/68)

CORNER RECORD (PERPETUATION)

MONUMENT: DESCRIBE NEW MONUMENT SET, OR WORK DONE TO PRESERVE EXISTING MONUMENT

SET AT RECORD DISTANCES FROM STUMP HOLES, A 3" DIAM.
BRASS CAP IN A DRILLED AND GROUTED HOLE. CAP MKD.
PER SKETCH.

SET STEEL POSTS 4' ± S. & W. W/ATTN., PROP. BNDRY. AND MON.
SIGNS ATTACHED.

T 6 S
R 34 E R 35 E
1/4
S 36 | 531
RPLS 1910
1986

9

ACCESSORIES : DESCRIBE NEW BT'S WITNESS OBJECTS ETC. ESTABLISHED, OR WORK DONE TO PRESERVE EXISTING EVIDENCE

① 8" D.B.H. DOUGLAS FIR, S. 89 1/2° E, 25.4', SCRIBED 1/4 S 31 BT.

② 8" D.B.H. SUBALPINE FIR, N. 36° W, 15.3', SCRIBED 1/4 S 36 BT.

SET A BRASS WASHER MKD. RPLS 1910 BTWN. B&T ON EACH BT., SET B.T. TAGS, ATTN. SIGNS,
PAINTED BANDS AND FACES RED.

10

Work Done By C.J. MARTIN Title LAND SURVEYOR Date 10/25/86 State Registration No. LS 1910
or Agency

Certified Cor. Record Prepared ? Yes No Filed At: _____ Date _____

11

REMARKS

12

Index File No. X-25 T. 6 S. R. 34 E. M. WILLAMETTE Tract or Surv. No.

Cor. 1/4
36 | 31

13