

USDA-FOREST SERVICE

Index File No. V-25
 T 65 R. 33E

CORNER RECORD (SEARCH)

(Ref. FSM 7151.4)

Tract or Survey No. _____ Cor. No. _____

Merid. Will

R.D. NORTH FORK JOHN DAY County UMATILLA
 N.F. UMATILLA State OREGON

CORNER DIAGRAM

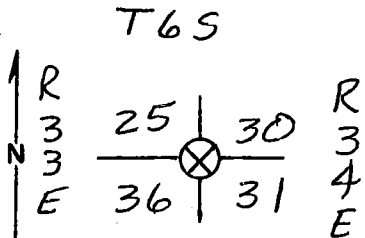

DESCRIBE CORNER MONUMENT FOUND

MOUND OF STONES AT CORNER - NONE OF RECORD SIZE & NONE WITH VISIBLE MARKS.

DESCRIBE BEARING TREES OR OTHER OFFICIAL ACCESSORIES FOUND

ORIG. 10" JUNIPER IS BARELY ALIVE. SCRIBES VISIBLE ON OPEN BLAZE, BEARS N83°E, 49.5 FT.
 ORIG. 10" FIR IS NOW 16" WITH HEALED BLAZE BEARS S42°E, 110.2 FT.
 OTHER 2 BTS OF RECORD ARE GONE.

PHOTO IDENTIFICATION DATA

Photo No. _____
 Filed At. _____
 Object Ident. _____
 Ident. By _____
Signature

DESCRIBE CORNER LOCATION RELATIVE TO NEAR-BY FEATURES, ALSO HOW TO REACH CORNER

CORNER IS ABOUT 75' SOUTH OF TRAIL 3165 & RIDGE TOP. LOOK AT FIRST JUNIPER IN OPENING SOUTH OF TRAIL.
 PUT BT SIGNS ON BOTH BTS

PLANE COORDINATE POSITION DATA

State _____ Zone _____
 X _____
 Y _____
 Estab. By _____
Agency

Signature _____ Title _____ Division _____ Headquarters _____ Date _____

Dennis J. Gaylord PLS 1636 S.O. 8-86 FS-7100-52 (3/68)

CORNER RECORD (PERPETUATION)

MONUMENT: DESCRIBE NEW MONUMENT SET, OR WORK DONE TO PRESERVE EXISTING MONUMENT

9

ACCESSORIES : DESCRIBE NEW BT'S WITNESS OBJECTS ETC. ESTABLISHED, OR WORK DONE TO PRESERVE EXISTING EVIDENCE

10

Work Done By _____ Title _____ Date _____ State Registration No.
or Agency _____

Certified Cor. Record Prepared ? Yes No Filed At: _____ Date _____ 11

REMARKS

12

Index File No. T. R. M. Tract or Surv. No. Cor. 13

(PA)

CORNER RECORD (SEARCH)

Index File No. V-25

Tract or Survey No. _____ Cor. No. V-25

T 6 R. 33 R.D. Ukiah County Umatilla

Merid. Willamette N.F. Umatilla State Oregon

CORNER DIAGRAM

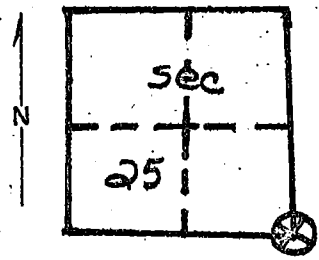

DESCRIBE CORNER MONUMENT FOUND.

None was found.

2

DESCRIBE BEARING TREES OR OTHER OFFICIAL ACCESSORIES FOUND

Stone no notches dead juniper scribing live fir with blaze.

3

PHOTO IDENTIFICATION DATA

Photo No. _____
 Filed At. _____
 Object Ident. _____
 Ident. By _____
 Signature _____

DESCRIBE CORNER LOCATION RELATIVE TO NEAR-BY FEATURES, ALSO HOW TO REACH CORNER

From inter. of upper long meadow trail and pearson ridge trail proceed East 2500' on stock driveway. File of rocks at corner ribbon on BTs.

PLANE COORDINATE POSITION DATA

State _____ Zone _____
 X _____
 Y _____
 Estob. By _____
 Agency _____

4

Signature _____ Title _____ Division USFS Headquarters Ukiah Date _____ 7100-52
 REV. 65 5