

**CORNER RECORD (SEARCH)**

(Ref. FSM 7151.4)

Tract or

Survey No. \_\_\_\_\_

No. V-3

Index  
File No. V-3

T6S R. 33E

R.D. Ukiah County Umatilla

Merid. Willamette

N.F. Umatilla State Oregon

**CORNER DIAGRAM**

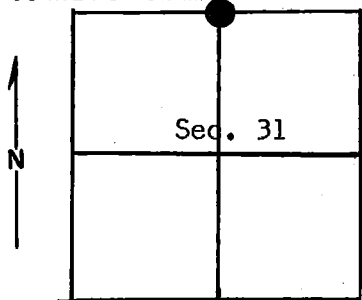

**DESCRIBE CORNER MONUMENT FOUND**

None

**DESCRIBE BEARING TREES OR OTHER OFFICIAL ACCESSORIES FOUND**

None

**PHOTO IDENTIFICATION DATA**

Photo No. \_\_\_\_\_

Filed At. \_\_\_\_\_

Object Ident. \_\_\_\_\_

Ident. By \_\_\_\_\_

*Signature*

**PLANE COORDINATE POSITION DATA**

State \_\_\_\_\_ Zone \_\_\_\_\_

X \_\_\_\_\_

Y \_\_\_\_\_

Estab. By \_\_\_\_\_

*Agency*

**DESCRIBE CORNER LOCATION RELATIVE TO NEAR-BY FEATURES, ALSO HOW TO REACH CORNER**

From Texas Bar, take Nye Creek or S 678 for about 2 miles to S 612 Road. Go 1 3/4 miles and corner is about 200 ft. North of road with location sign on road.

*Signature*

Title  
Party Chief

Division

Headquarters  
Krumbein Engineering

Date

7100-52-(3/68)

*14 Sep 78*

## CORNER RECORD (PERPETUATION)

MONUMENT: DESCRIBE NEW MONUMENT SET, OR WORK DONE TO PRESERVE EXISTING MONUMENT

Set 2½" x 30" iron pipe with brass cap (stamped)

Pipe is 23" in ground.

T 6S R 33E

¼	30
	S 31

1978

PLS 933

9

ACCESSORIES : DESCRIBE NEW BT'S WITNESS OBJECTS ETC. ESTABLISHED, OR WORK DONE TO PRESERVE EXISTING EVIDENCE

Fir 10" diam. brs. N 28° 10' E 34.55 ft. with signs 54-3 and 54-4 and brass washer.  
 Pine 16" diam. brs. S 68° 45' W 31.30 ft. with signs 54-3 and 54-4 and brass washer.

Set steel post 3 ft. East with sign 54-4.

Painted scribed area and red band around bearing trees.

10

Work Done By P. Murphy Title Party Chief Date 8/24/78 State Registration No. \_\_\_\_\_  
 or Agency \_\_\_\_\_

Certified Cor. Record Prepared ? Yes  No \_\_\_\_\_ Filed At: County Surveyor Date \_\_\_\_\_ 11

## REMARKS

Witness by: T. Hamby  
 M. Murtishaw

12

Index File No. V-3 T. 6S R. 33E M. Willamette Tract or Surv. No.

Cor.

13