

Index

File No. A-9

CORNER RECORD (SEARCH)

(Ref. FSM 7151.4)

Tract or

Survey No. _____

Cor.

No. _____

T 7S R. 31E

R.D. DALE

County GRANT

Merid. WILLAMETTE

N.F. UMATILLA

State OREGON

CORNER DIAGRAM

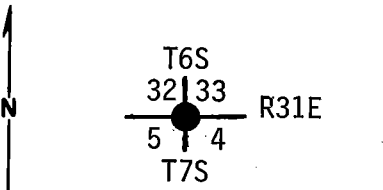

DESCRIBE CORNER MONUMENT FOUND

The original corner stone was not found. Roadbuilding, logging, and fencing (using rock jacks) has caused considerable disturbance in the area.

DESCRIBE BEARING TREES OR OTHER OFFICIAL ACCESSORIES FOUND

PHOTO IDENTIFICATION DATA

Photo No. 380-61

Filed At. UMATILLA N.F.

Object Ident. SUB STA.

Ident. By Nay Jambit

DESCRIBE CORNER LOCATION RELATIVE TO NEAR-BY FEATURES, ALSO HOW TO REACH CORNER

Corner located on an open ridge, 5 ft. north of an E-W fence and 40 ft. east of a jeep road.

PLANE COORDINATE POSITION DATA

State _____ Zone _____

X _____

Y _____

Estab. By _____

Agency

Signature Nay Jambit

Title P.L.S.

Division _____

Headquarters _____

Date

12-17-82

7100-52 (3. 68)

CORNER RECORD (PERPETUATION)

MONUMENT: DESCRIBE NEW MONUMENT SET, OR WORK DONE TO PRESERVE EXISTING MONUMENT

Corner position determined by survey along a true parallel of latitude between the N $\frac{1}{4}$ corner of Sec. 4 and the NW cor. of Sec. 5, T7S, R31E and at record distance of 0.50 chs (33 feet) west of the beginning of the descent to the East. At the corner position, we set a 2"x30" Galvanized Iron Pipe 14" in the ground to bedrock and supported in a mound of stone 6' dia. base to top of pipe, with brass cap attached, marked:

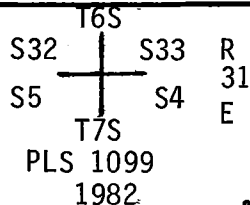

ACCESSORIES: DESCRIBE NEW BT'S WITNESS OBJECTS ETC. ESTABLISHED, OR WORK DONE TO PRESERVE EXISTING EVIDENCE

From which we mark the following Bearing Trees:

- A 20" Ponderosa Pine, scribed "T6S R31E S32 BT" on a double blaze bears N79°W 257.9 ft.
- An 11" Douglas Fir, scribed "T6S R31E S33 BT" on a double blaze bears N61 $\frac{1}{2}$ °E 88.1 ft.,
- A 14" Ponderosa Pine scribed "T7S R31E S4 BT" on a double blaze bears S7°E 104.6 ft.,
- And a 16" Ponderosa Pine, scribed "T7S R31E S5 BT" on a double blaze bears S13°W 268.4'.

Attached brass washer, marked "LS 1099" to lower blaze of new BT's.

Work Done By: Gary Langlitz Title Land Surveyor Date 8/25/82 State Registration No. LS 1099
or Agency

Certified Cor. Record Prepared? Yes No Filed At: GRANT AND UMATILLA COUNTY Date 12-82

REMARKS

Corner established and perpetuated in accordance with our survey contract.

Magnetic Compass (Declination 18 $\frac{1}{2}$ ° East)
Steel Tape

Witnesses: Gary Langlitz
Greg Orton
Jeff Anderson

10
11
12
13

Index File No. A-9

CORNER RECORD (SEARCH)

(Ref. FSM 7151.4)

Tract or Survey No. _____ Cor. No. _____

T 7S R. 31E

R.D. DALE

County GRANT-UMATILLA CO. LINE

Merid. WILL

N.F. UMATILLA

State OREGON

CORNER DIAGRAM

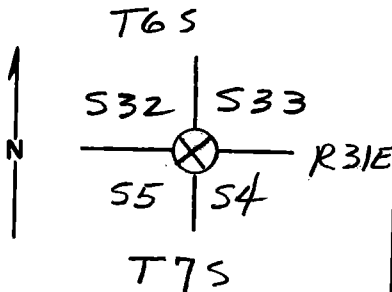

DESCRIBE CORNER MONUMENT FOUND

MOUND OF STONE WITH DEPRESSION IN CENTER WHERE ORIGINAL CORNER STONE HAS BEEN, AN E-W FENCELINE JUST SOUTH (40 FT) OF CORNER HAS RECENTLY BEEN REBUILT & I SUSPECT

DESCRIBE BEARING TREES OR OTHER OFFICIAL ACCESSORIES FOUND

THE CORNER STONE IS NOW IN A ROCK-JACK, THE M.O.S. AT THE CORNER IS MADE UP OF STONES TOO SMALL TO PLACE IN A ROCK-JACK, I FOUND 2 K TAGS AS DESCRIBED BY HOLLAMON IN 1978. I CHAINED WEST TO SEARCH THE 1/4 CORNER & FOUND THE CREEK CALL TO FITWELL'S

DESCRIBE CORNER LOCATION RELATIVE TO NEAR-BY FEATURES, ALSO HOW TO REACH CORNER

CORNER IS 10' EAST OF ROAD TO RADIO TOWER, THIS CORNER POSITION SHOULD BE VERIFIED BY SURVEY PRIOR TO MONUMENTATION.

PHOTO IDENTIFICATION DATA

Photo No. _____
 Filed At. _____
 Object Ident. _____
 Ident. By _____

Signature _____

PLANE COORDINATE POSITION DATA

State _____ Zone _____
 X _____
 Y _____
 Estab. By _____

Agency _____

Signature

Title

Division

Headquarters

Date

7100-52-(3/68)

Dennis L. Hayford

PLS 1636

5-81

CORNER RECORD (PERPETUATION)

MONUMENT : DESCRIBE NEW MONUMENT SET, OR WORK DONE TO PRESERVE EXISTING MONUMENT

ACCESSORIES : DESCRIBE NEW BT'S WITNESS OBJECTS ETC. ESTABLISHED, OR WORK DONE TO PRESERVE EXISTING EVIDENCE

Work Done By _____ Title _____ Date _____ State Registration No. or Agency _____

Certified Cor. Record Prepared ? Yes No Filed At: _____ Date _____

REMARKS

Index File No. T. R. M. Tract or Surv. No. Cor.

USDA-FOREST SERVICE

Index
File No. A-9

CORNER RECORD (SEARCH)
(Ref. FSM 7151.4)

Tract or
Survey No. _____ Cor.
No. A-9

T 7S R. 31E R.D. Dale County Grant
Merid. Willamette N.F. Umatilla State Oregon

CORNER DIAGRAM

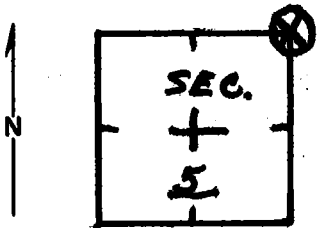

DESCRIBE CORNER MONUMENT FOUND

No BTs originally established. Georgia-Pacific location posters on a 14" (bushy) pond. pine about 200' west and a 14" (bushy) pond. pine about 175' north. Mound is about 10' east of road to radio tower & about 40' no. of fence, on break of ridge. Fence

DESCRIBE BEARING TREES OR OTHER OFFICIAL ACCESSORIES FOUND

runs approx. east-west.

PHOTO IDENTIFICATION DATA

Photo No. _____
Filed At. _____
Object Ident. _____
Ident. By _____
Signature

DESCRIBE CORNER LOCATION RELATIVE TO NEAR-BY FEATURES, ALSO HOW TO REACH CORNER

PLANE COORDINATE POSITION DATA

State _____ Zone _____
X _____
Y _____
Estab. By _____
Agency

BLM reject 5/80

Signature

T. Hollamon, Eng. Tech.

3/22/78

Title

Division

Headquarters

Date

7100-52 (3/68)

CORNER RECORD (PERPETUATION)

GPO 902-673

MONUMENT: DESCRIBE NEW MONUMENT SET, OR WORK DONE TO PRESERVE EXISTING MONUMENT

9

ACCESSORIES: DESCRIBE NEW BT'S WITNESS OBJECTS ETC. ESTABLISHED, OR WORK DONE TO PRESERVE EXISTING EVIDENCE

10

Work Done By _____ Title _____ Date _____ State Registration No. or Agency _____

Certified Cor. Record Prepared? Yes No Filed At: _____ Date _____

11

REMARKS

12

Index File No. T. R. M. Tract or Surv. No. Cor. 13

LAND CORNER RECORD

5680-2

1. T. 25 R. 31E No. A-9 Cor. Sec. Mer. W State Oregon (Rectangular) N. F. Umatilla Dist. Dale 4

2. Corner Status

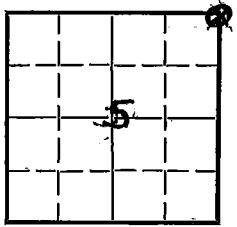

3. Original Description _____ Vol. _____ Page _____ Where Recorded _____

4. Description of Corners: Stone 18x9x7 in mound of stone.

5. Investigation Notes:

Found mound of stone marked by Georgia-Pacific.

7. Photo Identification

Photo No. _____

Ident. By: _____

8. Plane Coordinate Position Data

State _____ Zone _____

X _____

Y _____

Estab. By _____

Field Book No. _____

Where Filed _____

9. Evaluation

Authentic _____

Needs Verif. _____ Monument _____

Re-estab. _____ Survey _____

Land Status _____

6. Signed Wolford, Jr Title Eng. Tech Date 5-22-69

PERPETUATION RECORD

10. Monument:

11. Accessories

Field Book _____ Page _____

12. Set By _____ Title _____

13. Recorded By _____ Volume _____ Page _____
(Agency)

License _____ Agency _____ Date _____

(Date) (City) (County) (State)

14. Remarks:

A9-175-R31E-SEC-5