

History of original corner establishment:

Original survey by Meldrum and Campbell, Contract No. 380, 1881: Set a Pine post for Cor. to Sec.s 5, 6, 31, 32 from which a Fir 7 in. in diam. bears N31°E 50 lks. dist. Fir 16" in diam. bears N17°W 21 lks. dist. Fir 16" in diam. bears S67°W 32 lks. dist. Fir 30" in diam. bears S45°E 40 lks. dist.

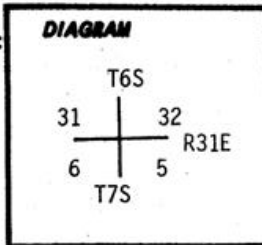

Remonumentation of corner position from original evidence by Douglas M. Ferguson, LS 848, filed with Grant County Surveyor Nov: 16, 1972.

Found a 16 in. Fir, live in good condition, with scribing visible, bearing N31°E, 30.6 ft. from corner position. Found a 36 in. Fir snag with scribing faintly visible bearing S45°E, 26.4 ft. from corner position. Found a 36 in. Fir, live in good condition, with grown-over blazes bearing S67°W, 21.1 ft. dist. from the corner. (Continued on Page 2 of 2)

Description of corner evidence found:

At the corner point, we find a 2 1/2" Iron Pipe, extending 6 inches above ground, with brass cap attached, marked:

From Which: The remaining 1881 original BT's:

A Fir snag with partial scribing visible on an unhealed blaze bears N21°E 31.5 ft. The original N.W. BT is gone. A 30" Grand Fir alive and well-healed bears S67°W 22.0, and a 30" Fir, now a rotten and shattered stob, bears S45°E 26.4 ft. Bearing trees established in 1972 by Ferguson:

A 32" Grand Fir, alive and healed, bears N17°W 19.4 ft., and a 10" Grand Fir, alive and healed, bears S40°E 44.9 ft.

T6S R31E
S31 | S32
S6 | S5
T7S
1972
PLS 848

Description of monument and accessories I established to perpetuate the original location of this corner:

We mark a new bearing tree:

A 10" Grand Fir, scribed "T6S R31E S32 BT" on a double blaze bears N82°E 42.9 ft., with brass washer marked "LS 1099" nailed to face of lower blaze.

Corner located 55' West of a Creek, course North, and 10' South of an E-W fence.

Magnetic Compass (Declination 19° East)

Steel Tape

August 26, 1982

Witnesses: Gary Langlitz
Jeff Anderson
Greg Orton

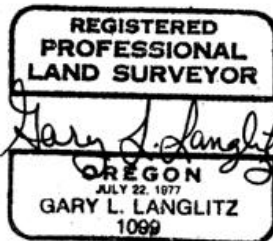

Office of... Surveyor County of... Umatilla
State of... Oregon I hereby certify that the within instrument was filed in this office
for record on the... 18 day of... JANUARY 1983
David H. Rhee by
(COUNTY OFFICIAL) (DEPUTY)

RECEIVED BY
Umatilla County Surveyor
Date _____
Rec'd by _____
No. 83-03-B

CERTIFIED RECORD OF LAND CORNER MONUMENTATION

History of original corner establishment: (continued)

Set a 30 in. x 2½ in. iron pipe with 3 in. brass cap marked as shown, 25 in. in the ground for the corner to Secs. 31, 32, 5 & 6, from which new BT's

A Fir 36 in. diam. bears N17°W, 19.4 ft. dist. marked T6S, R31E, S31 BT.

A Fir 9 in. diam. bears S40°E, 44.9 ft. dist. marked T7S R31E, S5 BT.

Distances taken to a brass washer in the blaze of each tree.

Used steel tape and magnetic compass with declination = 20°E.

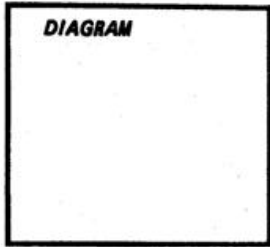

T.6S R.31E.
S31 | S32
S6 | S5
T7S.
1972
PLS 848

Description of corner evidence found:

Description of monument and accessories established to perpetuate the original location of this corner:

Office of Surveyor County of Umatilla
State of Oregon, I hereby certify that the within instrument was filed in this office
for record on the 10th day of January, 1983
David A. Kibben by Billy L. Sachman
(COUNTY OFFICIAL) (DEPUTY)

2-5

RECEIVED BY
Umatilla County Surveyor
Date _____
Rec'd By _____
P.o. 83-03-B