

CERTIFIED RECORD OF LAND CORNER MONUMENTATION

2-2

History of original corner establishment:

Not established during original survey.

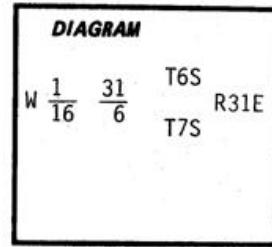

Description of corner evidence found:

None.

Description of monument and accessories I established to perpetuate the original location of this corner:

Monument Established

At the corner point as determined by survey and proportionate measurement between the N 1/4 corner and the NW corner of Section 6, T7S, R31E, we set a 2"x30" Galvanized Iron Pipe, 16" in the ground and supported in a mound of stone 4 ft. dia. base to top of pipe, with brass cap attached, marked:

From which we mark the following BT's:

A 17" Ponderosa Pine, scribed "W 1/16 S31 BT" on a double blaze bears N 71 1/2° W 33.0 ft.

And a 22" Ponderosa Pine, scribed "W 1/16 S6 BT" on a double blaze bears S 13 1/2° W 32.2 ft.

Attached brass washer marked "LS 1099" to lower blaze of new BT's.

Corner location established and perpetuated in accordance with Umatilla National Forest Cadastral Survey Contract No. 53-04R3-2-01275.

Magnetic Compass (18 1/2° East Declination)

Witnesses: Greg Orton
Jeff Anderson

August 26, 1982

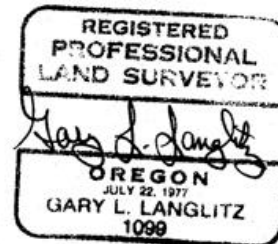
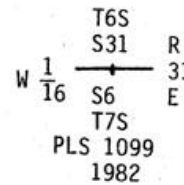

Office of _____ Surveyor _____ County of Umatilla
 State of Oregon, I hereby certify that the within instrument was filed in this office
 for record on the 12 day of January, 1982.
David H. Kles by _____
 (COUNTY OFFICIAL) (DEPUTY)

Form R6-7100-57 (9/71)

RECEIVED BY

Umatilla County Surveyor
 Date _____
 Rec'd By _____
 No. 83-03-B

2-2