

USDA-FOREST SERVICE

Index
File No. N-5

CORNER RECORD (SEARCH)

(Ref. FSM 7151.4)

Tract or
Survey No. _____ Cor.
No. _____

T 6S R. 30E

R.D. Ukiah County _____

Merid. Willamette

N.F. Umatilla State Oregon

CORNER DIAGRAM

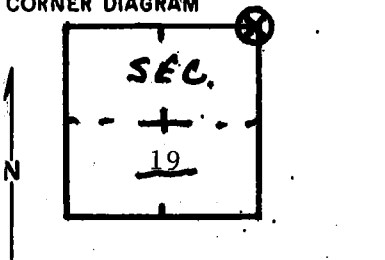

DESCRIBE CORNER MONUMENT FOUND

None

I Placed native stake at approx. corner location and tied Red ribbon on it.

DESCRIBE BEARING TREES OR OTHER OFFICIAL ACCESSORIES FOUND

A 40" pond. pine stump with B,T, scribing visible on N.W. face (stump is hollow-burned out). There are stump holes and tree remenants in the other 3 B.T. locations, there is a Heppner Imbr. Co. location poster beside old road approx 500' South.

PHOTO IDENTIFICATION DATA

Photo No. _____
Filed At. _____
Object Ident. _____
Ident. By _____
Signature

DESCRIBE CORNER LOCATION RELATIVE TO NEAR-BY FEATURES, ALSO HOW TO REACH CORNER

PLANE COORDINATE POSITION DATA

State _____ Zone _____
X _____
Y _____
Estab. By _____
Agency

T. HOLLADAY

Signature

ENG. TECH.

Title

Division _____ Headquarters _____

Division

Headquarters

Date

5/11/78

7100-52-(3/68)

CORNER RECORD (PERPETUATION)

GPO 902-673

MONUMENT: DESCRIBE NEW MONUMENT SET, OR WORK DONE TO PRESERVE EXISTING MONUMENT

9

ACCESSORIES : DESCRIBE NEW BT's WITNESS OBJECTS ETC. ESTABLISHED, OR WORK DONE TO PRESERVE EXISTING EVIDENCE

I placed blank B.T. tag on on attention poster on the 40" stump.

10

Work Done By _____ Title _____ Date _____ State Registration No. or Agency _____

Certified Cor. Record Prepared ? Yes No Filed At: _____ Date _____

11

REMARKS

12

Index File No. T. R. M. Tract or Surv. No. Cor. 13