

USDA-FOREST SERVICE

Index
File No. N-21

CORNER RECORD (SEARCH)

(Ref. FSM 7151.4)

Tract or
Survey No. _____ No. _____

T 6S R. 30E

R.D. UKIAH County UMATILLA

Merid. WILLAMETTE

N.F. UMATILLA State OREGON

CORNER DIAGRAM



T6S R30E
S14 | S13
S23 | S24

DESCRIBE CORNER MONUMENT FOUND

~~None~~
A MOUND OF STONES NEAR CORNER LOCATION

DESCRIBE BEARING TREES OR OTHER OFFICIAL ACCESSORIES FOUND

30" DOWN PINE SNA @ S29W 54.1'. SCRIBING VISIBLE.
STUMP HOLE WITH PIECES OF ROTTEN STUMP N60W 82.5'

PHOTO IDENTIFICATION DATA

Photo No. _____
Filed At. _____
Object Ident. _____
Ident. By _____
Signature

PLANE COORDINATE POSITION DATA

State _____ Zone _____
X _____
Y _____
Estab. By _____
Signature Agency

DESCRIBE CORNER LOCATION RELATIVE TO NEAR-BY FEATURES, ALSO HOW TO REACH CORNER

THERE IS A LOCATION TAG 1300' SOUTH OF CORNER AND
ONE 1200' EAST OF CORNER ON AN OLD ROAD. A ROAD
RUNS NEXT TO CORNER.

Signature

Title

Division

Headquarters

Date

7100-52-(3/68)

CORNER RECORD (PERPETUATION)

MONUMENT: DESCRIBE NEW MONUMENT SET, OR WORK DONE TO PRESERVE EXISTING MONUMENT

SET A 2"x30" IRON PIPE WITH A BRASS-CAP MARKED: T6S R30E
 S14 S13
 S23 S24
 1978
 PLS 346

MONUMENT IS IN MOUND OF STONES.

ACCESSORIES : DESCRIBE NEW BT'S WITNESS OBJECTS ETC. ESTABLISHED, OR WORK DONE TO PRESERVE EXISTING EVIDENCE

12" PINE S54W 29.6' MARKED: T6S R30E S23 BT
 16" PINE N23W 64.0' MARKED: T6S R30E S14 BT
 14" PINE S34E 94.0' MARKED: T6S R30E S24 BT
 16" PINE N29E 27.0' MARKED: T6S R30E S13 BT

ALL BT'S HAVE A RED-PAINTED STRIPE, BEARING TREE SIGNS, AND AN ATTENTION SIGN. THE NEW BT'S HAVE A BRASS WASHER STAMPED PLS 346 NAILED TO THE LOWER BLAZE. THERE ARE FENCE POSTS ON LINE NEAR THE CORNER.

STEEL

Work Done By W.O. HARRIS Title _____ Date _____ State Registration No. PLS 346
 or Agency _____

Certified Cor. Record Prepared? Yes No Filed At: _____ Date _____

REMARKS

Index File No.

T.

R.

M.

Tract or Surv. No.

Cor.

Index N-21
 File No. _____
 T 6S R. 30E
 Merid. Will.

CORNER RECORD (SEARCH)

(Ref. FSM 7151.4)

Tract or Survey No. _____
 Cor. No. N-21

R.D. Ukiah County Umatilla
 N.F. Umatilla State Oregon

CORNER DIAGRAM

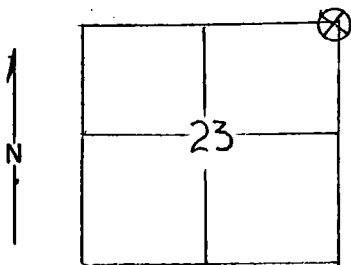

DESCRIBE CORNER MONUMENT FOUND

A pile of stones with no markings was 2'x2'x1' and 8" above ground. It was also in poor condition.

2

DESCRIBE BEARING TREES OR OTHER OFFICIAL ACCESSORIES FOUND

A ponderosa pine log bearing S29°W 125 lks. away. It is in poor condition, soon will be rotted away. Attached an attention sign and a location tag to log. Painted 6" red band around it and also painted scribing red. The bt has good scribing on it. At corner location, put two steel posts up with two signs attached to each, an attention and property boundary sign.

3

PHOTO IDENTIFICATION DATA

Photo No. _____
 Filed At. _____
 Object Ident. _____
 Ident. By _____
Signature

6

7

PLANE COORDINATE POSITION DATA

State _____ Zone _____
 X _____
 Y _____
 Estab. By _____
Agency

8

DESCRIBE CORNER LOCATION RELATIVE TO NEAR-BY FEATURES, ALSO HOW TO REACH CORNER

4

Signature
MLC

Title
For, Tech,

Division
USFS

Headquarters
Ukiah

Date
4/20/78

7100-52 (3/68)

5