

CERTIFIED RECORD OF LAND CORNER MONUMENTATION

History of original corner establishment:
Unsurveyed - subdivided section

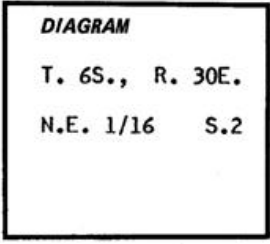

No record of subsequent remonumentation found in County Records.

Description of corner evidence found:
None.

Description of monument and accessories established to perpetuate the original location of this corner:

Set 2½" x 30" iron pipe 18" in ground with a brass cap marked as shown:
From which I scribed Bearing Trees.

- A 10" pine S. 45°14' E. 67.5 ft. mkd. N.E. 1/16 S.2 BT.
- A 10" pine S. 42°07' W. 68.2 ft. mkd. N.E. 1/16 S.2 BT.

Nailed a brass washer mkd. PLS 933 on the BT blaze on both trees.
Set a steel fence post 3 ft. West of corner. Raised a mound of stone 3 ft. base within 2" to the top of pipe. Used transit and steel tape, measuring to the center of BTs.

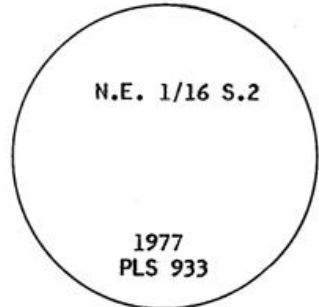
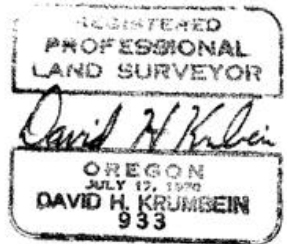

Office of.....**County Surveyor**..... County of.....**Umatilla**.....
 State of.....**Oregon**..... I hereby certify that the within instrument was filed in this office
 for record on the..... day of....., 19.....
David H. Krumbein by.....
 (COUNTY OFFICIAL) (DEPUTY)

B-20