

USDA-FOREST SERVICE

Index  
File No. N-5

CORNER RECORD (SEARCH)

(Ref. FSM 7151.4)

Tract or  
Survey No. \_\_\_\_\_ Cor.  
No. \_\_\_\_\_

T 6N R. 38E

R.D. WALLA WALLA County UMATILLA

Merid. WILLAMETTE

N.F. UMATILLA State OREGON

CORNER DIAGRAM

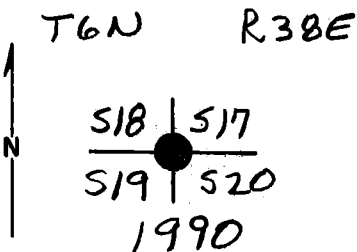

DESCRIBE CORNER MONUMENT FOUND

BRASS CAPPED STEEL PIPE SET FROM ORIGINAL  
CORNER EVIDENCE BY BLM.

DESCRIBE BEARING TREES OR OTHER OFFICIAL ACCESSORIES FOUND

PHOTO IDENTIFICATION DATA

Photo No. \_\_\_\_\_  
Filed At. \_\_\_\_\_  
Object Ident. \_\_\_\_\_  
Ident. By \_\_\_\_\_  
*Signature*

DESCRIBE CORNER LOCATION RELATIVE TO NEAR-BY FEATURES, ALSO HOW TO REACH CORNER

600 FT NORTH OF MILL CREEK ROAD.

PLANE COORDINATE POSITION DATA

State \_\_\_\_\_ Zone \_\_\_\_\_  
X \_\_\_\_\_  
Y \_\_\_\_\_  
Estab. By \_\_\_\_\_  
*Agency*

Signature

Title

Division

Headquarters

Date

1990

FS-7100-52 (3/68)

**CORNER RECORD (PERPETUATION)**

**MONUMENT: DESCRIBE NEW MONUMENT SET, OR WORK DONE TO PRESERVE EXISTING MONUMENT**

**ACCESSORIES : DESCRIBE NEW BT'S WITNESS OBJECTS ETC. ESTABLISHED, OR WORK DONE TO PRESERVE EXISTING EVIDENCE**

Work Done By. \_\_\_\_\_ Title \_\_\_\_\_ Date \_\_\_\_\_ State Registration No. \_\_\_\_\_  
or Agency \_\_\_\_\_  
Certified Cor. Record Prepared ? Yes No Filed At: \_\_\_\_\_ Date \_\_\_\_\_

**REMARKS**

Index File No. T. R. M. Tract or Surv. No. Cor.

Index

File No. N-5

CORNER RECORD (SEARCH)

(Ref. FSM 7151.4)

Tract or

Survey No. \_\_\_\_\_

Cor.

No. \_\_\_\_\_

T 6N R. 38E

R.D. WALLA WALLA County UMATILLA

Merid. Will

N.F. UMATILLA State OREGON

CORNER DIAGRAM

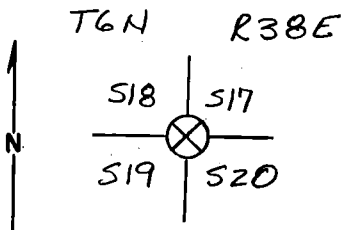

DESCRIBE CORNER MONUMENT FOUND

1/4" IRON PIPE W/ UNMARKED IRON PIPE CAP, PROTRUDING 18" ABOVE GROUND. A 1/2" IRON ROD N 5'±.

DESCRIBE BEARING TREES OR OTHER OFFICIAL ACCESSORIES FOUND

ORIG. 16" FIR IS NOW A SAWN STUMP ACROSS CREEK FROM CORNER. SCRIBING VISIBLE, "BT" BEARS N45°W, 44± FT.  
 ORIG 5" FIR IS NOW A WINDFALL & HAS ROLLED DOWN SLOPE 20'. SCRIBING IS VISIBLE, CANNOT DETERMINE WHERE TREE STOOD.  
 ORIG. 24" FIR IS DOWN & DECAYED. NO SCRIBING VISIBLE. STUMP HOLE BEARS S6°W, 62± FT.

DESCRIBE CORNER LOCATION RELATIVE TO NEAR-BY FEATURES, ALSO HOW TO REACH CORNER

2 NEW B.T.'S SET BY PRIVATE SURVEYOR ARE ALIVE & IN GOOD CONDITION. CORNER IS NORTH OF MILL CRK ROAD 600 FT. ON EAST SIDE OF DRAW.

PHOTO IDENTIFICATION DATA

Photo No. \_\_\_\_\_

Filed At. \_\_\_\_\_

Object Ident. \_\_\_\_\_

Ident. By \_\_\_\_\_

Signature

PLANE COORDINATE POSITION DATA

State \_\_\_\_\_ Zone \_\_\_\_\_

X \_\_\_\_\_

Y \_\_\_\_\_

Estab. By \_\_\_\_\_

Agency

Signature

Title

Division

Headquarters

Date

*Jenniss S. Hayward*

PLS 1636

3-25-81

7100-52-(3/68)

**CORNER RECORD (PERPETUATION)**

**MONUMENT: DESCRIBE NEW MONUMENT SET, OR WORK DONE TO PRESERVE EXISTING MONUMENT**

9

**ACCESSORIES : DESCRIBE NEW BT'S WITNESS OBJECTS ETC. ESTABLISHED, OR WORK DONE TO PRESERVE EXISTING EVIDENCE**

10

Work Done By \_\_\_\_\_ Title \_\_\_\_\_ Date \_\_\_\_\_ State Registration No. or Agency \_\_\_\_\_

Certified Cor. Record Prepared ? Yes No Filed At: \_\_\_\_\_ Date \_\_\_\_\_

**REMARKS**

12

Index File No. T. R. M. Tract or Surv. No. Cor. 13

Index File No. N-5

**CORNER RECORD (SEARCH)**

(Ref. FSM 7151.4)

Tract or Survey No. C

Cor. No. N-5

T 6N R. 38E

R.D. \_\_\_\_\_ County \_\_\_\_\_

Merid. \_\_\_\_\_

N.F. \_\_\_\_\_ State \_\_\_\_\_

**CORNER DIAGRAM**

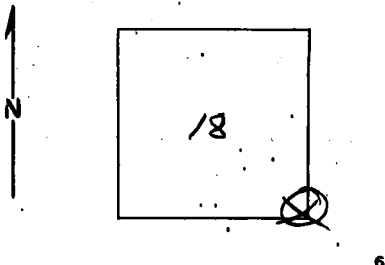

**DESCRIBE CORNER MONUMENT FOUND**

County Record = Line # 11, Drawing G-6, H145,  
= ? , Harris 1969, Krumbeln 1972.  
(Krumbeln says a B.T. stump remains)

**DESCRIBE BEARING TREES OR OTHER OFFICIAL ACCESSORIES FOUND**

Harris' plat shows iron pipe & B.T.

**PHOTO IDENTIFICATION DATA**

Photo No. \_\_\_\_\_  
Filed At. \_\_\_\_\_  
Object Ident. \_\_\_\_\_  
Ident. By \_\_\_\_\_  
*Signature*

**DESCRIBE CORNER LOCATION RELATIVE TO NEAR-BY FEATURES, ALSO HOW TO REACH CORNER**

**PLANE COORDINATE POSITION DATA**

State \_\_\_\_\_ Zone \_\_\_\_\_  
X \_\_\_\_\_  
Y \_\_\_\_\_  
Estab. By \_\_\_\_\_  
*Agency*

Signature

*T.G.H.*

Title

Division

Headquarters

Date

*2-6-79*

**CORNER RECORD (PERPETUATION)**

**MONUMENT : DESCRIBE NEW MONUMENT SET, OR WORK DONE TO PRESERVE EXISTING MONUMENT**

9

**ACCESSORIES : DESCRIBE NEW BT'S WITNESS OBJECTS ETC. ESTABLISHED, OR WORK DONE TO PRESERVE EXISTING EVIDENCE**

10

Work Done By \_\_\_\_\_ Title \_\_\_\_\_ Date \_\_\_\_\_ State Registration No. or Agency \_\_\_\_\_

Certified Cor. Record Prepared ? Yes No Filed At: \_\_\_\_\_ Date \_\_\_\_\_

11

**REMARKS**

12

Index File No. T. R. M. Tract or Surv. No. Cor. \_\_\_\_\_

13