

OREGON CORNER RESTORATION FORM

COUNTY: Umatilla. DATE: 04/09/08

CORNER DESIGNATION: X-13, The East One-Quarter Corner of Section 33, Township 6 North, Range 36 East, W.M..

PREVIOUS RENEWALS/SURVEYS ETC.: Corner originally set by Odell & Lewis under GLO Contract No. 110, dated February 7, 1865. Notes state: Set 1/4 Sec. post. Drove charred stake; dug pits & raised mound, as per instructions.

John Kimbrell, in his survey recorded at Book 1, Page 401, Record of Private Surveys, surveyed through the corner area but did not recover or reestablish the corner.

MONUMENT AND ACCESSORIES FOUND: None. Falls in wheat field approximately West and South of improved portions of Powerline Road. There are no nearby features.

MONUMENT MARKING DETAIL:

T6N R36E
1/4
S33 | S34
2008
PLS 1106

MONUMENT SET: Reestablished corner point at by single proportionate measure between the Northeast and Southeast corners of Section 33. At the reestablished corner point, set a 2 3/8" brass cap on a 1 1/4" x 30" galvanized iron pipe, with cap buried 22" below ground level, marked as shown in "Monument Marking Detail".

New accessories:

- A silver deep-1 magnet bears North 15 1/2° East, 27.9 feet.
 - A purple deep-1 magnet bears South 79 1/2° East, 28.2 feet.
 - A blue deep-1 magnet bears South 22 1/2° West, 29.8 feet.
 - An orange deep-1 magnet bears North 73° West, 28.4 feet.
- Deep-1 magnets are buried 24" below ground level with bearing object signs.

LOCATION AND COMMENTS: Corner is buried in wheat field 200' West of Powerline Road.

OREGON STATE PLANE COORDINATE, North Zone, NAD 83(91), International Feet:

N = 841795.00
E = 8759357.89

FIRM: Wells Surveying
P.O. Box 1696
Pendleton, OR 97801

COMPASS DECLINATION: 18° East

Surveyor's Seal

Witnesses: Jason Wells, LSIT

\6N36X13

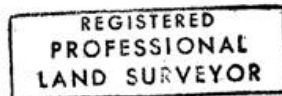

With R. Wells

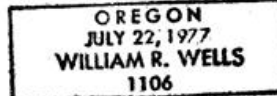

Expires 6-30-10

09-10-C