

OREGON CORNER RESTORATION FORM

COUNTY: Umatilla. DATE: 04/10/08

CORNER DESIGNATION: R-23, the North One-Quarter Corner of Section 25, Township 6 North, Range 36 East, W.M..

PREVIOUS RENEWALS/SURVEYS ETC.: Corner originally established by Odell & Lewis under GLO Contract No. 110, dated February 7, 1865. Notes state: Set 1/4 Sec. post at ft. of hill, facing E. Drove charred stake; dug pits & raised mound, and per instructions.

Bartleson, in his Survey No. 99-282-B, calculated a position for this corner but did not consider the existing old field line evidence.

MONUMENT AND ACCESSORIES FOUND: None.

MONUMENT MARKING DETAIL:

T6N R36E

1 S24

4 S25

2008

PLS 1106

MONUMENT SET: I reestablished this corner on line between the Northeast and Southeast Corners of Section 25, holding the top of a "stepped" North-South field berm for departure. At the reestablished corner point, set a 2 3/8" brass cap on a 1 1/4" x 30" galvanized iron pipe with cap buried 22 inches below ground level, marked as shown in "Monument Marking Detail".

New accessories:

A silver deep-1 magnet bears North 53° East, 21.8 feet.

A purple deep-1 magnet bears South 20 1/2° East, 27.7 feet.

A blue deep-1 magnet bears South 42 1/2° West, 28.6 feet.

An orange deep-1 magnet bears North 31° West, 27.4 feet.

Deep-1 magnets are buried 20" below ground surface with bearing object signs.

LOCATION AND COMMENTS: Corner is located at the top of a stepped field berm extending North-South. No nearby features other than field berm.

OREGON STATE PLANE COORDINATE, North Zone, NAD 83(91), International Feet:

N = 850124.56

E = 8772380.20

FIRM: Wells Surveying
P.O. Box 1696
Pendleton, OR 97801

COMPASS DECLINATION: 18° East

Surveyor's Seal

Witnesses: Jason Wells, LSIT

\6N36R23

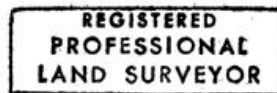

William R. Wells

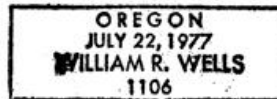

renews 6-30-10

09-10-c