

OREGON CORNER RESTORATION FORM

COUNTY: Umatilla

DATE: October 6, 2005

CORNER DESIGNATION: L-17 East 1/4 Corner Section 15, T. 6 North, Range 36 E.W.M.

PREVIOUS RENEWALS/SURVEYS ETC.

Odell and Lewis drove charred stake (Contract No. 110, dated February 7, 1865)

MONUMENT AND ACCESSORIES FOUND: None

MONUMENT MARKING DETAIL:

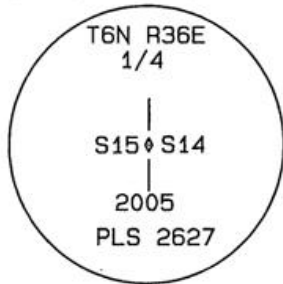

OREGON STATE PLANE COORDINATES, NORTH ZONE, NAD'83 ('91), INT. FEET:

NORTH: 857, 835.26

EAST: 8, 764, 177.26

MONUMENT SET (PROCEDURES AND DESCRIPTION):

At single proportion distance between the brass cap set as the closing corner common to Sections 15 and 14 on the state line and the brass disk found at the Southeast Corner of Section 15, I set a 2" aluminum cap on a 5/8" x 30" steel rebar slightly below flush with the paved surface of Hood Road. The monument is marked as shown above.

NEW ACCESSORIES:

A 5/8" X 30" steel rebar with blue plastic cap marked "UCPWD...LS2627" bears S48°11'02"W, 37.38'. A bearing object tag is wired to the rebar.

A 5/8" X 30" steel rebar with blue plastic cap marked "UCPWD...LS2627" bears N46°21'08"W, 39.43'. A bearing object tag is wired to the rebar.

A railroad spike stamped "LS2627" with punch mark marking Station 378+98.54 P.I. of Hood Road bears N02°51'35"W, 229.72'.

A railroad spike stamped "LS2627" with punch mark marking Station 374+37.08 P.I. of Hood Road bears S01°48'53"W, 232.13'.

SKETCH: NO SCALE

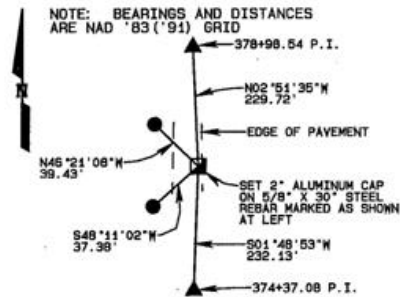

▲ FOUND RAILROAD SPIKE SET FLUSH WITH PAVEMENT IN ROAD LEGALIZATION SURVEY

● SET 5/8" X 30" STEEL REBAR WITH BLUE PLASTIC CAP MARKED "UCPWD...LS2627"

LOCATION AND COMMENTS:

The monument is set in the asphalt near the east shoulder of Hood Road approximately 0.15 mile south of the Oregon-Washington State Line.

COMPASS DECLINATION:

N/A

FIRM/AGENCY:

Umatilla County Road Dept. 3920 Westgate Pendleton, Oregon 97801

PARTY CHIEF:

Gary Roberts

NOTES: None

WITNESS: None

SURVEYOR'S SEAL

REGISTERED PROFESSIONAL LAND SURVEYOR

Jay R. Roberts OREGON JULY 30, 1993 GARY R. ROBERTS 2627

RENEWS 12/31/06

RECEIVED BY

Umatilla County Surveyor

Date 10-05

Rec'd By KK

AC-178-A

05-178-C