

OREGON CORNER RESTORATION FORM

Section: 15 & 16
Township: 6 North
Range: 34 East of the Willamette Meridian
County: Umatilla
Date: June 1, 2002

Corner Indexing Information: Township 6N Range 34E Corner Code L 13 (Willamette Meridian)

Additional Identifier: (e.g. BLM designation for the corner, street intersection, plat name, block, lot, etc.)

This quarter corner is common to sections 15 & 16.

Oregon Plane Coordinates: N: 856148.074 E: 8695481.838

Zone: North **Order:** second **Datum:** NAD83-91 **Convergence:** 1°22'36.7" **Scale Factor:** .99997208

Previous Renewals/Surveys, etc: Originally surveyed by U.S. Deputy Surveyor William Odell under his contract No. 110, dated 8-23-1865. The Surveyor General's notes state, "set ¼ section post, drove charred stake, dug pits, and raised mounds as per instructions." Umatilla County Road No. 308 survey, dated 1888, Arnold set a stone 15"x13"x10" marked ¼ on west face of the surveyed position. A 1951 survey by Melton and Criger shows ¼ corner found. Umatilla County survey No. 91-21-C, dated 2-10-1991, Tomkins Land Surveying found a basalt stone 2 ½ feet below ground with a "+" on top and marked ¼ on the west face and set a 2 ½" brass cap on a 1"x30" galvanized iron pipe.

Monument(s) & Accessories Found (Condition & Source):

At the West quarter corner of section 15, T6N R34E, found a 2 ½" brass cap on 1" galvanized pipe 6" below the surface in an alfalfa field.

Monument Set (Procedures & Description):

Since the original bearing object was plowed over, removed the old one and reset 17" below the surface using the original bearing objects of the LCR corner code L-13 Tomkins Surveying dated 2-10-91



Monument Detail:

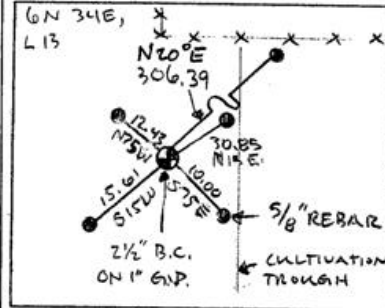

New Accessories: WE SET:

A 5/8 rebar with yellow plastic cap stamped 'Tomkins Surveying' 12" below surface which bears N 15° E ~ 30.85 feet from the corner. A 5/8 rebar with yellow plastic cap stamped 'Tomkins Surveying' 12" below surface which bears S 75° E ~ 10.00 feet from the corner. A 5/8 rebar with yellow plastic cap 16" below surface stamped 'Tomkins Surveying' which bears S 15° W ~ 15.61 feet from the corner. A 5/8 rebar with yellow plastic cap stamped 'Tomkins Surveying' which bears N 75° W ~ 12.43 feet from the corner. Found a 5/8" rebar with a yellow plastic cap stamped 'Tomkins Surveying' N 20° E ~ 306.36 feet.

Location & Comments:

Compass Declination:

19° East

Firm/Agency: Tomkins Land Surveying, Inc.
 20 E. Poplar, Suite 204
 Walla Walla, WA 99362

Party Chief: Bryan Martin
Notes: Bryan Martin
Witness: Eric Flowers

Surveyor's Seal

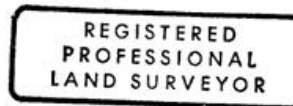

Handwritten signature of Paul W. P. Tomkins

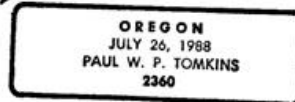

renews 6/30/04
6/30/02