

Index  
File No. 2-11

**CORNER RECORD (SEARCH)**

(Ref. FSM 7151.4)

T 5 S R. 3/4 E

R.D. LaGrande

County Union

Tract or Survey No. \_\_\_\_\_  
Cor. No. C 1/4

Merid. Willamette

N.F. WW-16

State Oregon

CORNER DIAGRAM

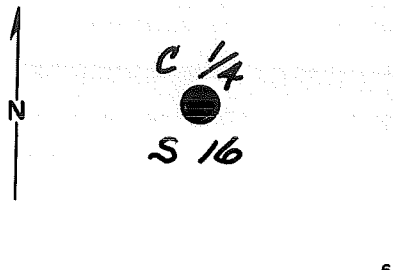

DESCRIBE CORNER MONUMENT FOUND

None

DESCRIBE BEARING TREES OR OTHER OFFICIAL ACCESSORIES FOUND

none

PHOTO IDENTIFICATION DATA

Photo No. \_\_\_\_\_  
Filed At. \_\_\_\_\_  
Object Ident. \_\_\_\_\_  
Ident. By \_\_\_\_\_  
*Signature* \_\_\_\_\_

DESCRIBE CORNER LOCATION RELATIVE TO NEAR-BY FEATURES, ALSO HOW TO REACH CORNER

Approx. 150 ft. E of road No. S536D.

PLANE COORDINATE POSITION DATA

State \_\_\_\_\_ Zone \_\_\_\_\_  
X \_\_\_\_\_  
Y \_\_\_\_\_  
Estab. By \_\_\_\_\_  
*Agency* \_\_\_\_\_

Signature  
**Hambleton**

Title

Division  
**ORLS**

Headquarters  
**645**

Date  
**8-78**

7100-52-(3/68)

**CORNER RECORD (PERPETUATION)**

MONUMENT: DESCRIBE NEW MONUMENT SET, OR WORK DONE TO PRESERVE EXISTING MONUMENT

Set a 2 1/2" x 30" iron pipe w/brass cap mkd.:  
Large mound of stone around monument.

T 5 S  
C 1/4  
S 16  
R 3/4 E  
1978  
ORLS 645

9

ACCESSORIES : DESCRIBE NEW BT'S WITNESS OBJECTS ETC. ESTABLISHED, OR WORK DONE TO PRESERVE EXISTING EVIDENCE

8" pine bears N 18 W, 35.92 ft. scribed 1/4 S S 16 BT.

8" pine bears S 24 E, 7.88 ft. scribed 1/4 S S 16 BT.

Painted blaze and band of BT's red & yellow. Tagged trees w/54-3&4 signs

Set steel fence post by mound of stone w/signs 54-4,6&9.

10

Work Done By J. Hambleton Title Surveyor Date 8-78 State Registration No. or Agency ORLS 645

Certified Cor. Record Prepared? Yes  No  Filed At: Union CS Date \_\_\_\_\_

11

REMARKS

Witnesses: L. Green  
L. Shirley

12

Index File No.      T.      R.      M.      Tract or Surv. No.      Cor.      13