

Index File No. J-10

CORNER RECORD (SEARCH)
(Ref. FSM 7151.4)

Tract or Survey No. _____ Cor. No. 5/4 of _____

T 59 R. 34E

R.D. LA GRANDE County UNION Sect. 9 & 16

Merid. WILLAMETTE

N.F. W-W State OREGON

CORNER DIAGRAM

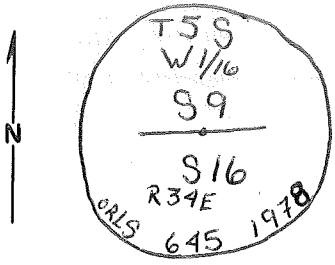

DESCRIBE CORNER MONUMENT FOUND 2 1/2" GALV. PIPE w/ 3" BRASS CAP

DESCRIBE BEARING TREES OR OTHER OFFICIAL ACCESSORIES FOUND. REPAINTED BLAZE & BAND ON BT'S ALL BT'S GOOD SHAPE

PHOTO IDENTIFICATION DATA

Photo No. _____
Filed At. _____
Object Ident. _____
Ident. By _____
Signature

DESCRIBE CORNER LOCATION RELATIVE TO NEAR-BY FEATURES, ALSO HOW TO REACH CORNER

PLANE COORDINATE POSITION DATA

State _____ Zone _____
X _____
Y _____
Estab. By _____
Agency

Signature	Title	Division	Headquarters	Date	7100-52-(3/68)
<u>EARL E. STRANG</u>	<u>CET</u>	<u>LLC</u>	<u>GREZ</u>	<u>7/26/93</u>	

1

2

3

6

7

8

4

5

CORNER RECORD (PERPETUATION)

310025-13 487

MONUMENT : DESCRIBE NEW MONUMENT SET, OR WORK DONE TO PRESERVE EXISTING MONUMENT

ACCESSORIES : DESCRIBE NEW BT'S WITNESS OBJECTS ETC. ESTABLISHED, OR WORK DONE TO PRESERVE EXISTING EVIDENCE

Work Done By _____ Title _____ Date _____ State Registration No. or Agency _____

Certified Cor. Record Prepared ? Yes No Filed At: _____ Date _____

REMARKS

Index File No. J-10 T. 5S R. 34E M. WM Tract or Surv. No.

S 1/4 Cor. of SECT 9 E 16

Index File No. J-10
T 5 S R R 3/4 E
Merid. Willamette

CORNER RECORD (SEARCH)

(Ref. FSM 7151.4)

R.D. LaGrande County Union State Oregon
N.F. WW-16 Tract or Survey No. _____
Cor. No. W-1/16

CORNER DIAGRAM

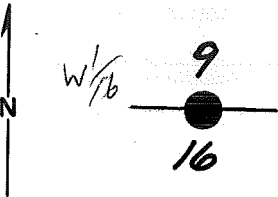

DESCRIBE CORNER MONUMENT FOUND

None

DESCRIBE BEARING TREES OR OTHER OFFICIAL ACCESSORIES FOUND

None

PHOTO IDENTIFICATION DATA

Photo No. _____
Filed At. _____
Object Ident. _____
Ident. By _____
Signature

PLANE COORDINATE POSITION DATA

State _____ Zone _____
X _____
Y _____
Estab. By _____
Agency

DESCRIBE CORNER LOCATION RELATIVE TO NEAR-BY FEATURES, ALSO HOW TO REACH CORNER

Approx. 30 ft. E of private road at point of timber.

Signature
Hambleton

Title

Division
ORLS

Headquarters
645

Date
8-78

Roger Green 9-17-91

CORNER RECORD (PERPETUATION)

MONUMENT: DESCRIBE NEW MONUMENT SET, OR WORK DONE TO PRESERVE EXISTING MONUMENT

Set a 2 $\frac{1}{2}$ " x 30" iron pipe w/brass cap mkd.:
Buried in large mound of stone and dirt.

T 5 S
W-1/16
S 9
S 16
R 34 E
1978
ORLS 645

9

ACCESSORIES: DESCRIBE NEW BT'S WITNESS OBJECTS ETC. ESTABLISHED, OR WORK DONE TO PRESERVE EXISTING EVIDENCE

6" pine bears N 34 30 W, 23.33 ft. scribed 1/16 S S 9 BT. - PIECES OF LOG,
7" pine bears N 50 E, 18.25 ft. scribed 1/16 S S 16 Bt. - STUMP
None: No trees available in Sec. 16 that could be used as bearing tree, therefore used the second tree also being in Sec. 9.
Painted blaze and band of BT's red & yellow. Tagged trees w/54-3&4 signs.
Set steel fence post by mound of stone w/signs 54-4, 6&9.

10

Work Done By J. Hambleton Title Surveyor Date 8-78 State Registration No. ORLS 645
or Agency

Certified Cor. Record Prepared? Yes No Filed At: Union CS Date

11

REMARKS

A L. PINE, 6" DIAM, N 61 E, 5.3 FT, SCRIBED "X BT", w/BRASS WASHER,
Witnesses: L. Green
L. Shirley
A L. PINE, 8" DIAM, N 25 W, 28.2 FT, SCRIBED "W 1/16 S 9 BT", w/BRASS WASHER.
ROGER GREEN 9-17-91 ORLS 2211

12

Index File No. JL10 T. 55 R. R3AE M. WILL. Tract or Surv. No. Cor. 13