

(Rectangular)

1. T. 55 R. 34E No. C-5 Cor. 14 Mer. Will State OREGON N. F. WALLOWA-WHITMAN Dist. LA - GRANDE

2. Corner Status

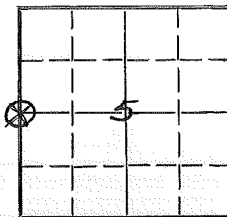

7. Photo Identification

Photo No. _____

Ident. By: _____

8. Plane Coordinate Position Data

State _____ Zone _____

X _____

Y _____

Estab. By _____

Field Book No. _____

Where Filed _____

9. Evaluation

Authentic _____ Needs Verif. _____ Monument NORe-estab. Survey _____

Land Status _____

3. Original Description _____ Vol. _____ Page _____ Where Recorded _____

4. Description of Corners: 40.46 BASALT STONE 15"x13"x7", 10" IN GROUND FOR 1/4 COR.
FROM WHICH A PINE 36" DIAM. BEARS N43°E 60 LKS. DIST
A PINE 45" DIAM BEARS S85°W 10 LKS DIST.

5. Investigation Notes:

BLAZED 34" DUG FIR 10' SNAG WITH "F.S. TAG
1937.

29" P.P. LINE WITH SCRIBING VISIBLE

PAINTED B.T. RED

TIN TROUGHS ROAD TO FLY RIDGE ROAD TO
COUNTY LINE 2 MILES WEST TO SEC. LINE
BOARD. COR. 660 FT. SOUTH BOARD ON P.P.

6. Signed T. WILLIAMS Title SUR. TECH Date JUNE 7, 1966

Index

File No. C 5

CORNER RECORD (SEARCH)

(Ref. FSM 7151.4)

Tract or

Survey No. _____

Cor.

No. _____

T 5S R. 34E

R.D. LaGrande County Umatilla

Merid. Willamette

N.F. Wallowa-Whitman State Oregon

CORNER DIAGRAM

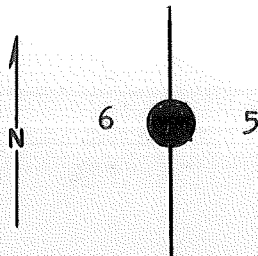

DESCRIBE CORNER MONUMENT FOUND

Brass cap PLS 1636

*Monumented by
Dennis Gaylord - Umatilla
Copy cert. records
in 5534F file*

DESCRIBE BEARING TREES OR OTHER OFFICIAL ACCESSORIES FOUND

Both original BT's
New BT in section 6- 10" DF N25W 21.6'
Date on tag is 5-12-83

PHOTO IDENTIFICATION DATA

Photo No. 677-156

Filed At. LaGrande

Object Ident. Approx corner

Ident. By _____

Signature

PLANE COORDINATE POSITION DATA

State _____ Zone _____

X _____

Y _____

Estab. By _____

Agency

Signature

Title

Division

Headquarters

Date

7100-52-(3.68)

David L. Dabstrom

CET

LaGrande

6-15-83

CORNER RECORD (PERPETUATION)

MONUMENT: DESCRIBE NEW MONUMENT SET, OR WORK DONE TO PRESERVE EXISTING MONUMENT

ACCESSORIES DESCRIBE NEW BT'S WITNESS OBJECTS ETC. ESTABLISHED, OR WORK DONE TO PRESERVE EXISTING EVIDENCE

Work Done By _____ Title _____ Date _____ State Registration No. or Agency _____

Certified Cor. Record Prepared ? Yes No Filed At: _____ Date _____

REMARKS

Index File No. T. R. M. Tract or Surv. No. Cor. _____

USDA-FOREST SERVICE

Index

File No. C-5

CORNER RECORD (SEARCH)

(Ref. FSM 7151.4)

Tract or Survey No. _____

Cor. No. _____

T 5S R. 34E

R.D. UKIAH

County UMATILLA

Merid. Will.

N.F. UMATILLA

State OREGON

CORNER DIAGRAM

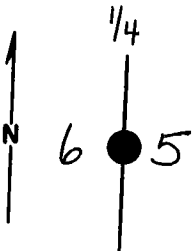

DESCRIBE CORNER MONUMENT FOUND

Original corner stone set firmly in ground and marked "1/4" on west face. Stone measures 18" x 14" x 7"

DESCRIBE BEARING TREES OR OTHER OFFICIAL ACCESSORIES FOUND

Original 36" now a 24" live ponderosa pine with serbes visible on a single partly healed blaze bears N43°E, 40.7 ft (39.6 ft to the blazed face)
Original 45" now a 41" Doug fir snag 12 feet high with a single healed blaze bears S88°W, 8.3 ft to the center of the tree @ the blaze (7.2 ft to the blazed face)

DESCRIBE CORNER LOCATION RELATIVE TO NEAR-BY FEATURES, ALSO HOW TO REACH CORNER

PHOTO IDENTIFICATION DATA

Photo No. _____

Filed At. _____

Object Ident. _____

Ident. By _____

Signature

PLANE COORDINATE POSITION DATA

State _____ Zone _____

X _____

Y _____

Estab. By _____

Agency

Signature

Title

Division

Headquarters

Date

7100-52-(3/68)

15/ DENNIS L. GAYLORD

L.S.

4

5

CORNER RECORD (PERPETUATION)

MONUMENT: DESCRIBE NEW MONUMENT SET, OR WORK DONE TO PRESERVE EXISTING MONUMENT

Set a 2" x 30" galvanized iron pipe w/a 2 1/2" brass cap attached, 16" into the ground and mound of stones. Buried the original corner stone alongside. Brass cap is marked: T5S R34E 1/4

S6155
PLS 1636
1983

ACCESSORIES: DESCRIBE NEW BT'S WITNESS OBJECTS ETC. ESTABLISHED, OR WORK DONE TO PRESERVE EXISTING EVIDENCE

an 11" Douglas-fir, blazed + scribed "1/4 S6BT" on a single blaze, bears N25°W, 21.6 ft.

Compass Declination - 18° EAST

Work Done By DENNIS L GAYLORD Title LAND SURVEYOR Date 5/12/83 State Registration No. OREGON or Agency PLS 1636

Certified Cor. Record Prepared? Yes No Filed At: UMATILLA Co. Surveyor Date

REMARKS

Index File No.

C-5

T.5S

R.34E

M. W.M.

Tract or Surv. No.

Cor.

USDA-FOREST SERVICE

Index File No. C-5

CORNER RECORD (SEARCH)

(Ref. FSM 7151.4)

Tract or Survey No. _____ No. C-5

T 5S R. 34E

R.D. Ukiah County Umatilla

Merid. Willamette

N.F. Umatilla State Oregon

CORNER DIAGRAM

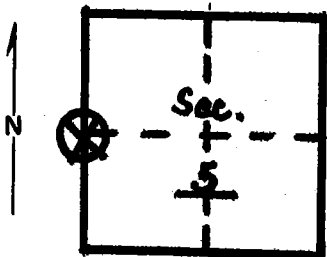

DESCRIBE CORNER MONUMENT FOUND

None

DESCRIBE BEARING TREES OR OTHER OFFICIAL ACCESSORIES FOUND

25" P. Pine in NE Quadrant with SW blaze, faint scribing visible. X chopped into tree above blaze and painted red. 43" Fir Snag 10' tall with closed NE blaze and FS location poster above blaze. Poster dated: 6/11/37 WOG. Doc Changers WH 6-7-66.

PHOTO IDENTIFICATION DATA

Photo No. _____
Filed At. _____
Object Ident. _____
Ident. By _____
Signature _____

DESCRIBE CORNER LOCATION RELATIVE TO NEAR-BY FEATURES, ALSO HOW TO REACH CORNER

PLANE COORDINATE POSITION DATA

State _____ Zone _____
X _____
Y _____
Estab. By _____
Agency _____

Signature _____ Title _____ Division _____ Headquarters _____ Date _____

Bill Moore

Eng. Tech.

8/77

7100-52-(3/68)

CORNER RECORD (PERPETUATION)

MONUMENT: DESCRIBE NEW MONUMENT SET, OR WORK DONE TO PRESERVE EXISTING MONUMENT

9

ACCESSORIES : DESCRIBE NEW BT'S WITNESS OBJECTS ETC. ESTABLISHED, OR WORK DONE TO PRESERVE EXISTING EVIDENCE

I placed black bearing tree posters on the 2 B.T.'s.

10

Work Done By _____ Title _____ Date _____ State Registration No.
or Agency _____

Certified Cor. Record Prepared ? Yes No Filed At: _____ Date _____ 11

REMARKS

12

Index File No. T. R. M. Tract or Surv. No. Cor. 13