

Index
File No. N-21

CORNER RECORD (SEARCH)

(Ref. FSM 7151.4)

Tract or Survey No. _____ Cor. No. _____

T 55 R. 33 1/2 E

R.D. LaGrande County Union

Merid. Willamette

N.F. W-W State Oregon

CORNER DIAGRAM

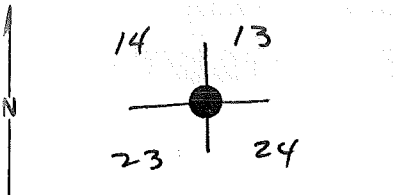

DESCRIBE CORNER MONUMENT FOUND

Original basalt stone, 13 x 8 x 7" firmly set 6" in ground, in collar of stone, mkd w/1 notch on E. + 3 notches on S. edges

DESCRIBE BEARING TREES OR OTHER OFFICIAL ACCESSORIES FOUND

- 1 Q Fir, 29" dia, brs N74E, 85 lks, w/scribe mark 1 visible on open blaze.
- 2 Q Mokogany, 11" dia, brs S47E, 22 lks, w/coated blaze.
- 3 Juniper, 31" dia, brs S45W, 21 lks, w/scribe TSS R33 1/2 E S23 BT.
- 4 " 26" " " N49W, 58 lks, " " TSS R33 1/2 E S14.

PHOTO IDENTIFICATION DATA

Photo No. _____
Filed At. _____
Object Ident. _____
Ident. By _____
Signature

DESCRIBE CORNER LOCATION RELATIVE TO NEAR-BY FEATURES, ALSO HOW TO REACH CORNER

PLANE COORDINATE POSITION DATA

State _____ Zone _____
X _____
Y _____
Estab. By _____
Agency

Signature _____ Title _____ Division _____ Headquarters _____ Date _____ 7100-52-(3/68)

CORNER RECORD (PERPETUATION)

MONUMENT: DESCRIBE NEW MONUMENT SET, OR WORK DONE TO PRESERVE EXISTING MONUMENT

Set a Brass cap mkd: T S S R 33 1/2 E
S 14 | S 13
S 23 | S 24
1977

ACCESSORIES: DESCRIBE NEW BT'S WITNESS OBJECTS ETC. ESTABLISHED, OR WORK DONE TO PRESERVE EXISTING EVIDENCE

Deposit corner stone alongside iron post.

Work Done By _____ Title _____ Date _____ State Registration No. or Agency _____

Certified Cor. Record Prepared? Yes No Filed At: _____ Date _____

REMARKS

Index File No. T. R. M. Tract or Surv. No. Cor.