

Index
File No. L 25
T 55 R. 33 1/2 E
Merid. Will.

CORNER RECORD (SEARCH)

Tract or
Survey No. _____
Cor.
No. _____

R.D. La Grande County Union
N.F. W W State Oregon

CORNER DIAGRAM

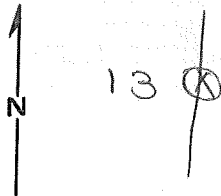

DESCRIBE CORNER MONUMENT FOUND

DESCRIBE BEARING TREES OR OTHER OFFICIAL ACCESSORIES FOUND

Found 2 BTs
1 14" Live PP with location poster scribing
facing S.W.
1 20" Live PP scribing facing S.E.
Both BTs have been chopped out

PHOTO IDENTIFICATION DATA

Photo No. _____
Filed At. _____
Object Ident. _____
Ident. By _____
Signature

PLANE COORDINATE POSITION DATA

State _____ Zone _____
X _____
Y _____
Estab. By _____
Agency

Signature

Title

Division

Headquarters

Date

7100-52

REV. 65 5

CORNER RECORD (PERPETUATION)

MONUMENT: DESCRIBE NEW MONUMENT SET, OR WORK DONE TO PRESERVE EXISTING MONUMENT

9

ACCESSORIES DESCRIBE NEW BT'S WITNESS OBJECTS ETC. ESTABLISHED, OR WORK DONE TO PRESERVE EXISTING EVIDENCE

10

Work Done By _____ Title _____ Date _____ State Registration No. or Agency _____

Certified Cor. Record Prepared ? Yes No Filed At: _____ Date _____

REMARKS

12

Index File No. T. R. M. Tract or Surv. No. Cor. 13

Index
File No. L-25

CORNER RECORD (SEARCH)
(Ref. FSM 7151.4)

Tract or Survey No. _____
Cor. No. _____

T 5 S R. 33 1/2 E 34 E R.D. LA GRANDE County UMATILLA Co.
Merid. Willamette N.F. WALLOWA-WHITMAN State OREGON

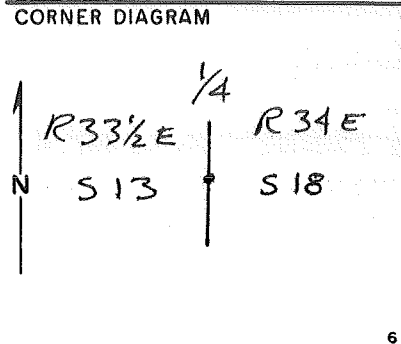

DESCRIBE CORNER MONUMENT FOUND

3 1/2" BLM BRASS CAP
RISING 14" ON 2 1/2" IRON PIPE

Stamp description: A circular stamp containing the text: 'T53' at the top, 'R33 1/2 E' on the left, '1/4' in the center, 'R34 E' on the right, 'S13' at the bottom left, 'S18' at the bottom right, and '1977' at the bottom.

DESCRIBE BEARING TREES OR OTHER OFFICIAL ACCESSORIES FOUND

13" P. PINE S73°E 34.0 FT. (1/4 S18 BT)
16" P. PINE N18°W 52.8 FT. (1/4 S - Healed Over)

PHOTO IDENTIFICATION DATA

Photo No. _____
Filed At. _____
Object Ident. _____
Ident. By _____
Signature

DESCRIBE CORNER LOCATION RELATIVE TO NEAR-BY FEATURES, ALSO HOW TO REACH CORNER

100 FT. East of Dirt track in Clearing
reached from end of Road 5160-362

PLANE COORDINATE POSITION DATA

State _____ Zone _____
X _____
Y _____
Estab. By _____
Agency

Signature D. SCOTT Title LS 1844 Division _____ Headquarters _____ Date 6/84 FS-7100-52 (3/68)

CORNER RECORD (PERPETUATION)

MONUMENT: DESCRIBE NEW MONUMENT SET, OR WORK DONE TO PRESERVE EXISTING MONUMENT

Raised Rock Mound around Cap
Placed Steel Fence Post 4.0 Ft. North with sign 54-4

ACCESSORIES: DESCRIBE NEW BT'S WITNESS OBJECTS ETC. ESTABLISHED, OR WORK DONE TO PRESERVE EXISTING EVIDENCE

Attached signs 54-3 & 54-4 to BT's
Painted 6" Red band around trees

Work Done By D. Scott Title Surveyor Date 6/84 State Registration No. or Agency LS 1844

Certified Cor. Record Prepared? Yes No Filed At: Umatilla Co. Surveyor's Office Date

REMARKS

Index File No. T. 5S R. 33 1/2 E W.M. Tract or Surv. No. Cor.

L-01

LAND CORNER RECORD

5680-2

1. T 5S R 33 1/2 E No. 4-25 Cor. 1/4 Mer. Will State OREGON N. F. WALLOWA-WHITMAN Dist. LA-GRANDE

2. Corner Status

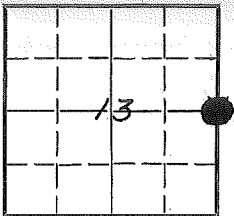

3. Original Description _____ Vol. _____ Page _____ Where Recorded _____

4. Description of Corners: BASALT STONE 15" X 12" X 10" 10" IN GROUND FOR 1/4 SEC. COR FROM WHICH: A PINE 10" DIAM. BEARS N36°W 80' LKS. DIST. A PINE 27" DIAM. BEARS N50°E 30' LKS. DIST.

Corner Remonumented by BLM 9/77

5. Investigation Notes:

FOUND 2 B.T.'S .

A 14" LINE RP. WITH LOCATION POSTER SCRIBING FACING S.W.

A 20" LINE RP. SCRIBING FACING S.E. BOTH B.T.'S HAVE BEEN CHOPPED OUT.

I PAINTED BOTH B.T.'S WITH RED PAINT. ALSO PAINTED LINE RED SOUTH & NORTH TIMBER INVENTORY PLOT NO. 044 NEAR COR.

BEST ACCESS IS ON FIRE ROAD 20 FROM FLY RIDGE FRAZIER G.S. ROAD.

GO TO SEC. LINE BOARD AND WALK SOUTH

7. Photo Identification

Photo No. _____

Ident. By: _____

8. Plane Coordinate Position Data

State _____ Zone _____

X _____

Y _____

Estab. By _____

Field Book No. _____

Where Filed _____

9. Evaluation

Authentic. X

Needs Verif. _____ Monument NO

Re-estab. X Survey _____

Land Status _____

6. Signed WAYNE HYDE Title CIVIL ENG TECH Date 6-13-66

PERPETUATION RECORD

10. Monument:

11. Accessories

Field Book _____ Page _____

12. Set By _____ Title _____
License _____ Agency _____ Date _____

13. Recorded By _____ Volume _____ Page _____
(Agency)

(Date) (City) (County) (State)

14. Remarks:

RECOVERY NOTES

PROPERTY CORNER INVESTIGATION

66R
L-25

LOCATION

T. 5 S R. 33 1/2 E

Mer. Will State Oregon

Forest WW Dist. LaGrande

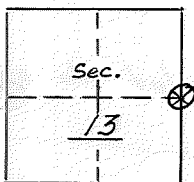

LEGEND

- Corner searched-no evidence
- Corner or accessory found
- Corner marked by perm. mon.

L-25

DESCRIPTION OF FOUND CORNER

MATERIAL: None SIZE: _____

HEIGHT ABOVE GROUND: _____ CONDITION: _____

MARKINGS: _____

DESCRIPTION OF FOUND ACCESSORIES

Found 2 BTs
 1 14" Live PP with location poster.
 Scribing facing S.W.
 1 20" Live PP. Scribing facing S.E.
 Both BTs have been chopped out.

NOTE: Indicate full investigative details on back of form.

PHOTO IDENTIFICATION

Symbol & date _____ Line or Roll _____ Exposure _____

How Identified _____ Where filed _____

RECOVERED BY: Wayne Hyde

DATE: 6-13-66

TITLE: Civil Eng. Tech.

I painted both BTs with red
paint. Also painted line red
south and north.

Timber inventory plot No 044
near corner.

Best access is on Fire road 20
from Fly Ridge - Frazier G.S. road.
Go to Sec. line board and walk
south.

Index File No. L-25
T 5 S R 33 1/2 E 34 E
Merid. Willamette

CORNER RECORD (SEARCH)
(Ref. FSM 7151.4)

Tract or Survey No. _____
Cor. No. _____

R.D. LA GRANDE County UMATILLA Co.
N.F. WALLOWA-WHITMAN State OREGON

CORNER DIAGRAM

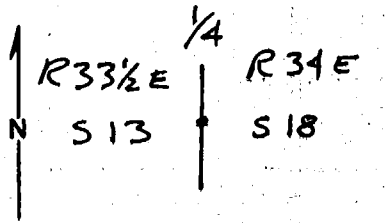

DESCRIBE CORNER MONUMENT FOUND

3 1/2" BLM BRASS CAP
RISING 14" ON 2 1/2" IRON PIPE



DESCRIBE BEARING TREES OR OTHER OFFICIAL ACCESSORIES FOUND

13" P. PINE S73°E 34.0 FT. (1/4 S18 BT)
16" P. PINE N18°W 52.8 FT. (1/4 S - Healed Over)

PHOTO IDENTIFICATION DATA

Photo No. _____
Filed At. _____
Object Ident. _____
Ident. By _____
Signature _____

DESCRIBE CORNER LOCATION RELATIVE TO NEAR-BY FEATURES, ALSO HOW TO REACH CORNER

100 FT. East of Dirt track in Clearing
reached from end of Road 5160-362

PLANE COORDINATE POSITION DATA

State _____ Zone _____
X _____
Y _____
Estab. By _____
Agency _____

Signature D. SCOTT Title LS 1844 Division _____ Headquarters _____ Date 6/84 FS-7100-52 (3/68)

CORNER RECORD (PERPETUATION)

MONUMENT: DESCRIBE NEW MONUMENT SET, OR WORK DONE TO PRESERVE EXISTING MONUMENT

Raised Rock Mound around Cap
Placed Steel fence Post 4.0 Ft. North with sign 54-4

ACCESSORIES: DESCRIBE NEW BT'S WITNESS OBJECTS ETC. ESTABLISHED, OR WORK DONE TO PRESERVE EXISTING EVIDENCE

Attached signs 54-3 & 54-4 to BT's
Painted 6" Red band around trees

Work Done By D. Scott Title Surveyor Date 6/84 State Registration No. or Agency LS 1844
Certified Cor. Record Prepared? Yes No Filed At: Umatilla Co. Surveyor's Office Date

REMARKS

Index File No. T. 5S R. 33 1/2 E. W.M. Tract or Surv. No. Cor. L-01
GPO: 1982 O-382-659

USDA-FOREST SERVICE

Index
File No. L-25

CORNER RECORD (SEARCH)
(Ref. FSM 7151.4)

Tract or
Survey No. _____
Cor. No. L-25

T 5S R. 33 1/2 E

R.D. Ukiah County _____

Merid. WILLAMETTE

N.F. Umatilla State Oregon

CORNER DIAGRAM

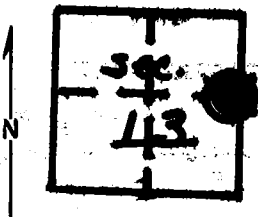

DESCRIBE CORNER MONUMENT FOUND

Material: None Size: none
Height Above Ground: none Condition: none
Markings: none

Brass Cap: see Monumentation File

DESCRIBE BEARING TREES OR OTHER OFFICIAL ACCESSORIES FOUND

18" P. pine in NW Quadrant blazed on SE face, scribed: 4 S
faded yellow metal poster 6"x8" on South side of tree.
14" P. pine in NE Quadrant blazed on SW face: no scribing
visible. There is old F.S. location poster on the tree
dated 12/20/52 ALW (possible BT) 6/13/66 WH

PHOTO IDENTIFICATION DATA

Photo No. _____
Filed At. _____
Object Ident. _____
Ident. By _____

Signature

PLANE COORDINATE POSITION DATA

State _____ Zone _____
X _____
Y _____
Estab. By _____

Agency

Signature _____

Title _____ Division _____ Headquarters _____
Eng. Tech.

Date

9/76

7100-52-(3/68)

CORNER RECORD (PERPETUATION)

MONUMENT : DESCRIBE NEW MONUMENT SET, OR WORK DONE TO PRESERVE EXISTING MONUMENT

9

ACCESSORIES : DESCRIBE NEW BY'S WITNESS OBJECTS ETC. ESTABLISHED, OR WORK DONE TO PRESERVE EXISTING EVIDENCE

10

Work Done By _____ Title _____ Date _____ State Registration No. or Agency _____

Certified Cor. Record Prepared ? Yes No Filed At _____ Date _____

REMARKS

12

Index File No. T. R. M. Tract or Surv. No. Cor. _____

13

Index File No. L-01

CORNER RECORD (SEARCH)

(Ref. FSM 7151.4)

Tract or Survey No. _____ Cor. No. _____

T SS R. ~~33E~~ 34E

R.D. LaGrande County Umatilla

Merid. W:11.

N.F. Willowa Whitman State Oregon

CORNER DIAGRAM

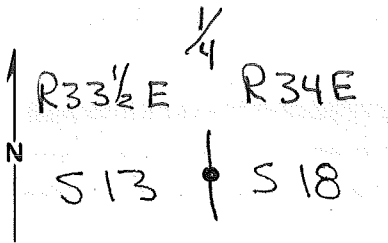

DESCRIBE CORNER MONUMENT FOUND

3 1/2" BLM BRASS CAP
Rising 14" on 2 1/2" Iron Pipe

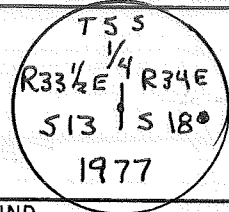

DESCRIBE BEARING TREES OR OTHER OFFICIAL ACCESSORIES FOUND

13" P. Pine S 73°E 34° Feet (1/4 S18 BT)
16" P. Pine N 18°W 52° Feet (1/4 S - Healed over)

PHOTO IDENTIFICATION DATA

Photo No. _____
Filed At. _____
Object Ident. _____
Ident. By _____
Signature

DESCRIBE CORNER LOCATION RELATIVE TO NEAR-BY FEATURES, ALSO HOW TO REACH CORNER

100 ft East of Dirt Track in Clearing
Reached From end of Road 5160-362

PLANE COORDINATE POSITION DATA

State _____ Zone _____
X _____
Y _____
Estab. By _____
Agency

Signature D. Scott

Title LS 1844 Division _____ Headquarters _____ Date 6/84

CORNER RECORD (PERPETUATION)

MONUMENT : DESCRIBE NEW MONUMENT SET, OR WORK DONE TO PRESERVE EXISTING MONUMENT

Raised Rock Mound around Cap
Placed Steel Fnc Post 4° Ft North with Sign 54-4

ACCESSORIES : DESCRIBE NEW BT's WITNESS OBJECTS ETC. ESTABLISHED, OR WORK DONE TO PRESERVE EXISTING EVIDENCE

Attached Sign's 54-3 + 54-4 to BT's
Painted 6" Red Band around Tree's

Work Done By D. Scott Title Surveyor Date 6/84 State Registration No. LS 1844
or Agency

Certified Cor. Record Prepared ? Yes No Filed At: UMATILLA CO. SURVEYOR'S OFFICE Date

REMARKS

Index File No.

T.55

R. ~~33EE~~ W.M.

Tract or Surv. No.

Cor.

L-01

34E

GPO : 1982 O-382-659

12

13

USDA-FOREST SERVICE

Index
File No. L-1

CORNER RECORD (SEARCH)

(Ref. FSM 7151.4)

Tract or
Survey No. _____ Cor. No. 2-1

T 5S R. 34E

R.D. Ukiah County _____

Merid. Willamette

N.F. Umatilla State Oregon

CORNER DIAGRAM

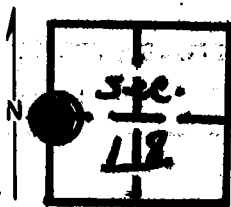

DESCRIBE CORNER MONUMENT FOUND

Material: none Size: none
Height Above Ground: none Condition: none
Markings: none

Brass Cap; see Monumentation File

DESCRIBE BEARING TREES OR OTHER OFFICIAL ACCESSORIES FOUND

Ref: T5S, R 331 1/2 E, L-25

PHOTO IDENTIFICATION DATA

Photo No. _____
Filed At. _____
Object Ident. _____
Ident. By _____

Signature

PLANE COORDINATE POSITION DATA

State _____ Zone _____
X _____
Y _____
Estab. By _____

Agency

Signature

Title

Division

Headquarters

Date

7100-52 (3/68)

CORNER RECORD (PERPETUATION)

MONUMENT: DESCRIBE NEW MONUMENT SET, OR WORK DONE TO PRESERVE EXISTING MONUMENT

ACCESSORIES : DESCRIBE NEW BT'S WITNESS OBJECTS ETC. ESTABLISHED, OR WORK DONE TO PRESERVE EXISTING EVIDENCE

Work Done By _____ Title _____ Date _____ State Registration No. or Agency _____

Certified Cor. Record Prepared ? Yes No Filed At: _____ Date _____

REMARKS

Index File No. T. R. M. Tract or Surv. No. Cor.