

USDA-FOREST SERVICE

Index
File No. F-24

CORNER RECORD (SEARCH)
(Ref. FSM 7151.4)

Tract or
Survey No. _____ No. F-24

T 5S R. 33½E R.D. Ukiah County Umatilla
Merid. Willamette N.F. Umatilla State Oregon

CORNER DIAGRAM

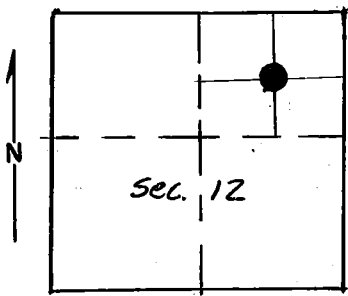

DESCRIBE CORNER MONUMENT FOUND

None

DESCRIBE BEARING TREES OR OTHER OFFICIAL ACCESSORIES FOUND

None

PHOTO IDENTIFICATION DATA

Photo No. _____
Filed At. _____
Object Ident. _____
Ident. By _____
Signature

DESCRIBE CORNER LOCATION RELATIVE TO NEAR-BY FEATURES, ALSO HOW TO REACH CORNER

From Frazier Guard Station, go East 0.75 miles on Road S552. Then walk Southeast across a clearing 26 chains to a fence corner. The corner is North of fence 21 feet.

PLANE COORDINATE POSITION DATA

State _____ Zone _____
X _____
Y _____
Estab. By _____
Agency

Signature
Terry C. Dumbay

Title _____ Division O.P.L.S. Headquarters 1638 Date 8/78 7100-52-(3/68)

CORNER RECORD (PERPETUATION)

MONUMENT: DESCRIBE NEW MONUMENT SET, OR WORK DONE TO PRESERVE EXISTING MONUMENT

Set $2\frac{1}{2}$ " x 30" iron pipe with brass cap.
 Pipe is 18" in ground with stone and earth
 mound raised to top of pipe.

Stamped:

T 5S R 33 $\frac{1}{2}$ E
 NE 1/16
 S 12
 1978
 PLS 933

9

ACCESSORIES : DESCRIBE NEW BT'S WITNESS OBJECTS ETC. ESTABLISHED, OR WORK DONE TO PRESERVE EXISTING EVIDENCE

Fir 9" diameter bears North $50^{\circ}48'$ East 20.50 feet with signs 54-3 and 54-4.
 Fir 12" diameter bears South $21^{\circ}07'$ East 24.55 feet with signs 54-3 and 54-4.

Set steel post 5 feet North with signs 54-2 and 54-4.
 Painted red band around trees.

10

Work Done By T. Hamby Title Surveyor Date 7/20/78 State Registration No. O.P.L.S. 1638
 or Agency

Certified Cor. Record Prepared? Yes No Filed At: Umatilla County Surveyor Date 8-8-88 11

REMARKS

Witness by Richard Barton and William Hampton.

12

Index File No. T. R. M. Tract or Surv. No. Cor.

13