

USDA-FOREST SERVICE

Index File No. F-20

CORNER RECORD (SEARCH)
(Ref. FSM 7151.4)

Tract or Survey No. _____ No. F-20

T 5S R. 33½E R.D. Ukiah County Umatilla

Merid. Willamette N.F. Umatilla State Oregon

CORNER DIAGRAM

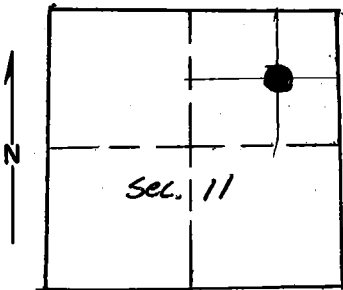

DESCRIBE CORNER MONUMENT FOUND

None

DESCRIBE BEARING TREES OR OTHER OFFICIAL ACCESSORIES FOUND

None

PHOTO IDENTIFICATION DATA

Photo No. _____

Filed At. _____

Object Ident. _____

Ident. By _____

Signature

PLANE COORDINATE POSITION DATA

State _____ Zone _____

X _____

Y _____

Estab. By _____

Agency

DESCRIBE CORNER LOCATION RELATIVE TO NEAR-BY FEATURES, ALSO HOW TO REACH CORNER

From Frazier Guard Station, go South $\frac{1}{4}$ mile on a dead end road to the East cabin. The corner is Southeast of cabin about 200 feet near a fence corner.

Signature

Terry C. Namby

Title

Division

O.P.L.S.

Headquarters

1638

Date

8/78

7100-52-(3/68)

5

CORNER RECORD (PERPETUATION)

MONUMENT: DESCRIBE NEW MONUMENT SET, OR WORK DONE TO PRESERVE EXISTING MONUMENT

T 5S R 33½E

Set 2½" x 30" iron pipe with brass cap.

NE 1/16 S 11

Pipe is 22" in ground with earth mound
around it to within 2" of top.1978
PLS 933

9

ACCESSORIES : DESCRIBE NEW BT'S WITNESS OBJECTS ETC. ESTABLISHED, OR WORK DONE TO PRESERVE EXISTING EVIDENCE

Fir 8" diameter bears South 01°39' West 32.00 feet with signs 54-3 & 54-4.

Fir 8" diameter bears South 30°18' West 5.85 feet with signs 54-3 & 54-4.

Set steel post 5 feet East with signs 54-2 & 54-4.
Painted red band around trees.

10

Work Done By. T. Hamby Title Surveyor Date 7/27/78 State Registration No. O.P.L.S. 1638
or AgencyCertified Cor. Record Prepared? Yes No Filed At: Umatilla County Surveyor Date 8-8-78 11

REMARKS

Witness by Richard Barton and William Hampton.

12

Index File No.

T.

R.

M.

Tract or Surv. No.

Cor.

13