

USDA-FOREST SERVICE

Index File No. D-18

CORNER RECORD (SEARCH)

(Ref. FSM 7151.4)

Tract or Survey No. _____ Cor. SW 1/16

T 5S R. 33 1/2E

R.D. Ukiah County Umatilla

Merid. Willamette

N.F. Umatilla State Oregon

CORNER DIAGRAM

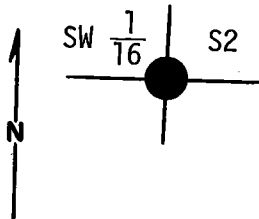

DESCRIBE CORNER MONUMENT FOUND

There was no corner originally set.

DESCRIBE BEARING TREES OR OTHER OFFICIAL ACCESSORIES FOUND

None set.

PHOTO IDENTIFICATION DATA

Photo No. _____

Filed At. _____

Object Ident. _____

Ident. By _____

Signature

PLANE COORDINATE POSITION DATA

State _____, Zone _____

X _____

Y _____

Estab. By _____

Agency

Signature

Howard L. [unclear]

Title

Division
ORLS

Headquarters
1294

Date
9-77

7100-52-(3/68)

CORNER RECORD (PERPETUATION)

MONUMENT: DESCRIBE NEW MONUMENT SET, OR WORK DONE TO PRESERVE EXISTING MONUMENT

At surveyed point set 2 1/2" X 30" galvanized pipe with brass cap stamped:

set pipe 22" in ground with mound of stone to cap.

T5S 33 1/2E

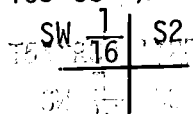

1980
OR PLS 1294

9

ACCESSORIES: DESCRIBE NEW BT'S WITNESS OBJECTS ETC. ESTABLISHED, OR WORK DONE TO PRESERVE EXISTING EVIDENCE

Bearing Trees:

A Tamarack 7" dia bears N88°E, 19.7 ft., scribed SW 1/16 S2 BT.

A Douglas Fir 10" dia. bears N71°W., 30.0 Ft., scribed SW 1/16 S2 BT.

Attached 54-3 & 54-4 signs to both BTs. Attached brass washer stamped LS1294 to New BTs. Painted blazes and 6" band around both BTs red. Attached 54-2 & 54-4 signs to metal post 6' west of corner. Attached 54-2 & 54-9 signs to metal fence post 6' north of corner.

10

Work Done By R. C. Orton Title Party Chief Date 6-27-80 State Registration No. or Agency _____

Certified Cor. Record Prepared? Yes No Filed At: _____ Date _____

11

REMARKS

Witnesses: R. Orton
G. Orton
D. Allen

12

Index File No. D-18 T. 55 R. 33 1/2E M. _____ Tract or Surv. No. _____ U.S. G.P.O. Cor. 1977-725-576/586 13