

CERTIFIED RECORD OF LAND CORNER MONUMENTATION

Index File No. D-13

History of original corner establishment:

No corner was originally set.

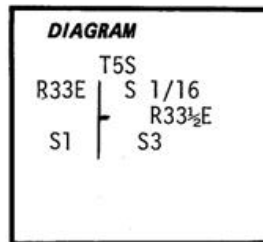

Description of corner evidence found:

Description of monument and accessories I established to perpetuate the original location of this corner:

At surveyed point set 2½"x30" galvanized pipe with brass cap stamped:

Set pipe 24" in ground with mound of stone to cap.

Bearing Trees:

- A Douglas Fir 7" dia., bears S37°E, 61.5 ft., scribed S 1/16 S3 BT.
- A Douglas Fir 16" dia., bears N7°E, 34.2 ft., scribed S 1/16 S3 BT.

Attached 54-3 and 54-4 signs to both BTs. Attached brass washer stamped LS 1294 to foot blaze of both BTs. Painted blazes and 6" band around both BTs Red. Attached 54-2 and 54-4 signs to metal post 5 ft. South of corner. Attached 54-2 and 54-9 signs to metal post 5 ft. East of corner.

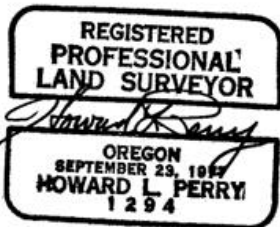

I hereby certify the above corner monument was established as herein described on July 8, 1980.

Witnesses: R. Orton, D. Allen, L. Huntsman

Office of..... County Surveyor..... County of..... Umatilla
 Oregon....., I hereby certify that the within instrument was filed in this office
 for record on the..... day of *December*, 19.80.
 *David Humber* by *Betty Shatto*
 (COUNTY OFFICIAL) (DEPUTY)

R-187-B