

USDA-FOREST SERVICE

Index

File No. Z-15

CORNER RECORD (SEARCH)

(Ref. FSM 7151.4)

Tract or

Survey No. S34

Cor.

No. S1SC

T 5S R. 33E

R.D. Ukiah

County Umatilla

Merid. Willamette

N.F. Umatilla

State Oregon

CORNER DIAGRAM

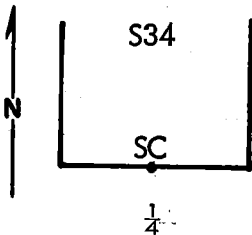

DESCRIBE CORNER MONUMENT FOUND

Found 14"x12"x5" loose granite stone marked "1/4".

DESCRIBE BEARING TREES OR OTHER OFFICIAL ACCESSORIES FOUND

A 38" Ponderosa Pine stump, 18 inches high bears North 9.2 feet. The scribing has weathered off the blaze on the south side of tree. Ring count to blaze indicate blaze was made near time of original survey.

PHOTO IDENTIFICATION DATA

Photo No. _____

Filed At. _____

Object Ident. _____

Ident. By _____

Signature

PLANE COORDINATE POSITION DATA

State _____ Zone _____

X _____

Y _____

Estab. By _____

Agency

DESCRIBE CORNER LOCATION RELATIVE TO NEAR-BY FEATURES, ALSO HOW TO REACH CORNER

From the location poster on the east side of the road that runs South of the Neeves Creek Canyon, the corner is 1300 ft ± East. An old west fence (down) is located North of corner.

Signature

William R. Wells

Title

PLS

Division

Headquarters

Date

11-20-79

7100-52-(3/68)

CORNER RECORD (PERPETUATION)

MONUMENT: DESCRIBE NEW MONUMENT SET, OR WORK DONE TO PRESERVE EXISTING MONUMENT

At the corner position a 2 inch by 30 inch iron pipe with brass cap marked: was set 22 inches in the ground and surrounded with a mound of earth. Buried original stone below ground beside new monument. Set steel fence post west of corner and attached sign 54-4.

T5S R33E
SC
1/4S34
1979
PLS 1106

ACCESSORIES: DESCRIBE NEW BT'S WITNESS OBJECTS ETC. ESTABLISHED, OR WORK DONE TO PRESERVE EXISTING EVIDENCE

Established 2 new BT's:

A 13" Tamarack bears N72 $\frac{1}{2}$ °W 53.9 ft. scribed $\frac{1}{4}$ S 34SC BT

A 18" Tamarack bears N24 $\frac{1}{2}$ °E 63.5 ft scribed $\frac{1}{4}$ S 34 SC BT

New BT's have a lower blaze scribed BT with a brass washer stamped PLS 1106 nailed flush. Attached signs 54-3 and 54-4 to all BT's and painted red ring around the trees above upper blaze.

Work Done By William R. Wells Title PLS Date 11/20/78 State Registration No. 1106
or Agency

Certified Cor. Record Prepared? Yes No Filed At: Umatilla County Surveyor's Office Date _____

REMARKS

Witness: Clint Kelly

USDA-FOREST SERVICE

Index

File No. Z-15

CORNER RECORD (SEARCH)

(Ref. FSM 7151.4)

Tract or Survey No. _____ Cor. No. Z-15

T 5 S R. 33 E

R.D. Ukiah County _____

Merid. Will.

N.F. Umatilla State Oregon

CORNER DIAGRAM

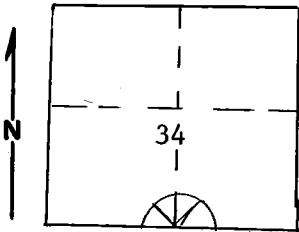

DESCRIBE CORNER MONUMENT FOUND

Material: Granite stone, Size: 14" x 12" x 5"
 loose
 Markings: None visible

DESCRIBE BEARING TREES OR OTHER OFFICIAL ACCESSORIES FOUND

34" dia. pine stump 18" high with portion of lower South blazed. No visible scribing. Old E-W fence North of stump.

PHOTO IDENTIFICATION DATA

Photo No. _____

Filed At. _____

Object Ident. _____

Ident. By _____

Signature

PLANE COORDINATE POSITION DATA

State _____ Zone _____

X _____

Y _____

Estab. By _____

Agency

Signature
 Bill Moore

Title _____ Division _____ Headquarters _____

Date 8-27-79 7100-52-(3/68)

CORNER RECORD (PERPETUATION)

MONUMENT : DESCRIBE NEW MONUMENT SET, OR WORK DONE TO PRESERVE EXISTING MONUMENT

ACCESSORIES : DESCRIBE NEW BT'S WITNESS OBJECTS ETC. ESTABLISHED, OR WORK DONE TO PRESERVE EXISTING EVIDENCE

Work Done By _____ Title _____ Date _____ State Registration No. or Agency _____

Certified Cor. Record Prepared ? Yes No Filed At: _____ Date _____

REMARKS

Index File No. T. R. M. Tract or Surv. No. Cor. _____