

Index
File No. P-9

CORNER RECORD (SEARCH)

(Ref. FSM 7151.4)

Tract or Survey No. _____ Cor. No. 1/4

T 55 R. 33E

R.D. Ukiah County Umatilla

Merid. Willamette

N.F. Umatilla State Oregon

CORNER DIAGRAM

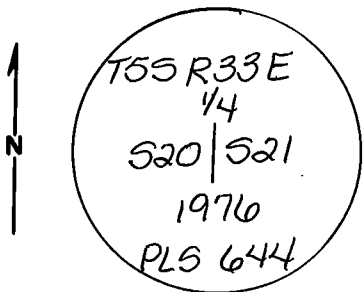

DESCRIBE CORNER MONUMENT FOUND

Found 2 1/2" dia. Brass cap in stone mound facing South

DESCRIBE BEARING TREES OR OTHER OFFICIAL ACCESSORIES FOUND

A 20" Ponderosa Pine bears N34°E, 81.4 feet
A 12" Ponderosa Pine bears S67°W, 71 links
Steel fence post with sign # 54-4 by corner

PHOTO IDENTIFICATION DATA

Photo No. _____
Filed At. _____
Object Ident. _____
Ident. By _____
Signature

PLANE COORDINATE POSITION DATA

State _____ Zone _____
X _____
Y _____
Estab. By _____
Agency

DESCRIBE CORNER LOCATION RELATIVE TO NEAR-BY FEATURES, ALSO HOW TO REACH CORNER

Fence corner is East 3 feet and South 3 feet
Fence runs North and East

Signature
David H. Klein

Title
PLS 933

Division

Headquarters

Date
7/16/84

CORNER RECORD (PERPETUATION)

MONUMENT: DESCRIBE NEW MONUMENT SET, OR WORK DONE TO PRESERVE EXISTING MONUMENT

None

ACCESSORIES : DESCRIBE NEW BT'S WITNESS OBJECTS ETC. ESTABLISHED, OR WORK DONE TO PRESERVE EXISTING EVIDENCE

None

Work Done By R PUNCHES Title Party Chief Date 7/9/84 State Registration No. or Agency _____

Certified Cor. Record Prepared? Yes No Filed At: _____ Date _____

REMARKS

Index File No. P-9 T. 55 R. 33E M. W Tract or Surv. No. _____ Cor. 1/4

Index
File No. P-9

CORNER RECORD (SEARCH)
(Ref. FSM 7151.4)

Tract or Survey No. _____
Cor. No. P-9

T 55 R. 33E R.D. UKIAH County UMATILLA
Merid. _____ N.F. UMATILLA State OREGON

CORNER DIAGRAM

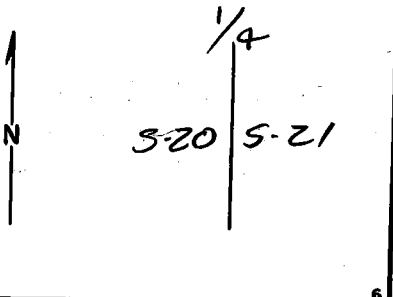

DESCRIBE CORNER MONUMENT FOUND 1

STONE CALL SIZE

DESCRIBE BEARING TREES OR OTHER OFFICIAL ACCESSORIES FOUND 2

FND SW BT SCRIBES VISIBLE

PHOTO IDENTIFICATION DATA

Photo No. _____
Filed At. _____
Object Ident. _____
Ident. By _____
Signature _____ 7

DESCRIBE CORNER LOCATION RELATIVE TO NEAR-BY FEATURES, ALSO HOW TO REACH CORNER 3

PLANE COORDINATE POSITION DATA

State _____ Zone _____
X _____
Y _____
Estab. By _____
Agency _____ 8

Signature
[Signature]

Title SUR. Division _____ Headquarters _____ Date 10/76 4
7100-52-(3/68) 5

CORNER RECORD (PERPETUATION)

MONUMENT: DESCRIBE NEW MONUMENT SET, OR WORK DONE TO PRESERVE EXISTING MONUMENT

SET 2 1/2" X 30" IRON PIPE WITH BRASS CAP

ACCESSORIES: DESCRIBE NEW BT'S WITNESS OBJECTS ETC. ESTABLISHED, OR WORK DONE TO PRESERVE EXISTING EVIDENCE

ORIGINAL BT

A 18" P. PINE, S67W, 46.9 FT SCRIBES VISIBLE
NEW BT

A 26" P. PINE N34 E, 81.4 FT

Work Done By D. J. GRIFFITH Title SURVEYOR Date 1/76 State Registration No. ONE, PLS. 644
or Agency

Certified Cor. Record Prepared? Yes No Filed At: UMATILLA Co. CT. HOUSE Date 1/77

REMARKS

Index File No. T. 55 R. 33 E WM. Tract or Surv. No. Cor. P-9

P-9

P-9