

USDA-FOREST SERVICE

Index
File No. P-13
T 55 R. 33E
Merid. Willamette

CORNER RECORD (SEARCH)
(Ref. FSM 7151.4)

Tract or Survey No. _____
Cor. No. 1/4
R.D. Ukiah County Umatilla
N.F. Umatilla State Oregon

CORNER DIAGRAM

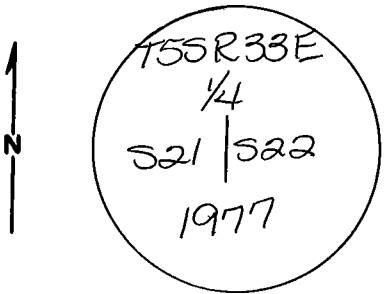

DESCRIBE CORNER MONUMENT FOUND

A 2 1/2" dia Brass Cap set by BLM

DESCRIBE BEARING TREES OR OTHER OFFICIAL ACCESSORIES FOUND

A 7" Lodgepole pine bears S80°E, 351KS
A 8" Lodgepole pine bears N39°W, 511KS
Scribing is visible on both trees
Trees have signs #54-4 & 54-3

DESCRIBE CORNER LOCATION RELATIVE TO NEAR-BY FEATURES, ALSO HOW TO REACH CORNER

From Highway 244 go South on Road 54
3.5 miles to location poster on left,
corner is South 300 ft

PHOTO IDENTIFICATION DATA

Photo No. _____
Filed At. _____
Object Ident. _____
Ident. By _____
Signature

PLANE COORDINATE POSITION DATA

State _____ Zone _____
X _____
Y _____
Estab. By _____
Agency

Signature David H Klein Title PLS 933 Division _____ Headquarters _____ Date 7/16/84
7100-52-(3/68)

CORNER RECORD (PERPETUATION)

MONUMENT : DESCRIBE NEW MONUMENT SET, OR WORK DONE TO PRESERVE EXISTING MONUMENT

Alone

ACCESSORIES : DESCRIBE NEW BT'S WITNESS OBJECTS ETC. ESTABLISHED, OR WORK DONE TO PRESERVE EXISTING EVIDENCE

Painted Trees

Work Done By R Panches Title Party Chief Date 7/9/84 State Registration No. or Agency _____

Certified Cor. Record Prepared ? Yes No Filed At: _____ Date _____

REMARKS

Index File No. P-13 T 55 R 33E M. W

Tract or Surv. No.

Cor. 44