

CERTIFIED RECORD OF LAND CORNER MONUMENTATION

Index File No. K-25

History of original corner establishment:

No corner was originally set.

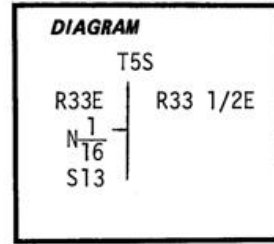

Description of corner evidence found:

Description of monument and accessories I established to perpetuate the

original location of this corner: At surveyed point set
2 1/2"X30" galvanized pipe with brass cap stamped:
Set pipe 24" in ground with mound of stone to cap.

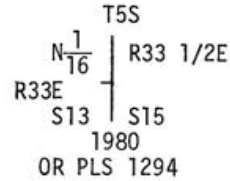

Bearing Trees:

A White Fir 14" dia. bears N69°W, 24.5 ft., scribed N1/16 S13 BT.
A White Fir 12" dia. bears S33°W, 23.5 ft., scribed N1/16 S13 BT.

Attached 54-3 & 54-4 signs to both BTs. Attached brass washer stamped LS 1294 to foot blaze of both BTs. Painted blazes and 6" band around both BTs red. Attached 54-2 & 54-4 signs to metal post 5 ft west of corner. Attached 54-2 & 54-9 signs to metal post 5 ft north of corner.

I hereby certify the above corner monument was established as herein described on July 9, 1980.

Witnesses: R. Orton
L. Huntsman
D. Allen

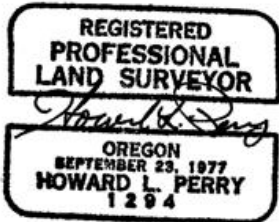

Office of..... County Surveyor..... County of..... Umatilla
 Oregon....., I hereby certify that the within instrument was filed in this office
 for record on the..... day of..... December....., 19.....⁸⁰
 by.....
 (COUNTY OFFICIAL) (DEPUTY)