

USDA-FOREST SERVICE

Index
File No. K-24

T 5S R. 33E

Merid. Willamette

CORNER RECORD (SEARCH)

(Ref. FSM 7151.4)

R.D. Ukiah County Umatilla

N.F. Umatilla State Oregon

Tract or
Survey No. _____
Cor. No. NE 1/16

CORNER DIAGRAM

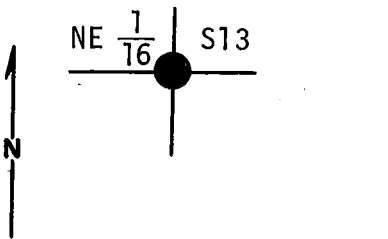

DESCRIBE CORNER MONUMENT FOUND

None Set

DESCRIBE BEARING TREES OR OTHER OFFICIAL ACCESSORIES FOUND

None Set

PHOTO IDENTIFICATION DATA

Photo No. _____

Filed At. _____

Object Ident. _____

Ident. By _____

Signature

PLANE COORDINATE POSITION DATA

State _____ Zone _____

X _____

Y _____

Estab. By _____

Agency

DESCRIBE CORNER LOCATION RELATIVE TO NEAR-BY FEATURES, ALSO HOW TO REACH CORNER

Corner falls 80 ft. North of un-numbered dirt road bearing S.E. off of USFS Rd. No. 5160-410. Location tag on S.W. side of Road.

Signature
Howard A. [unclear]

Title

Division
ORLS

Headquarters
1294

Date
9-77

7100-52-(3/68)

CORNER RECORD (PERPETUATION)

MONUMENT: DESCRIBE NEW MONUMENT SET, OR WORK DONE TO PRESERVE EXISTING MONUMENT

At surveyed point set 2 1/2"X30" galvanized pipe with brass cap stamped:

Set pipe 24" in ground with mound of stone to paper.

T5S R33E
 NE 1/16 S13
 1980
 OR PLS 1294

ACCESSORIES: DESCRIBE NEW BT'S WITNESS OBJECTS ETC. ESTABLISHED, OR WORK DONE TO PRESERVE EXISTING EVIDENCE

Bearing Trees:

A White Fir 6" dia bears N22⁰W, 12.7 ft., scribed NE1/16 S13 BT.

A White Fir 6" dia bears S33⁰W, 20.7 ft., scribed NE1/16 S13 BT.

Attached 54-3 & 54-4 signs to both BTs. Attached brass washer stamped LS 1294 to foot blaze of both BTs. Painted blazes and 6" band around both BTs Red. Attached 54-2 & 54-4 signs to metal post 5 ft north of corner. Attached 54-2 & 54-9 signs to metal post 5 ft east of corner.

Work Done By: R. C. Orton Title Party Chief Date 7-9-80 State Registration No. or Agency _____

Certified Cor. Record Prepared? (Yes) No Filed At: _____ Date _____

REMARKS

Witnesses: R. Orton
 L. Huntsman
 D. Allen

Index File No. T. R. M. Tract or Surv. No. Cor. U.S. G.P.O. 1977-725-576/586

K-24 5S 33E