

USDA-FOREST SERVICE

Index
File No. 55 T-4
T 5S R. 3TE
Merid. Willamette

CORNER RECORD (SEARCH)

(Ref. FSM 7151.4)

R.D. Ukiah County Umatilla Tract or Survey No. Sec 30
N.F. Umatilla State Oregon Cor No. CE 1/16

CORNER DIAGRAM

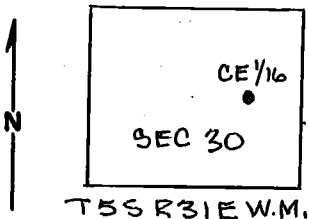

DESCRIBE CORNER MONUMENT FOUND

None

DESCRIBE BEARING TREES OR OTHER OFFICIAL ACCESSORIES FOUND

None

PHOTO IDENTIFICATION DATA

Photo No. _____
Filed At. _____
Object Ident. _____
Ident. By _____
Signature

PLANE COORDINATE POSITION DATA

State _____ Zone _____
X _____
Y _____
Estab. By _____
Agency

DESCRIBE CORNER LOCATION RELATIVE TO NEAR-BY FEATURES, ALSO HOW TO REACH CORNER

From the intersection of Hwys. 395 & 244 drive South .6 miles approximately and turn right on gravel road follow road 2 miles+ to fork and take left hand fork. Continue along left hand fork 3.5 miles approximately to location marker on West side of road. Corner is 300'+ West of location poster.

Signature

William R. Wells

Title
PLS 1106

Division

Headquarters

Date
8/20/79

7100-52-(3/68)

CORNER RECORD (PERPETUATION)

MONUMENT: DESCRIBE NEW MONUMENT SET, OR WORK DONE TO PRESERVE EXISTING MONUMENT

Set 2" x 30" galvanized iron pipe with a brass cap 2 1/2 inches
 in ground with a mound of stones to the top, marked: T 55 R 31 E
 Set steel fence post on line South of corner and
 attached signs 54-2 and 54-9.
 C $\frac{E 1/16}{S 30}$ C
 1979
 PLS 1106

9

ACCESSORIES: DESCRIBE NEW BT'S WITNESS OBJECTS ETC. ESTABLISHED, OR WORK DONE TO PRESERVE EXISTING EVIDENCE

A 13" bull pine bears S75°E 114.5 ft. to center marked CE 1/16 S 30 BT.
 A 13 1/2" bull pine bears S52 1/2°E 91.3 ft. to center marked CE 1/16 S 30 BT.
 BT's have a lower blaze scribed BT with a brass washer stamped PLS 1106 nailed flush. Attached
 signs 54-3 and 54-4 and painted red ring around BT's.

10

Work Done By William R. Wells Title PLS Date 8/20/79 State Registration No. 1106
 or Agency
 Certified Cor. Record Prepared? Yes^X No Filed At Umatilla County Surveyor's Office Date _____

11

REMARKS

Witnesses: Greg Flowers L.S.I.T.
 Brent Reynolds

12

Index File No.	T.	R.	M.	Tract or Surv. No.	Sec 30	Cor.	CE 1/16
T-4	5S	31E	Willamette				13
							U.S. G.P.O. 1977-725-576/586