

USDA-FOREST SERVICE

Index
File No. Z-3

CORNER RECORD (SEARCH)
(Ref. FSM 7151.4)

Tract or
Survey No. _____
Cor. 1/4 Cor

T 5S R. 30E

R.D. Ukiah County Umatilla

Merid. Willamette

N.F. Umatilla State Oregon

CORNER DIAGRAM

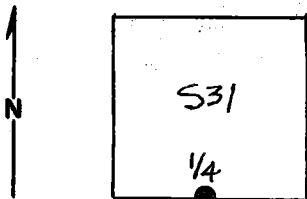

DESCRIBE CORNER MONUMENT FOUND
Stone 22 X 11 X 10 Marked: $\frac{1}{4}$

DESCRIBE BEARING TREES OR OTHER OFFICIAL ACCESSORIES FOUND
None

PHOTO IDENTIFICATION DATA

Photo No. _____
Filed At. _____
Object Ident. _____
Ident. By _____
Signature

DESCRIBE CORNER LOCATION RELATIVE TO NEAR-BY FEATURES, ALSO HOW TO REACH CORNER

Corner is approximately 1,300' East of U.S.F.S. Road # 5327.
Location tag on East side of Road.

PLANE COORDINATE POSITION DATA

State _____ Zone _____
X _____
Y _____
Estab. By *[Signature]*
Agency

Signature

Title

PLS
Division

346
Headquarters

9-79
Date

7100-52-(3/68)

CORNER RECORD (PERPETUATION)

MONUMENT: DESCRIBE NEW MONUMENT SET, OR WORK DONE TO PRESERVE EXISTING MONUMENT

Set 32" X 2" flanged iron pipe with brass cap marked:
Buried original stone along side.

SC
T5S R30E
1/4 S31
1979
PLS 346

9

ACCESSORIES: DESCRIBE NEW BT'S WITNESS OBJECTS ETC. ESTABLISHED, OR WORK DONE TO PRESERVE EXISTING EVIDENCE

Douglas Fir, 12" Dia., BRS. N13° E., 31.8 Ft. Distance.
Ponderosa Pine, 11" Dia., BRS. N58 3/4° E., 33.2 Ft. Distance.
6' Iron Fence Post with "Attention" sign within 5' of Corner.

10

Work Done By: Wayne O. Harris Title: PLS Date: 9/79 State Registration No. or Agency: 346

Certified Cor. Record Prepared? YES NO Filed At: Umatilla Co. Surveyor Office Date: _____

11

REMARKS

Index File No. Z-3 T5S R.30E W.M. Tract or Surv. No. _____ Cor. 1/4 S31 13
U.S. G.P.O. 1977-725-576/586

12

USDA-FOREST SERVICE

Index
File No. Z-3

CORNER RECORD (SEARCH)

(Ref. FSM 7151.4)

Tract or
Survey No. _____ No. _____

T 5 S R. 30E

R.D. Ukiah County _____

Merid. Willamette

N.F. Umatilla State Oregon

CORNER DIAGRAM

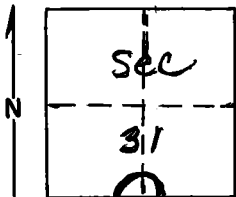

DESCRIBE CORNER MONUMENT FOUND

Material: None

2

DESCRIBE BEARING TREES OR OTHER OFFICIAL ACCESSORIES FOUND

None. East-west fence only. area has been heavily logged.

6

PHOTO IDENTIFICATION DATA

Photo No. _____

Filed At. _____

Object Ident. _____

Ident. By _____

Signature

7

PLANE COORDINATE POSITION DATA

State _____ Zone _____

X _____

Y _____

Estab. By _____

Agency

8

DESCRIBE CORNER LOCATION RELATIVE TO NEAR-BY FEATURES, ALSO HOW TO REACH CORNER

3

Signature

T. Hollamon, Engr, Tech.

Title

Division

Headquarters

Date

8-30-78

7100-52-(3/68)

4

5

CORNER RECORD (PERPETUATION)

GPO 902-673

MONUMENT : DESCRIBE NEW MONUMENT SET, OR WORK DONE TO PRESERVE EXISTING MONUMENT

9

ACCESSORIES : DESCRIBE NEW BT's WITNESS OBJECTS ETC. ESTABLISHED, OR WORK DONE TO PRESERVE EXISTING EVIDENCE

10

Work Done By _____ Title _____ Date _____ State Registration No. or Agency _____

Certified Cor. Record Prepared ? Yes No Filed At: _____ Date _____

11

REMARKS

12

Index File No. T. R. M. Tract or Surv. No. Cor. _____

13