

Index File No. J-7
 T 5 S. R. 30 E.
 Merid. Willamette

CORNER RECORD (SEARCH)

(Ref. FSM 7151.4)

Tract or Survey No. _____ Cor. No. _____

R.D. Ukiah County Umatilla
 N.F. Umatilla State Oregon

CORNER DIAGRAM

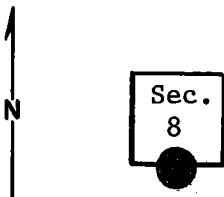

DESCRIBE CORNER MONUMENT FOUND

Basalt stone, 15" x 12" x 4", 2" above ground, good condition.
 (Fits GLO Notes)

No visible markings.

Monumented by BLM in 1978

DESCRIBE BEARING TREES OR OTHER OFFICIAL ACCESSORIES FOUND

A 32" p. pine bears S. 80°E., approx. 18 ft. Scribing faintly visible (Can read S.) It has an X mark 5' above scribing. It has 9" sucker snag growing from base. Snag has sale boundary poster on it.

No evidence of other B.T.

PHOTO IDENTIFICATION DATA

Photo No. _____
 Filed At. _____
 Object Ident. _____
 Ident. By _____
Signature

PLANE COORDINATE POSITION DATA

State _____ Zone _____
 X _____
 Y _____
 Estab. By _____
Agency

DESCRIBE CORNER LOCATION RELATIVE TO NEAR-BY FEATURES, ALSO HOW TO REACH CORNER

Assumed $\frac{1}{4}$ corner sets about 60 ft. NE of small stream, and about 12 ft. north of top of cutbank of old logging spur road. Also about 300 ft. south of a pit-run gravelled logging road.

Signature

T. Hollamon

Title

Eng. Tech.

Division

Headquarters

S.O.

Date

5/2/74

7100-52-(3/68)

CORNER RECORD (PERPETUATION)

MONUMENT: DESCRIBE NEW MONUMENT SET, OR WORK DONE TO PRESERVE EXISTING MONUMENT

ACCESSORIES : DESCRIBE NEW BT's WITNESS OBJECTS ETC. ESTABLISHED, OR WORK DONE TO PRESERVE EXISTING EVIDENCE

I placed a blank B.T. poster on the B.T. I also placed a location poster on a 10" Douglas-fir approx. 12 ft. north of road, approx. 300 ft. north of $\frac{1}{4}$ corner.

Work Done By _____ Title _____ Date _____ State Registration No. or Agency _____

Certified Cor. Record Prepared ? Yes No Filed At: _____ Date _____

REMARKS

Index File No. T. R. M. Tract or Surv. No. Cor.