

CERTIFIED RECORD OF LAND CORNER MONUMENTATION

Index File No. H-10

History of original corner establishment:

No corner was originally set.

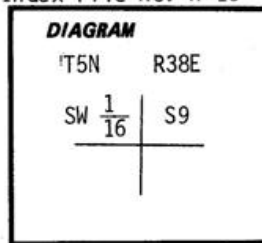

Description of corner evidence found:

Description of monument and accessories established to perpetuate the original location of this corner:

At surveyed point set 1"x30" galvanized pipe with 3" brass cap stamped:

Set pipe 24" in ground with mound of stones to cap.

From which:

A white Fir 6" dia. bears S57°E 9.8 ft. scribed: SW 1/16 S9 BT.
 A white Fir 8" dia. bears N40°E 23.6 ft. scribed SW 1/16 S9 BT.
 Attached 54-3 & 54-4 signs to both BT's. Attached brass washers stamped LS 1294 to foot blaze of both BT's. Painted blazes and 6" band around both BT's, red.

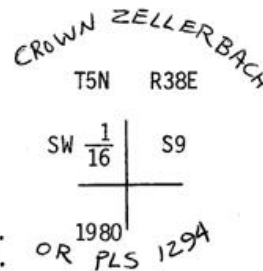

I hereby certify the above corner monument was established as herein described on Oct. 9, 1980.



Witnesses: R. Orton
 G. Wagoner
 M. Wyatt
 A. Hanley

Office of..... County Surveyor..... County of..... Umatilla
 State of..... Oregon....., I hereby certify that the within instrument was filed in this office
 for record on the..... day of..... December..... 1980
 by..... Betty Shatto..... (DEPUTY)