

USDA-FOREST SERVICE

Index
File No. A-25 R38E

CORNER RECORD (SEARCH)

(Ref. FSM 7151.4)

Tract or
Survey No. _____

Cor.
No. _____

T 5 N ~~W~~ R. ~~38E~~

R.D. Walla Walla County Umatilla

Merid. Willamette

N.F. Umatilla State Oregon

CORNER DIAGRAM

DESCRIBE CORNER MONUMENT FOUND

Found 3" G.L.O. brass cap set 1932.

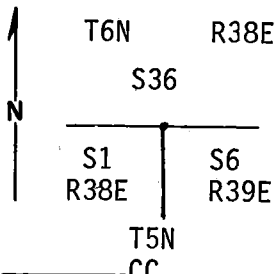

DESCRIBE BEARING TREES OR OTHER OFFICIAL ACCESSORIES FOUND

- 1) 14" fir scribed; 54-3 sign, N 63 E 54½ lks, T 5N R 38E Sec. 1, RJ 9/91
- 2) Dead Western Larch scribed T5N, R39E, Sec.6

PHOTO IDENTIFICATION DATA

Photo No. _____
Filed At. _____
Object Ident. _____
Ident. By _____
Signature

DESCRIBE CORNER LOCATION RELATIVE TO NEAR-BY FEATURES, ALSO HOW TO REACH CORNER

Travel east on road 65 100 ft from intersection with Road 40 then head west ¼ mile.

PLANE COORDINATE POSITION DATA

State _____ Zone _____
X _____
Y _____
Estab. By _____
Agency

Signature

Title

Division

Headquarters

Date

FS-7100-52 (3/68)

CORNER RECORD (PERPETUATION)

MONUMENT: DESCRIBE NEW MONUMENT SET, OR WORK DONE TO PRESERVE EXISTING MONUMENT

ACCESSORIES : DESCRIBE NEW BT'S WITNESS OBJECTS ETC. ESTABLISHED, OR WORK DONE TO PRESERVE EXISTING EVIDENCE

- 1) 14" western Larch, scribed T6N R38E S36, 54-3 sign reads S 9½ W 29.2' 6/92 PLS 2360
- 2) 15" Western Larch, scribed T5N R39 E S 6, 54-3 sign reads N 53¾ W 68.8' 6/92
PLS 2360

Both trees have red stripe and 54-G.

Work Done By P. Tomkins Title PLS Date 7/92 State Registration No. OR 2360
or Agency
Certified Cor. Record Prepared ? (Yes) No Filed At: _____ Date _____

REMARKS

Index File No. A 25 T. 5N R. 38E M. W.M. Tract or Surv. No. _____ Cor. _____

USDA-FOREST SERVICE

Index
File No. A-25

CORNER RECORD (SEARCH)

(Ref. FSM 7151.4)

Tract or
Survey No. _____
Cor.
No. _____

T 5N R. 38E R.D. WALLA WALLA County UMATILLA
Merid. WILLAMETTE N.F. UMATILLA State OREGON

CORNER DIAGRAM

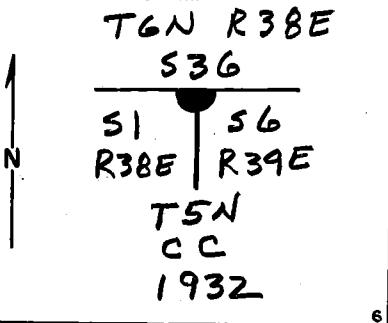

DESCRIBE CORNER MONUMENT FOUND

BRASS CAPPED IRON PIPE FOUND BY BLM

DESCRIBE BEARING TREES OR OTHER OFFICIAL ACCESSORIES FOUND

PHOTO IDENTIFICATION DATA

Photo No. _____
Filed At. _____
Object Ident. _____
Ident. By _____
Signature

DESCRIBE CORNER LOCATION RELATIVE TO NEAR-BY FEATURES, ALSO HOW TO REACH CORNER

PLANE COORDINATE POSITION DATA

State _____ Zone _____
X _____
Y _____
Estab. By _____
Agency

Signature

Title

Division

Headquarters

Date

1990

FS-7100-52 (3/68)

5

CORNER RECORD (PERPETUATION)

MONUMENT : DESCRIBE NEW MONUMENT SET, OR WORK DONE TO PRESERVE EXISTING MONUMENT

ACCESSORIES : DESCRIBE NEW BT's WITNESS OBJECTS ETC. ESTABLISHED, OR WORK DONE TO PRESERVE EXISTING EVIDENCE

9

10

Work Done By _____ Title _____ Date _____ State Registration No. or Agency _____

Certified Cor. Record Prepared ? Yes No Filed At: _____ Date _____

11

REMARKS

12

Index File No. T. R. S.M. Tract or Surv. No. Cor. _____

13

USDA-FOREST SERVICE

Index

File No. A-25

T 5N R 38E

Merid. Will

CORNER RECORD (SEARCH)

(Ref. FSM 7351.4)

Tract or Survey No. _____

Cor. No. _____

R.D. Walla Walla County Umatilla

N.F. Umatilla State Oregon

CORNER DIAGRAM

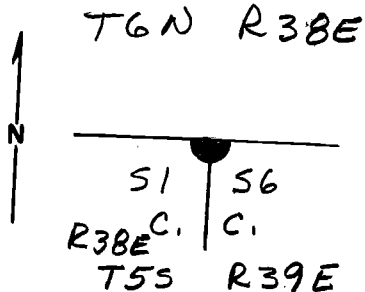

DESCRIBE CORNER MONUMENT FOUND

Did not find Brass cap due to 3' snow pack. - Probably in place. (Brass cap found in place, 5-83 D. GAYLORD)

DESCRIBE BEARING TREES OR OTHER OFFICIAL ACCESSORIES FOUND

14" Spruce tree bears 55°E, 29.7 ft w/ visible scribing on unhealed Blaze. 16" fir is down & has a healed Blaze. Root hole bears 59°W, 26.4 ft.

DESCRIBE CORNER LOCATION RELATIVE TO NEAR-BY FEATURES, ALSO HOW TO REACH CORNER

PHOTO IDENTIFICATION DATA

Photo No. _____

Filed At. _____

Object Ident. _____

Ident. By _____

Signature

PLANE COORDINATE POSITION DATA

State _____ Zone _____

X _____

Y _____

Estab. By _____

Agency

Signature

Title

Division

Headquarters

Date

Dennis P. Gaylord

PLS 1636

3-18-81

7100-52-(3/68)

4

5

CORNER RECORD (PERPETUATION)

MONUMENT: DESCRIBE NEW MONUMENT SET, OR WORK DONE TO PRESERVE EXISTING MONUMENT

ACCESSORIES : DESCRIBE NEW BT'S WITNESS OBJECTS ETC. ESTABLISHED, OR WORK DONE TO PRESERVE EXISTING EVIDENCE

Work Done By _____ Title _____ Date _____ State Registration No. or Agency _____ 10

Certified Cor. Record Prepared? Yes No Filed At: _____ Date _____ 11

REMARKS

Index File No. T. R. M. Tract or Surv. No. Cor. 12 13

Index
File No. A-25 CORNER RECORD (SEARCH) (Ref. FSM 7151.4) Tract or Survey No. _____ Cor. Sec. and No. 1
T 5 N. R. 38 E. R.D. Walla Walla County Umatilla
Merid. WM N.F. Umatilla State Oregon

CORNER DIAGRAM

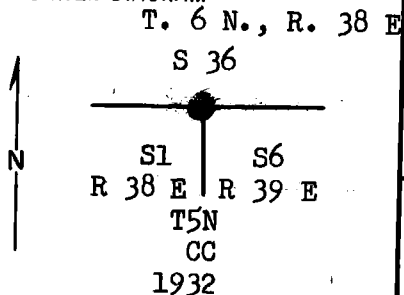

DESCRIBE CORNER MONUMENT FOUND

3" Iron pipe with brass cap marked as shown in the corner diagram.

Cross referenced T 5 N., R. 39 E. A-1

DESCRIBE BEARING TREES OR OTHER OFFICIAL ACCESSORIES FOUND

14" Dia. fir bears S. 10° E, 30 ft. dist. placed BT signs and marked with paint.

8" Dia. stump 2 ft. high bears S. 10° W. placed BT signs and marked with paint.

DESCRIBE CORNER LOCATION RELATIVE TO NEAR-BY FEATURES, ALSO HOW TO REACH CORNER

Corner lays on gentle S. E. slope wooded.

This corner is a corner only to Section 1 of T. 5 N., R. 38 E. and Section 6 of T. 5 N., R. 39 E.

PHOTO IDENTIFICATION DATA

Photo No. _____
Filed At. _____
Object Ident. _____
Ident. By _____

Signature

PLANE COORDINATE POSITION DATA

State _____ Zone _____
X _____
Y _____
Estab. By _____

Agency

Signature
D. B. Baker

Title
Eng. Tech.

Division
Engr.

Headquarters
Walla Walla

Date
9-5-63

7100-52 (3/68)

CORNER RECORD (PERPETUATION)

MONUMENT : DESCRIBE NEW MONUMENT SET, OR WORK DONE TO PRESERVE EXISTING MONUMENT

ACCESSORIES : DESCRIBE NEW BT'S WITNESS OBJECTS ETC. ESTABLISHED, OR WORK DONE TO PRESERVE EXISTING EVIDENCE

Work Done By _____ Title _____ Date _____ State Registration No. or Agency _____
Certified Cor. Record Prepared ? Yes No Filed At: _____ Date _____

REMARKS

Index File No. A-25 T. R. M. Tract or Surv. No. Cor. _____

LAND CORNER RECORD

LL / 5680-2

1. T. 5N - R. 38E No. A-25 Cor. Sec. Mer. Will State Oregon N. F. Umatilla Dist. Walla Walla

2. Corner Status

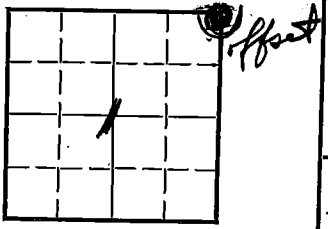

3. Original Description _____ Vol. _____ Page _____ Where Recorded _____

4. Description of Corners: ~~Set I.P. 3' long 3" dia 27" in ground, W/H mrk. brass cap. Dead spruce 8" dia. bears S 65°W 6 lks. dist. No trace of old B.T. 10" dia. fir bears S 5°E 45 lks. dist. 7" fir bears S 9°W 40 lks. dist.~~ T6N R38E S 36 S 1 S 6 R38E T5N R39E cc

5. Investigation Notes: ~~Cor. lay on gentle S.E. slope wooded. Found 3" I.P. W/Brass cap mrk. found 1 1/2" dia. fir bears S 10°E 30' dist. Place B.T. signs & mrk. w/paint. Found 8" dia. stump 2' high bears S 10°W place B.T. signs & mrk. w/paint.~~

J. Blom from W. says this descrip. incorrect. see 4-26-72

↓
Check out.

7. Photo Identification

Photo No. _____

Ident. By: _____

8. Plane Coordinate Position Data

State _____ Zone _____

X _____

Y _____

Estab. By _____

Field Book No. _____

Where Filed _____

9. Evaluation

Authentic _____ X _____

Needs Verif. _____ Monument Yes _____

Re-estab. _____ Survey _____

Land Status _____

6. Signed D.B. Baker Title Eng. Tech. Date 9-5-63

PERPETUATION RECORD

10. Monument:

11. Accessories

Field Book _____ Page _____

12. Set By _____ Title _____
License _____ Agency _____ Date _____

13. Recorded By _____ Volume _____ Page _____
(Agency) _____
(Date) (City) (County) (State)

14. Remarks:

A-25