

CERTIFIED RECORD OF LAND CORNER MONUMENTATION

HISTORY OF ORIGINAL CORNER ESTABLISHED:

1879 G.L.O. SURVEY GEORGE PERSHIN
 "SET BASALT STONE 16X12X3 AND STAKE IN MOUNDS OF STONE ON STEEP NORTH POINT OF SPUR AT POINT OF INTERSECTION WITH 4TH STANDARD PARALLEL NORTH 16.1 CHS WEST FROM THE STANDARD COR TO SEC 31 AND 32."

DESCRIPTION OF CORNER EVIDENCE FOUND:

FOUND 18X11X4" BROWN BASALT STONE ON STEEP NORTH SLOPE RINGED WITH ROCKS COVERED IN DRIED MOSS. VERTICAL BUTTE LIES SOUTH 10.3 FEET. NO MARKINGS ON STONE.

DESCRIPTION OF SET MONUMENT AND ACCESSORIES:

SET A 3-1/4" ALUMINUM CAP ON 3/4" x 30" REBAR STAMPED "T5N R37E SC 1/4 S32 OR70938LS 2021 LUEBKE 13237 LS - DJ&A, P.C." IN PLACE OF STONE, STONE SET UPSIDE DOWN ALONGSIDE.

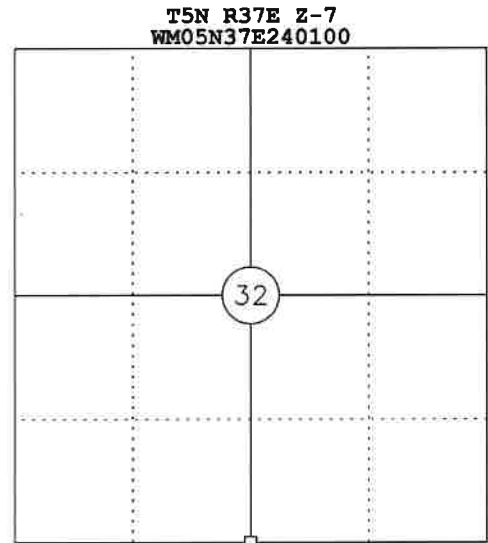

NEW BEARING OBJECTS:

SET 1" RED PLASTIC CAPS ON 1/2" X 30" REBAR MARKED "DJA CP" IN EACH QUADRANT:
 -N32°31'26"E, 23.85'
 -N23°09'05"W, 17.59'
 -S26°42'47"E, 15.95'
 -S36°39'32"W, 17.76'

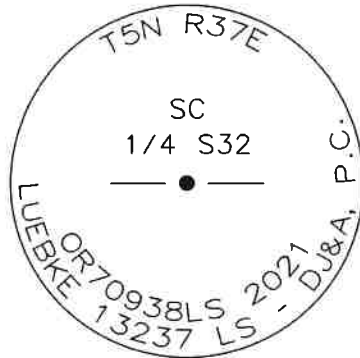

SURVEYOR'S CERTIFICATE:

I HEREBY CERTIFY THAT THIS CORNER WAS MONUMENTED ON MAY 19, 2021.

REGISTERED
 PROFESSIONAL
 LAND SURVEYOR

OREGON
 JULY 9, 2002
 KURT A. LUEBKE
 70938

MONUMENT AND NEW REFERENCES WERE SET USING A TRIMBLE R10 GNSS SYSTEM.

NAD83 (2011) (EPOCH 2010.000)

LATITUDE: N45°51'38.71617"

LONGITUDE: W118°13'01.00304"

EXPIRES 12-31-2022