

OREGON CORNER RESTORATION FORM

Section 13 Township 5N Range 36E
 County Umatilla Date: December 14, 2011

Corner Designation: 5N36N21

Corner common to sections 13, 14, 23, and 24,
 T5N, R36E, W.M., Umatilla County, Oregon.

Condition Report Only
 Not found
 Remonumented
 Unrecorded
 Surveyed in
 Referenced out

Previous Renewals / Surveys, etc.

Corner was originally set by Odell and Lewis under contract No. 110, dated February 7, 1865. Their record reads: Set post cor. for secs. 13, 14, 23 and 24, drove charred stake, dug pits, and raised mound as per instructions; John Kimbrell in the Record of Private surveys Book 1, Page 174 states: Set stone and old original post with mound, pits &c.; Willard Bradley in his 1911 survey for Obert states: Stone "+", old stake and mound.; Dave Krumbein in survey 85-144-B states: Found rock jack twice the size of others nearby in a north - south fence.

Monument and Accessories found: (condition and source)

A north - south fence. The corner point falls in an area of small land slides on a steep west facing slope.

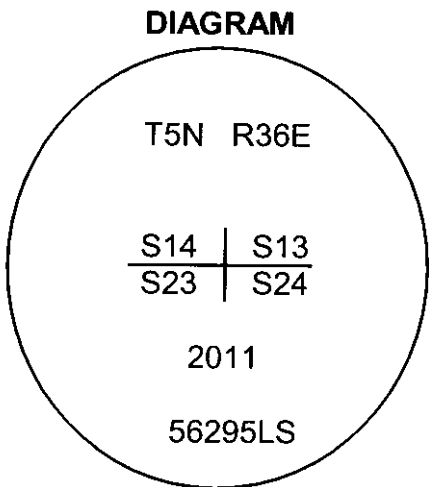

⊗ = Brass cap.
 ● = Rebar reference.

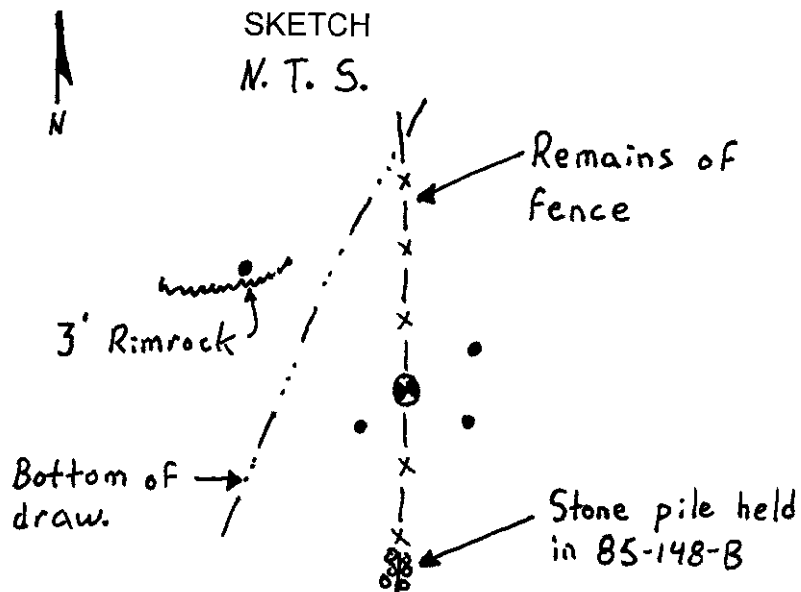

MONUMENT (S) AND ACCESSORIES SET (Procedures and Description)

At a corner point determined from the north - south fence and ties to fences in the Obert survey, I set a 2 1/4" brass cap on a 1 1/2" x 30" galvanized iron pipe flush with the surface of the ground.

For references, I set four, 5/8" by 24" iron rebars with 1 1/4" orange plastic caps stamped WTS and 56295LS as described below:

- an iron rebar bears N76°00'42"W, 122.43 feet, in a crack in a small broken rimrock;
- an iron rebar bears N34°32'46"E, 24.20 feet;
- an iron rebar bears S51°01'24"E, 25.32 feet;
- an iron rebar bears S34°58'03"W, 39.69 feet;
- The rock jack held in survey 85-148-B bears S1°5'W, 163.5 feet;

The monument and references were tied using a Trimble R7/R8 RTK GPS system.

Location and comments
 NAD 83/1991 State Plane Coordinate
 Oregon North Zone
 N = 823788.69 ift
 E = 8770100.42 ift

Compass Declination
 Firm / Agency
 Witness Tree Surveying
 Address
 P.O. Box G
 Pilot Rock, Or. 97868
 Party Chief
 Stephen K, Haddock

Surveyors Seal

REGISTERED
 PROFESSIONAL
 LAND SURVEYOR

Stephen K. Haddock

OREGON
 JULY 9, 2001
 STEPHEN K. HADDOCK
 56295LS

RENEWAL DATE 6-30-13

RECEIVED BY:
 Umatilla County Surveyor
 Date: 6/5/2012
 Rec'd By: A. Pres
 No. 12-088-C