

**OREGON CORNER RESTORATION FORM**

Section 17 Township 5N Range 36E  
 County Umatilla Date: September 17, 2012

Corner Designation: 5N36L5

Condition Report Only  
 Not found  
 Remonumented  
 Unrecorded  
 Surveyed in  
 Referenced out

Quarter corner common to sections 17 and 18, T5N, R36E,  
 W.M., Umatilla County, Oregon.

Previous Renewals / Surveys, etc.

Corner was originally set by Odell and Lewis under contract No. 110 dated February 7, 1865.  
 Their record reads: Set 1/4 Sec. post. Drove charred stake, dug pits and raised mound as  
 per instructions. In survey Q-1337-C, F.B. Hayes states: "rock found".

Monument and Accessories found: ( condition and source )

A basalt stone, 16x12x12 ins. set over the top of a decayed wood post at the corner of fences  
 running south and west.

**DIAGRAM**

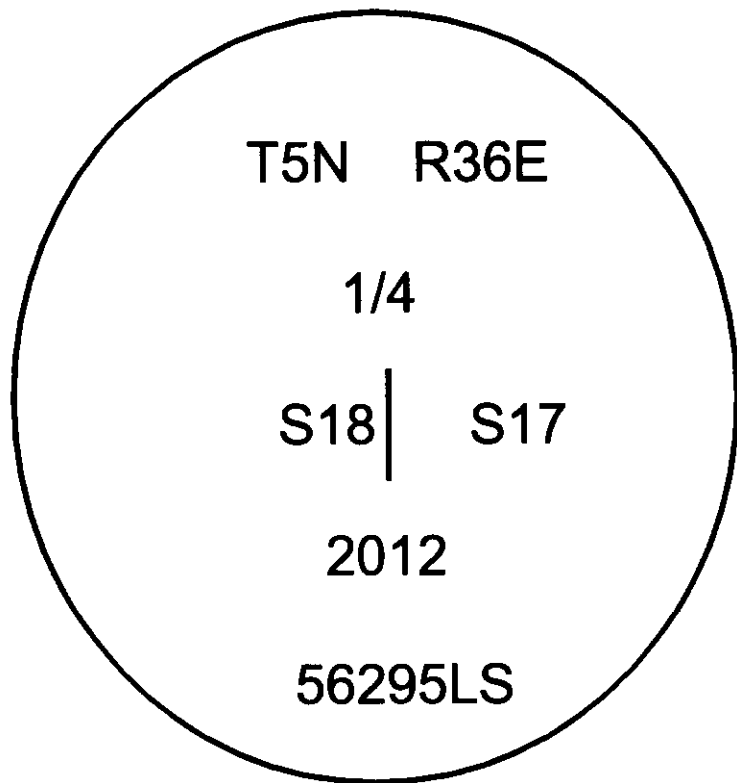

- = Railroad Tie Post
- = Brass Cap
- = Rebar Reference

**SKETCH**

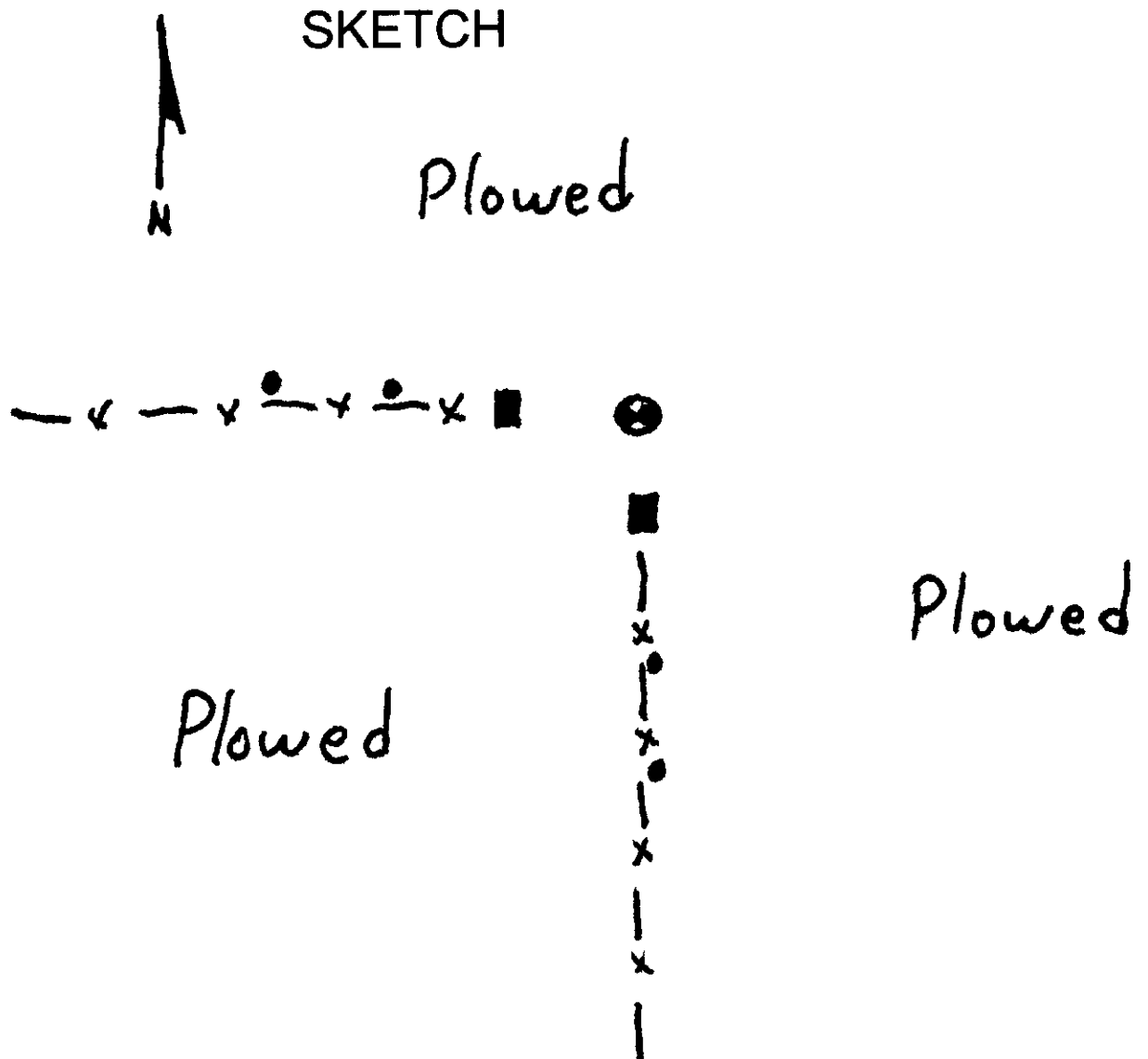

**MONUMENT (S) AND ACCESSORIES SET (Procedures and Description)**

Set a 1 1/2" x 30" galvanized iron pipe with a 2 3/8" brass cap stamped as shown in the diagram  
 above at the position of the found stone.

For references, I set four 5/8" by 24" iron rebars with 1 1/8" orange plastic caps stamped WTS  
 and 56295LS as described below under the existing fence:

- an iron rebar bears N88°02'37"W, 44.31 feet;
- an iron rebar bears N87°30'09"W, 23.40 feet;
- an iron rebar bears S1°10'19"E, 25.68 feet;
- an iron rebar bears S0°36'56"E, 50.71 feet;

The monument and references were tied using Trimble R7/R8 RTK GPS.

Location and comments  
 NAD 83/1991 State Plane Coordinate  
 Oregon North Zone  
 N = 825268.11 ift  
 E = 8748938.19 ift

Compass Declination

Firm / Agency  
 Witness Tree Surveying  
 Address  
 P.O. Box G  
 Pilot Rock, Or. 97868  
 Party Chief  
 Stephen K, Haddock

Surveyors Seal

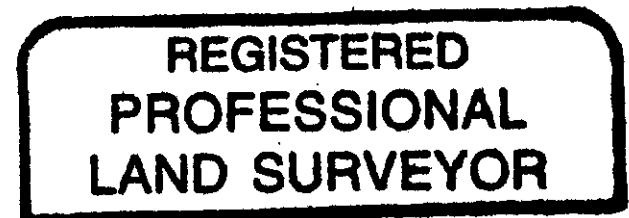

*Stephen K. Haddock*

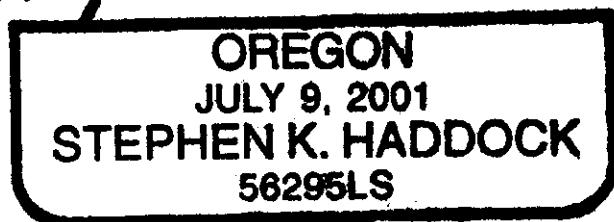

RENEWAL DATE 6-30-13

**RECEIVED BY:**

Umatilla County Surveyor  
 Date: 12/6/2012  
 Rec'd By: S. Pres  
 No. 12-155-18