

**OREGON CORNER RESTORATION FORM**

Section 15 Township 5N Range 36E  
 County Umatilla Date: February 18, 2012

Corner Designation: 5N36L17

Condition Report Only  
 Not found

Quarter corner common to sections 14 and 15, T5N, R36E,  
 W.M., Umatilla County, Oregon.

Remonumented  
 Unrecorded  
 Surveyed in  
 Referenced out

Previous Renewals / Surveys, etc.

Corner was originally set by Odell and Lewis under contract No. 110 dated February 7, 1865.  
 Their record reads: Set 1/4 Sec. post on steep hillside.

Monument and Accessories found: ( condition and source )

I projected the line between the C1/4 and CW1/16 of section 14 that same direction and distance to the west.

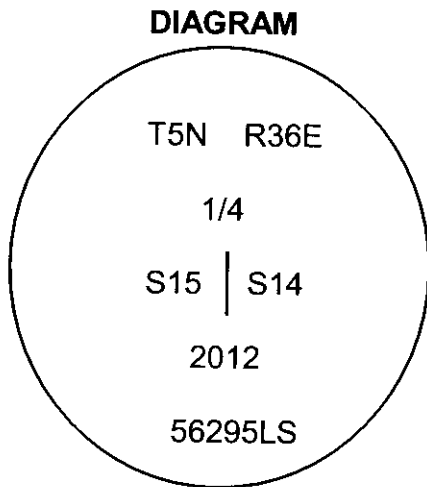

⊗ = Brass cap.  
 ● = Rebar reference.

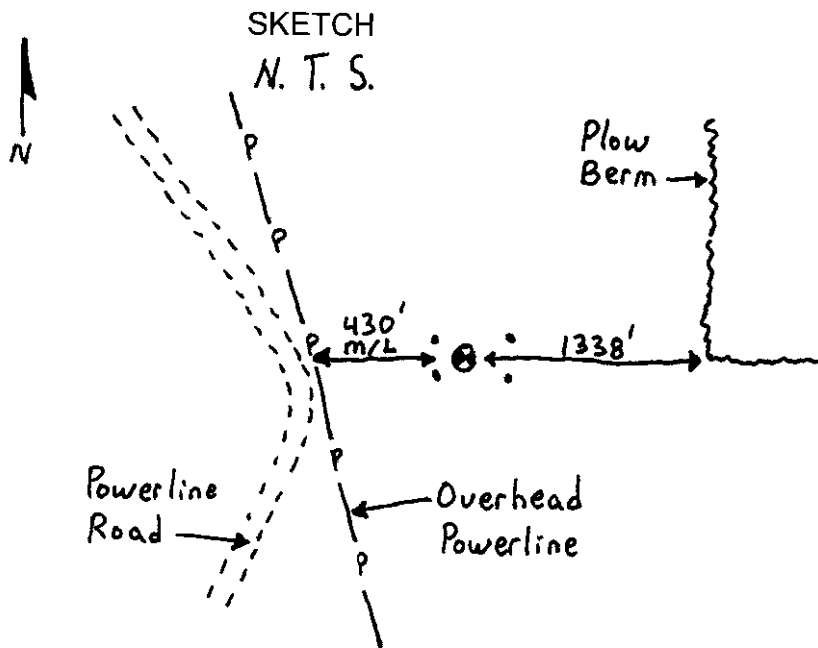

**MONUMENT (S) AND ACCESSORIES SET (Procedures and Description)**

Set a 1 1/2" x 30" galvanized iron pipe with a 2 3/8" brass cap stamped as shown in the diagram above 2 feet below the surface of a plowed field.

For references, I set four 5/8" by 24" iron rebars with 1 1/8" orange plastic caps stamped WTS and 56295LS as described below 2 feet below the surface of the plowed field:

- an iron rebar bears N44°09'00"W, 23.84 feet;
- an iron rebar bears S58°48'59"W, 24.95 feet;
- an iron rebar bears N53°41'48"E, 62.23 feet;
- an iron rebar bears S61°10'26"E, 62.34 feet;

The monument was set and references were tied using Trimble R7/R8 RTK GPS.

Location and comments  
 NAD 83/1991 State Plane Coordinate  
 Oregon North Zone  
 N = 826131.87 ift  
 E = 8764681.38 ift

Compass Declination

Surveyors Seal

RECEIVED BY:  
 Umatilla County Surveyor  
 Date: 6/5/2012  
 Rec'd By: A. Res  
 No. 12-088-c

Firm / Agency  
 Witness Tree Surveying  
 Address  
 P.O. Box G  
 Pilot Rock, Or. 97868  
 Party Chief  
 Stephen K, Haddock

REGISTERED  
 PROFESSIONAL  
 LAND SURVEYOR

*Stephen K. Haddock*

OREGON  
 JULY 9, 2001  
 STEPHEN K. HADDOCK  
 56295LS

RENEWAL DATE 6-30-13