

OREGON CORNER RESTORATION FORM

COUNTY: Umatilla. DATE: 04/17/8

CORNER DESIGNATION: Z-7, The South Quarter Corner of Section 32, Township 6 North, Range 36 East, W.M..

PREVIOUS RENEWALS/SURVEYS ETC.: Corner originally established by Odell & Lewis under GLO Contract No. 110, dated February 7, 1865. Notes state: Set 1/4 Sec. post on level. Drove charred stake; dug pits & raised mound, as per instructions.

MONUMENT AND ACCESSORIES FOUND: None. Falls in farmed area with no features.

MONUMENT MARKING DETAIL:

T6N R36E
1 S32
4 S5
T5N
2008
PLS 1106

MONUMENT SET: Corner position was reestablished on the parallel of latitude between the reestablished Southwest and recovered Southeast Corners of Section 32. At the reestablished corner point, set a 2 3/8" brass cap on a 1 1/4" x 30" galvanized iron pipe, with cap buried 19" below ground level, marked as shown in "Monument Marking Detail".

New accessories:

The Northwest corner of a metal pump building bears North 67 1/2° East, 115.2 feet. No bearing object sign attached.

A 5/8" x 24" iron rebar with a red plastic cap stamped "OR PLS 1106, WA PLS 17372" bears South 82 1/2° East, 95.0 feet. This rebar is near the Southwest corner of concrete pad, attached bearing object sign to rebar.

An irrigation riser 6" above ground level bears South 09 1/2° East, 51.3 feet, (no bearing object sign attached).

An orange deep-1 magnet bears North 47 1/2° West, 24.7 feet, buried 20" below ground level with a bearing object sign.

LOCATION AND COMMENTS: Corner located 40 feet North of East-West field road, 300 feet +/- West of Dennis Rea's machinery yard.

OREGON STATE PLANE COORDINATE, North Zone, NAD 83(91), International Feet:

N = 838884.94
E = 8751441.50

FIRM: Wells Surveying
P.O. Box 1696
Pendleton, OR 97801

COMPASS DECLINATION: 18° East

Surveyor's Seal

Witnesses: Jason Wells, LSIT

\6N36Z7

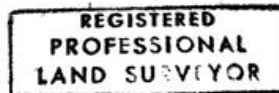

William R. Wells

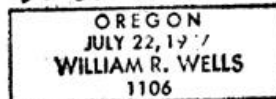

Renews 6-30-10

09-10-C