

OREGON CORNER RESTORATION FORM

COUNTY: Umatilla DATE: 03/24/05

CORNER DESIGNATION: 5N35, N-09, The Southeast Corner of Section 17.

PREVIOUS RENEWALS/SURVEYS ETC.:

Corner originally established by Odell & Lewis, under GLO Contract No. 110, dated February 7, 1865. Notes state: Set post Cor. for Secs. 16, 17, 20 & 21. Drove charred stake; dug pits & raised mound, as per instructions.

The original corner was recovered by J.C. Arnold, in 1887, under Record of Private Surveys, Survey No. 27. Arnold's record states: "I find original cor. to secs. 16-17-20-21, verified by A.M. Isaac, and which is decayed bits of old post in ground on gentle N.E. slope; old lines of ditch fence run E & N from this cor. point, at which I set a basalt stone 15 x 11 x 7 ins mkd. 4 notches on E and 3 notches on S".

MONUMENT AND ACCESSORIES FOUND: None.

MONUMENT MARKING DETAIL:

T5N R35E
S17 | S16
S20 | S21
2005
PLS 1106

MONUMENT SET:

I held a fence corner with fences North, West, and East as best remaining evidence of the original corner location. Set a 2 1/2" brass cap on a 2 1/2" x 30" galvanized iron pipe, 28" below ground level. Monument marked as shown in Monument Marking Detail. I dug and probed at the fence corner, but did not find the stone reported as set by J.C. Arnold. There is a pile of rocks Northwest of the fence corner, which have been gathered from neighboring fields and piled in this area.

New accessories:

A 5/8" x 24" rebar with a yellow plastic cap stamped "OR PLS 1106, WA PLS 17372", bears North, 28.2 feet, (in North-South fence line).

A 5/8" x 24" rebar with a yellow plastic cap stamped "OR PLS 1106, WA PLS 17372", bears South 89° East, 26.3 feet, (in East-West fence line).

A 5/8" x 24" rebar with a yellow plastic cap stamped "OR PLS 1106, WA PLS 17372", bears South 89° East, 51.0 feet, (in East-West fence line).

A 5/8" x 24" rebar with a yellow plastic cap stamped "OR PLS 1106, WA PLS 17372", bears North 89° West, 28.1 feet, (in East-West fence line).

Attached bearing object signs to rebar accessories. Nailed "witness" sign to wood fence corner post North of monument.

LOCATION AND COMMENTS: Corner located at fence corner with fences North, West, and East. Monument is 4 inches South of old fence corner post.

OREGON STATE PLANE COORDINATE, North Zone, NAD 83(91), International Feet:

N = 822232.61
E = 8722812.46

FIRM: William R. Wells, PLS
P.O. Box 1696
Pendleton, OR 97801

COMPASS DECLINATION: 18° East

Witnesses: Jason Wells, LSIT
5N35N09

Surveyor's Seal

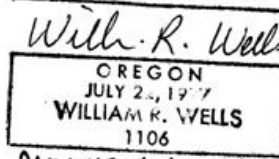
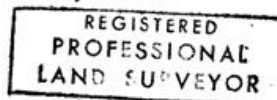

RENEWS 6/30/06

05-112-C