

OREGON CORNER RESTORATION FORM

COUNTY: Umatilla DATE: 02/22/05

CORNER DESIGNATION: 5N35, J-15, The South Quarter Corner of Section 10.

PREVIOUS RENEWALS/SURVEYS ETC.:

Corner originally established by Odell & Lewis, under GLO Contract No. 110, dated February 7, 1865. Notes state: Set 1/4 Sec. post; drove charred stake; dug pits & raised mound, as per instructions.

Survey No. Q-805-A, by Ofner, indicates the corner is mid-way between "rocks" found at the Southwest and Southeast corner of Section 10, but does not indicate a monument set.

MONUMENT AND ACCESSORIES FOUND: None.

MONUMENT MARKING DETAIL:

T5N R35E
1 S10
4 S15
2005
PLS 1106

MONUMENT SET:

The corner area falls in a farmed field with no nearby features. The Ofner Survey Map No. Q-805-A, indicates 2- 1/2" steel pins were set on the South Line of Section 10, one at the W1/16th corner and one further East. Ofner's map shows no bearings or distances, other than distances at record deed corners he established in this 1950 survey. I made an extensive search for the 1/2" steel pins he shows in the Southwest Quarter of Section 10 and find many are farmed out. I have some doubt that the monuments were even set, because at the West 1 1/6th corner on the South line of Section 10, I found Ofner's wood stake lying on the ground and even found his wood hub and tack, pushed over, but no 1/2" steel pin. I re-established this one-quarter corner by single proportionate measure between the Southwest and Southeast corners of Section 10, using the Odell and Lewis record. At the re-established corner point, a 2 1/2" brass cap on a 1 1/4" x 30" iron pipe with cap buried 20" below ground level. Monument is marked as shown on Monument Marking Detail.

New accessories:

A silver deep-1 magnet buried 20" below ground level, bears North 11° East, 56.2 feet.
A purple deep-1 magnet buried 20" below ground level, bears South 83° East, 44.7 feet.
A blue deep-1 magnet buried 20" below ground level, bears South 06 1/2° West, 30.9 feet.
An orange deep-1 magnet buried 20" below ground level, bears North 64 1/2° West, 46.6 feet.
Buried bearing object signs with deep-1 magnets.

LOCATION AND COMMENTS: Corner is located in a farmed field. No nearby features.

OREGON STATE PLANE COORDINATE, North Zone, NAD 83(91), International Feet:

N = 827733.57

E = 8731196.77

FIRM: William R. Wells, PLS
P.O. Box 1696
Pendleton, OR 97801

COMPASS DECLINATION: 18° East

Surveyor's Seal

Witnesses: Jason Wells, LSIT
Brian Cole

/5N35J15

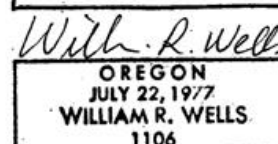
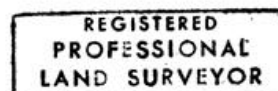

Renews 6/30/06

05-112-C