

OREGON CORNER RESTORATION FORM

COUNTY: Umatilla DATE: 01/11/05

CORNER DESIGNATION: 5N35, J-13, Northeast Corner of Section 16.

PREVIOUS RENEWALS/SURVEYS ETC.: Originally established by Odell & Lewis, under GLO Contract No. 110, dated February 7, 1865. Notes state: Set post Cor. for Secs. 9, 10, 15 & 16. Drove charred stake; dug pits & raised mound, as per instructions.

Survey No. Q-805-A, by Frank Ofner, calls for a "rock". In Umatilla County monumentation record 88-23-M, Dennis Gaylord found a unmarked 10 x 15 x 24" stone in small mound of stones and set a 2 1/2" brass cap monument.

MONUMENT AND ACCESSORIES FOUND: Found a 2 1/2" brass cap on 1 1/4" galvanized iron pipe, flush with the ground in a small mound of stones and in a board fence, line running north-south. Cap marked as shown in Monument Marking Detail.

MONUMENT MARKING DETAIL:

T5N R35E
S9 | S10
S16 | S15
LS 1636
1988

MONUMENT SET:

Maintained corner monument by adding new accessories, measured from the existing brass cap monument:

A 5/8" x 30" iron rebar with a yellow plastic cap marked "OR PLS 1106, WA PLS 17372", set flush with the ground, bears North 58° East a distance of 19.6 feet.

A 5/8" x 30" iron rod with a yellow plastic cap marked "OR PLS 1106, WA PLS 17372", set flush with the ground, bears South, a distance of 37.0 feet.

A 1" diameter water standpipe with 2 valves bears South, a distance of 63.3 feet, (measured at ground level).

A 5/8" x 30" iron rod with a yellow plastic cap marked "OR PLS 1106, WA PLS 17372", set flush with the ground, bears North 09° West, a distance of 44.4 feet, with "witness" sign attached.

Set a steel fence post 1.0 feet West of monument with a "witness" sign attached.

Corner falls in a fence between a pasture and a rural residential yard, I therefore did not put bearing object signs on rebar accessories in view of the house.

LOCATION AND COMMENTS:

Corner falls in a fence between a pasture and a rural residential yard. There is a railroad track 85 feet North of corner monument.

OREGON STATE PLANE COORDINATE, North Zone, NAD 83(91), International Feet:

N = 827670.08
E = 8728542.71

FIRM: William R. Wells, PLS
P.O. Box 1696
Pendleton, OR 97801

COMPASS DECLINATION: 18° East

Witnesses: Jason Wells, LSIT

\5N35J13

Surveyor's Seal

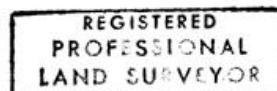

William R. Wells
OREGON
JULY 22, 1977
WILLIAM R. WELLS
1106

RENEWED 6/30/06

05-112-C