

OREGON CORNER RESTORATION FORM

Section 2 Township 5N Range 35E
 County Umatilla Date: June 29, 2013

Corner Designation: 5N35C17

Condition Report Only
 Not found
 x Remonumented
 Unrecorded
 x Surveyed in
 x Referenced out

Quarter corner common to sections 2 and 3, T5N, R35E, W.M., Umatilla County, Oregon.

Previous Renewals / Surveys, etc.

Corner was originally set by Odell and Lewis under contract No. 110 dated February 7, 1865. Their record reads: Set 1/4 Sec. post. Drove charred stake, dug pits and raised mound as per instructions. The point for this corner was established in survey I-198-A which was later monumented with an aluminum cap under survey S-157-C. Survey 93-14-B calculated a point 27.51 feet south of the point from Survey S-157-C but set no monument. Surveys 06-206-C, 06-501-B and 08-158-C held a point 9.27 feet north of the point from survey 93-14-B that was also not monumented.

Monument and Accessories found: (condition and source)

None. This point lies where a N-S field berm was leveled for access between two orchards.

DIAGRAM

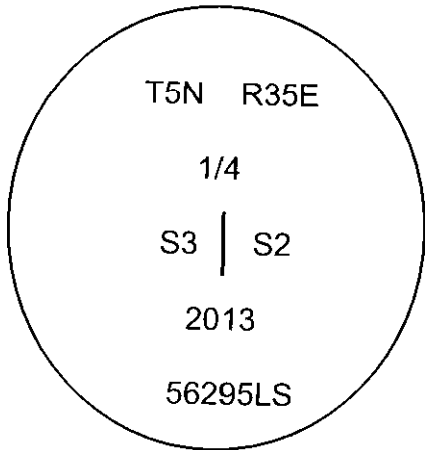

SKETCH

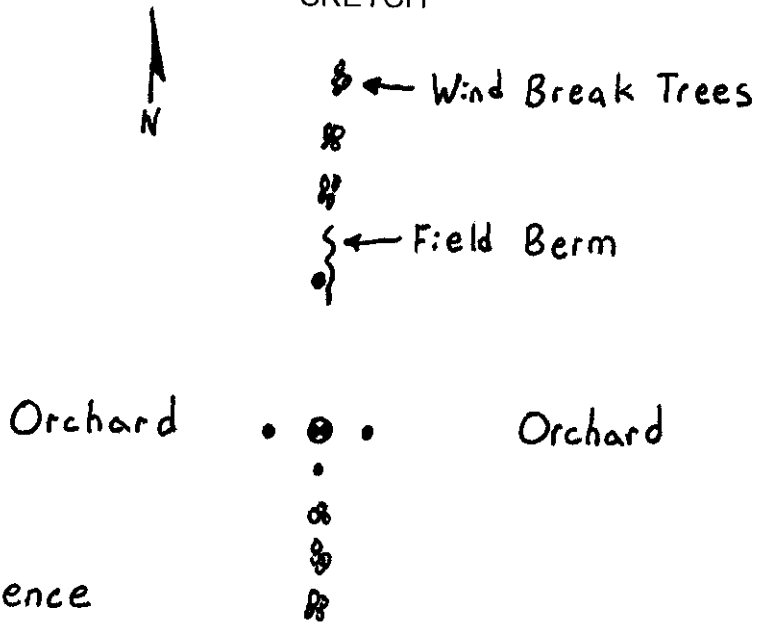

- = Set Brass Cap
- = Set Rebar Reference

MONUMENT (S) AND ACCESSORIES SET (Procedures and Description)

At the position calculated using the record data from survey I-198-A, I set a 2 3/8" brass cap on a 1 1/2" x 30" galvanized iron pipe with the cap stamped as shown in the diagram above. The top of the monument is 22" below the surface of the ground.

For references, I set four 5/8" by 24" iron rebars with 1 1/8" orange plastic caps stamped WTS and 56295LS as described below 2 feet below the surface of the ground:

- an iron rebar bears N3°17'19"E, 67.62 feet;
- an iron rebar bears N86°47'02"W, 23.25 feet;
- an iron rebar bears S86°45'57"E, 13.47 feet;
- an iron rebar bears S01°29'31"E, 20.12 feet;

The monument was set and references were tied using Trimble R7/R8 RTK GPS.

Location and comments

Compass Declination

Surveyors Seal

RECEIVED BY:

Umatilla County Surveyor
 Date: 6/27/2013
 Rec'd By: S. Ples
 No. 13-199-C

Firm / Agency
 Witness Tree Surveying
 Address
 P.O. Box G
 Pilot Rock, Or. 97868
 Party Chief
 Stephen K, Haddock

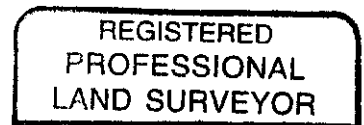

Stephen K. Haddock

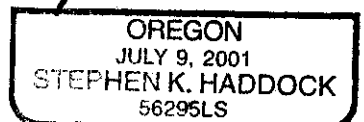

RENEWAL DATE 6-30-15