

OREGON CORNER RESTORATION FORM

Section 3 Township 5N Range 35E
 County Umatilla Date: June 27, 2013

Corner Designation: 5N35A13

Corner common to sections 33 and 34, T6N, R35E, and sections 3 and 4, T5N, R35E, W.M., Umatilla County, Oregon.

Condition Report Only
 Not found
 x Remonumented
 Unrecorded
 x Surveyed in
 x Referenced out

Previous Renewals / Surveys, etc.

Corner was originally set by Odell and Lewis under contract No. 110 dated February 7, 1865. Their record reads: Set post Cor. for Secs. 3, 4, 33 & 34. Drove charred stake, dug pits and raised mound as per instructions. The plat of Apple Dale (Plat Book 2, Page 78) by L.A. Wilson calls for a stone at this corner. Surveys 86-27-A, 91-81-B, 98-156-B, 98-238-A, 03-137-C, and 04-146-C, all report different proportionate positions which none of them monumented.

Monument and Accessories found: (condition and source)

None. The point falls just south of the pavement on a raised fill in the road.

DIAGRAM

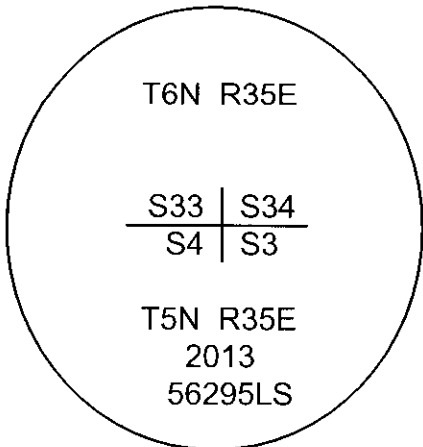

SKETCH

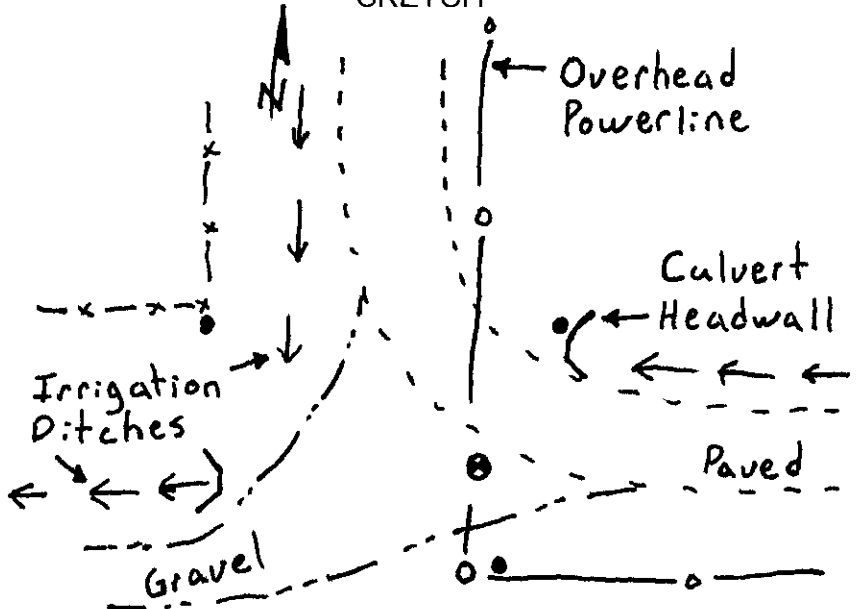

Monument and Accessories set:

At a position determined by ties to the Railroad, found monuments in the Apple Dale plat and the physical location of the road structure of Prunedale Road as determined by Mr. Gary Roberts for the Umatilla County Road Department, I set a 1 1/2" x 30" galvanized iron pipe with a 2 3/8" brass cap stamped as shown in the diagram above with the cap 6 inches below the surface of the gravel road bed.

For references I set three 5/8" x 24" iron rebars with 1 1/8" orange plastic caps attached stamped WTS and 59295LS as described below:

- an iron rebar bears N46°51'18"W, 69.56 feet, one foot south of an existing fence corner;
- an iron rebar bears N16°48'41"E, 40.73 feet, at the north end of a concrete headwall in the ditch;
- an iron rebar bears S00°58'55"W, 11.38 feet, 2 feet east of a power pole;

The monument was tied using a Trimble R7/R8 RTK GPS System.

Location and comments

Compass Declination

Surveyors Seal

RECEIVED BY:

Umatilla County Surveyor
 Date: 6/7/2013
 Rec'd By: S. Orr
 No. 13-199-C

Firm / Agency
 Witness Tree Surveying
 Address
 P.O. Box G
 Pilot Rock, Or. 97868
 Party Chief
 Stephen K, Haddock

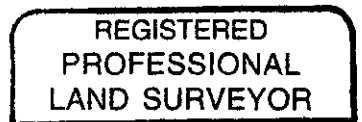

Stephen K. Haddock

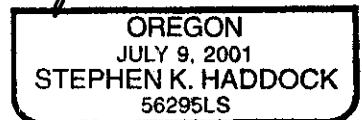

RENEWAL DATE 6-30-15