

OREGON CORNER RESTORATION FORM

Section 11 Township 5N Range 34E
 County Umatilla Date: April 16, 2003

Corner Designation: 5N34G21

Common quarter corner to sections 11 and 12, T5N, R34E,
 W.M., Umatilla County, Oregon.

Condition Report Only
 Not found
 Remonumented
 Unrecorded
 Surveyed in
 Referenced out

Previous Renewals / Surveys, etc.

Corner originally set by Wm. H. Odell and Wm. S. Lewis. under contract No. 110 dated February 7th, 1865. Their record reads: Set 1/4 sec. post Cor. Hill slopes to W. Drove charred stake; dug pits and raised mound as per instructions.

Monument and Accessories found: (condition and source)

A fence corner with fences running North, South, and East. The corners in this fence along the east side of Sections 2 and 11 are remarkably uniform at nearly half mile intervals and I believe they were established by survey.

DIAGRAM

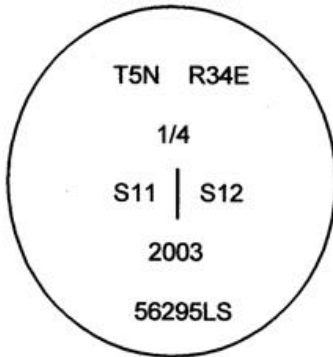

SKETCH

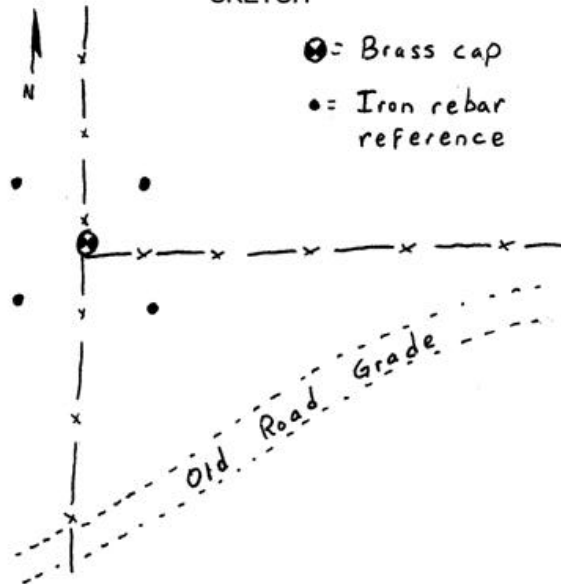

MONUMENT (S) AND ACCESSORIES SET (Procedures and Description)

I set a 1 1/2" x 30" galvanized iron pipe with a 2 1/4" brass cap stamped as shown in the diagram above at the fence corner.

For references, I set four 5/8" by 24" green coated iron rebars with 1 1/8" orange plastic caps stamped WTS and 56295LS as described below:

- a rebar bears N23°35'35"E, 89.34' feet;
- a rebar bears N50°06'14"W, 37.29 feet;
- a rebar bears S36°12'15"W, 38.23 feet;
- a rebar bears S41°48'08"E, 32.83 feet;

The monument and references were tied using a LIECA system 300 RTK GPS.

Location and comments
 NAD 83-91 coordinates from a single
 GPS tie to tri station GEER.

N 829798.21
 E 8706757.58
RECEIVED BY:
Umatilla County Surveyor
 Date: 10-03
 Rec'd By: KR
 No. 03-314-C

Compass Declination
 Firm / Agency
 Witness Tree Surveying
 Address
 P.O. Box G
 Pilot Rock, Or. 97868
 Party Chief
 Stephen K, Haddock

Surveyors Seal

**REGISTERED
 PROFESSIONAL
 LAND SURVEYOR**

Stephen K. Haddock

**OREGON
 JULY 9, 2001
 STEPHEN K. HADDOCK
 56295LS**

RENEWAL DATE 6-30-05