

OREGON CORNER RESTORATION FORM

SECTION: 32 TOWNSHIP: 5N

RANGE: 29E

V-9

COUNTY: UMATILLA

DATE: 12/05

CORNER DESIGNATION

NE Section 32

- CONDITION REPORT ONLY
- NOT FOUND
- RENEWED
- UNRECORDED
- SURVEYED IN
- REFERENCED OUT

PREVIOUS RENEWALS/SURVEYS ETC.

Originally surveyed by Davenport under Contract # 101 in 1861. He set post and made mound.

In 1977 Edwards found a bolt.

In 1979 Edwards set a R/R spike in place of missing bolt.

MONUMENTS AND ACCESSORIES FOUND: CONDITION AND SOURCE

Found R/R spike 2" below the surface of a paved road.

Found 2 3/8" brass cap stamped as below bears N 31° 45' 58" W 24.42'(23.80'). It has been disturbed.

MONUMENT DETAIL

T5NR29E

W.C.

N 31 09 30 W

29 | 28

32 | 33

23.80

1990

L.S. 951

OREGON STATE PLANE COORDINATES, NORTH ZONE, NAD 83(91) INT. FEET:

809140.57

8532411.58

MONUMENT SET (PROCEDURES AND DESCRIPTION)

NEW ACCESSORIES FROM WHICH

A 5/8" x 30" Iron Rebar with plastic cap #951 bears S 77°42' 47" E 81.25'

A 5/8" x 30" Iron Rebar with plastic cap #951 bears N 23°02' 36" E 75.18'

A 1/2" Iron Rebar property corner bears S 6° 18' 39" W 299.54

LOCATION AND COMMENTS

At the intersection of hwy 207, Edwards road, and Walls road.

SURVEYOR'S SEAL

**FIRM: EDWARDS SURVEYING LLC
PO BOX 763 - HERMISTON OR 97838**

**PARTY CHIEF: R. SMITH
WITNESS: J. JOSEPH**

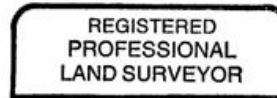

G. Dennis Edwards

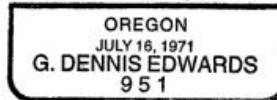

RENEWS 12/31/05