

OREGON CORNER RESTORATION FORM

Section 34 Township 5N Range 28E

County UMATILLA Date 11/95

X-13

CORNER DESIGNATION

W 1/4 COR

- Condition Report Only
- Not Found
- Renewed
- Unrecorded
- Surveyed In
- Referenced Out

Previous Renewals/Surveys, etc. ORIG SUR. BY DAVENPORT in 1861 Cont. # 101  
POSSIBLY KIMBRELL set 1 1/2" I. Pipe in 1910

Monument(s) & Accessories Found: (Condition and Source)

FND 5/8" Rebar Driven inside 1 1/2" I. Pipe which was 14" below surface.

a 1/2" Rebar set by me in 1979 sur. for Fox

Bears N 58°42'W 38.68 FT. from Cor.

Monument Detail

Sketch

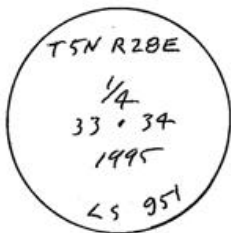

Monument Set (Procedures and Description)

I PLACED a 2" Alum Cap on the Fnd 5/8" rebar

New Accessories

An Alum Tag in P. Pole Bears N 54°19'20"E 35.22 FT.

A 1"x30" I. Pipe with 2 3/8" B.C. Bears S 54°36'W 44.37 FT.

An Alum Tag in P. Pole Bears S 55°09'50"E 33.64 FT.

Location & Comments

At the intersection of Sunshine Lane & Joy Lane.

Compass Declination \_\_\_\_\_

Firm/Agency Edwards

surveying

Address P.O. Box 763

Hermiston, OR 97838

Party Chief D. Edwards

Notes \_\_\_\_\_

Witness J. Coppock

Surveyor's Seal

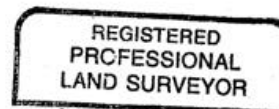

G. Dennis Edwards

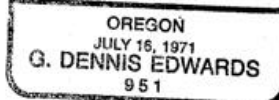

RENEWS 12/31/95

09-40-A