

OREGON CORNER RESTORATION FORM

COUNTY: Umatilla DATE: May 1998

CORNER DESIGNATION: P-9, East Quarter Corner Section 20, Township 5 North, Range 28 East, W.M.

PREVIOUS RENEWALS/SURVEYS ETC.: Original GLO Survey by Timothy W. Davenport, under Contract No. 101, dated August 5, 1861. Notes state: Set 1/4 Sec. Cor. post; made mound and drove charred stake, as per instructions. Re-established by G. Dennis Edwards, Umatilla County Survey Record #91-01-B, dated January 1991. Record states: No evidence found. Set by single proportion set a 2 3/8" Brass Cap attached to the top of a 1"x30" Galv. pipe. Cap is 0.4 ft. above surface of ground and in a row of grapes, stamped as shown in "Monument Marking Detail". Accessories: Set 4 - 1/2" x 24" L Rebar with Alum. Caps stamped 951. Set a steel fence post behind each of these 1/2" rebars with Bearing Object signs attached. They bear N 30°36' W 757.36 feet, West 406.84 feet, South and East 230.37 ft. from corner.

MONUMENT AND ACCESSORIES FOUND:

Found a 2 3/8" brass cap on 1" iron pipe, 2" above ground in a grape row.

Monuments found:

A 1 1/2" aluminum cap bears S89°56'E, 230.5' stamped "WC 230.37' East, LS 951".

A 1 1/2" aluminum cap bears South, 10.00' stamped "WC 10.00' South, LS 951".

A 1 1/2" aluminum cap bears S89°57'W, 406.6' stamped "WC 757.36', N30°36'W, LS 951".

A 1 1/2" aluminum cap bears N30°36'W, 757.0' stamped "WC 406.84', LS 951".

Aluminum caps are on 1/2" iron pins.

MONUMENT MARKING DETAIL:

T5N R28E

1/4

20 | 21

1990

LS 951

MONUMENT SET:

New Accessories:

All accessories have steel fence posts with bearing object signs attached nearby.

Corner has steel fence post with witness post sign attached 1.5 feet East of corner.

LOCATION AND COMMENTS:

COMPASS DECLINATION: 18° East Surveyor's Seal

Witnesses: Jason Wells
Benjamin Weinke

Oregon State Plane Coordinates, North Zone, Nad 83(91), Int. Feet:

North: 816728.28

East: 8500409.80

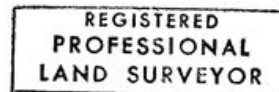

William R. Wells

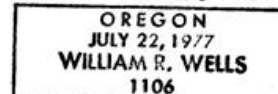

Renews 6-30-98

98-101-C