

OREGON CORNER RESTORATION FORM

COUNTY: Umatilla DATE: February 1998

CORNER DESIGNATION: N-15, North Quarter Corner Section 22, Township 5 North, Range 28 East, W.M.

PREVIOUS RENEWALS/SURVEYS ETC.: Original GLO Survey by Timothy W. Davenport, under Contract No. 101, dated August 5, 1861. Notes state: Set 1/4 Sec. Cor. post; made mound; drove charred stake, as per instructions. Survey by G. Dennis Edwards, Umatilla County Survey Records #87-16-A, dated 1987 states: Found a 2" O.D. Iron Pipe. I believe Fraley set in a no Date Survey. Copy of Fraley sur. could not be secured on trips to Umatilla Co. Sur. Office on 12/26/86 or 12/29/86. Corner re-established by G. Dennis Edwards, Umatilla County Survey Records #88-45-C. Record states: Set 1" x 30" I Pipe with B.C. at fence corner, 12 ft. due west of single proportion location.

MONUMENT AND ACCESSORIES FOUND: Found 2 3/8" brass cap on 1" iron pipe, 4" above ground, marked as shown in "Monument Marking Detail".

Existing Accessories:

An aluminum tag stamped #951 in face of 6" round gate post bears N 90° E, 14.80 feet.

MONUMENT MARKING DETAIL:

T5N R28E

1 S15

4 S22

1988

LS 951

MONUMENT SET:

New Accessories:

A brass washer stamped "PLS 1106" in North face of corner post 10" above ground bears S 06° E, 1.0 feet.

A brass washer stamped "PLS 1106" 1.0 feet above ground in a 4" square treated fence post bears S 12° W, 330.40 feet.

A brass washer stamped "PLS 1106" in South face of a 6" Russian Olive tree, 3.0 feet above ground, bears N 12° W, 40.36 feet.

All accessories have bearing object tags attached.

Witness post sign on fence corner S 06° E, 1.0 foot from corner monument.

LOCATION AND COMMENTS: Past surveys have used 2" O.D. Fraley pipe bearing N48°01'W, 12.8 feet from Edwards monument.

COMPASS DECLINATION: 18° East Surveyor's Seal

Witnesses: Jason Wells
Benjamin Weinke

Oregon State Plane Coordinates, North Zone, NAD 83(91), Int. Feet:

North: 819485.47

East: 8508323.94

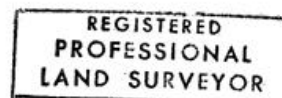

William R. Wells

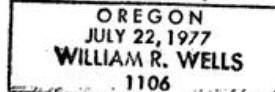

Renews 6-30-98

78-101-C