

**OREGON CORNER RESTORATION FORM**

COUNTY: Umatilla DATE: February 1998

CORNER DESIGNATION: J-17, Northeast Corner Section 15, T5N, R23E, W.M.

PREVIOUS RENEWALS/SURVEYS ETC.: Original GLO Survey by Timothy W. Davenport, under Contract No. 101, dated August 5, 1861. Notes state: Set post Cor. to Secs. 14, 15, 10 & 11; made mound and drove charred stake, as per instructions. U.S. Engineers Cadastral Retracement Record dated September 1947 states: No evidence found of original survey. Found 1" axle or driveshaft extending 4" above ground line and set in a pile of buried stones. The shaft had been struck and bent at a point one foot below the ground line where it entered the buried stone mound. Re-established by David H. Krumbein, Umatilla County Survey Record #H-210-A, dated 10-30-72. Brass Cap monument set "Reset from notes". Maintained by G. Dennis Edwards, Umatilla County Survey #88-45-C, dated August 8, 1988. Found a brass cap in conc., Umatilla County Surveyor, no date. Found a 5/8" rebar N 00°26'23" E, 304.76, set by himself in 1986 for PP&L. New accessory set: A nail and washer in 12" Locust N 00°26'23" E, 83.51 feet.

**MONUMENT AND ACCESSORIES FOUND:**

A 2 1/2" brass cap buried 2" below ground, stamped as shown in "Monument Marking Detail". A steel fence post bears North, 381.71 feet, near U.S. brass cap stamped "AA-A", buried in fence corner.

**MONUMENT MARKING DETAIL:**

UMATILLA COUNTY

+

SURVEYOR

**MONUMENT SET:**

**New Accessories:**

A brass washer stamped "PLS 1106", 1.7 feet above ground in a 26" Sycamore tree bears N 64° E, 118.45 feet.

A brass washer stamped "PLS 1106", 3.0 feet above ground in a 14" Pine tree bears S 30° E, 91.93 feet.

A brass washer stamped "PLS 1106", 1.8 feet above ground in a 22" Spruce tree bears S 30° W, 105.62 feet.

All accessories have bearing object signs attached.

**LOCATION AND COMMENTS:** Located in the third fairway of golf course.

**COMPASS DECLINATION:** 18° East      Surveyor's Seal

Witnesses: Jason Wells  
Benjamin Weinke

**Oregon State Plane Coordinates, North Zone, NAD 83(91), Int. Feet:**

North: 824885.28

East: 8510883.59

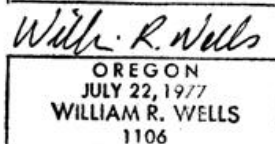
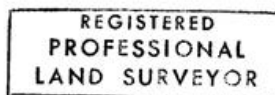

Renews 6-30-98

98-101-c